

Catalog Number • Numéro de Catalogue • Número de Catálogo: MB-2

Country of Origin: Made in China • Pays d'origine: Fabriqué en Chine • País de origen: Hecho en China

DESCRIPTION

The **MB-2 Reflector Bell Sensor Bracket** allows an occupancy sensor to be mounted to an HID fixture that has a **metal reflector bell** (without a lens cover).

The bracket has an adjustable mounting plate with wire holes and screw holes to allow use with many Wattstopper sensors. Mounting screws are provided for Wattstopper **CI Sensors**.

A 30 inch extension wire is provided to connect the **HB**, **CX**, or **CI** or sensors to a **DM-100 HID Bi-Level Control Module**. A bubble level on the mounting plate is used for initial leveling. Preset locking positions allow for precise angle adjustments, if any (horizontally, 33° from horizontal; vertically, 12° from vertical). Refer to the Installation Instructions for the sensor used.

Three clamping screws secure the bracket to the reflector rim.

INSTALLATION

- For **CX** or **CI** sensors—attach the included extension wire:
 - On **CX** sensors, first remove the mounting post bracket by rotating clockwise, then disassemble the sensor housing to reach the existing wire-plug (see the sensor's installation instructions). Pull out the existing wire-plug and plug in the extension wire.
 - On **CI** sensors, pull out the existing wire-plug and plug in the included extension wire.

NOTE: If the DM-100 is mounted separately from the fixture, the sensor's wires may need to be spliced and extended as necessary.
- Attach sensor to the mounting plate:
 - Thread the wires from the sensor through the appropriate hole in the mounting plate so that the wires will not be crimped or pinched when the sensor is attached.
 - CX** sensors: Line up the screw holes on the mounting plate with the dimples on the back of the sensor and attach the sensor with the 1/4" self-tapping screws provided with the sensor (this avoids potential damage to internal components).
 - CI** and **HB** sensors: Line up the screw holes on the MB-2 with the screw holes on the outside rim of the sensor, and attach the sensor with the provided long-screws.
 - Sensors that use the 1/2" **threaded post** for mounting: Insert the mounting post through the large hole in the mounting plate, and secure it with the post's nut.
- Adjust the mounting plate to the **horizontal preset position (0°)**: Loosen the wingnut, adjust the plate, then re-tighten the wingnut.
- Secure the MB-2 bracket to the reflector bell with the three clamping screws (see Bell Rim Attachment, right).
- When the HID fixture is rehung, use the bubble level and adjust the three clamping screws as needed to **level the bracket**.
- If a different preset locking angle for the sensor is desired, (see the Installation Instructions for the sensor used), adjust the plate as in step 3, above.

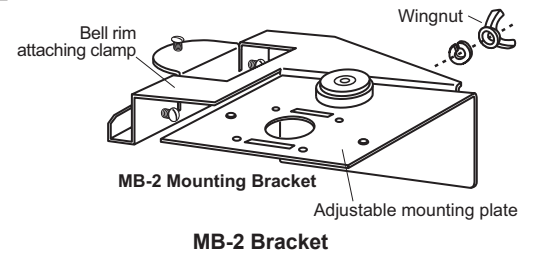

Mounting Location: HID Fixture

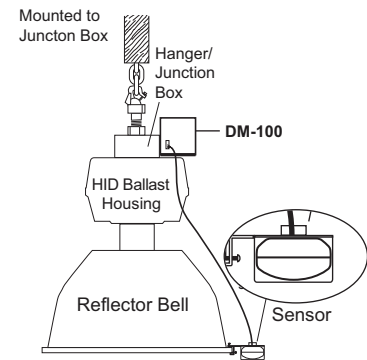

Bell Rim Attachment

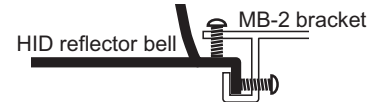

Sensor Attachment Examples

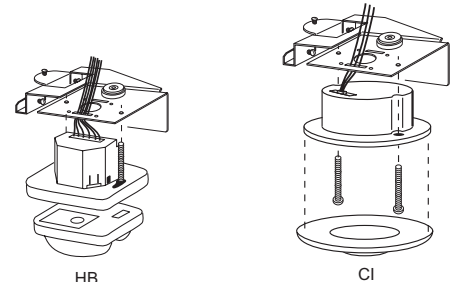
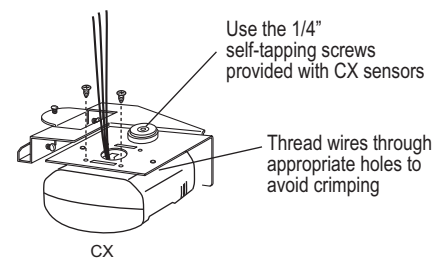

Mounting Plate Preset Locking Positions

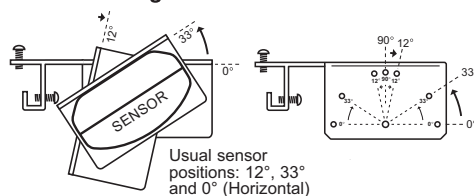

WARRANTY INFORMATION

Wattstopper warrants its products to be free of defects in materials and workmanship for a period of five (5) years. There are no obligations or liabilities on the part of Wattstopper for consequential damages arising out of, or in connection with, the use or performance of this product or other indirect damages with respect to loss of property, revenue or profit, or cost of removal, installation or reinstallation.

INFORMATIONS RELATIVES À LA GARANTIE

Wattstopper garantit que ses produits sont exempts de défauts de matériaux et de fabrication pour une période de cinq (5) ans. Wattstopper ne peut être tenu responsable de tout dommage consécutif causé par ou lié à l'utilisation ou à la performance de ce produit ou tout autre dommage indirect lié à la perte de propriété, de revenus, ou de profits, ou aux coûts d'enlèvement, d'installation ou de réinstallation.

INFORMACIÓN DE LA GARANTÍA

Wattstopper garantiza que sus productos están libres de defectos en materiales y mano de obra por un período de cinco (5) años. No existen obligaciones ni responsabilidades por parte de Wattstopper por daños consecuentes que se deriven o estén relacionados con el uso o el rendimiento de este producto u otros daños indirectos con respecto a la pérdida de propiedad, renta o ganancias, o al costo de extracción, instalación o reinstalación.
