

## VAN15S35

JOB NAME: \_\_\_\_\_

DATE: \_\_\_\_\_

TYPE: \_\_\_\_\_

### DESCRIPTION

11" or 15" round fixture. 35, 50, 70, 100 & 150w HPS lamp or 50, 70 & 100 watt Metal Halide. Housing is die formed heavy gauge aluminum in bronze enamel finish with clear vandalproof polycarbonate refractor. Lamps supplied.

### SPECIFICATIONS

#### Fluorescent Ballast Starting Temperatures: Sockets:

Electronic QT: 0° F/ -18° C NPF 120V: 32° F / 0° C HPS & MH: Medium base 4kv Pulse Rated Glazed porcelain CFL: Plug-in type, thermoplastic

#### Reflectors / Backplate:

Heavy gauge cold rolled steel with high reflectance baked white enamel

#### Refractor:

Injection molded polycarbonate, designed for maximum structural strength

#### Screws:

Tamperproof center pin Torx-head and slotted Phillips head stainless steel screws provided. Be sure to order your Torx screwdriver (Catalog # VANDRIVER)

#### UL Listing:

Suitable for wet locations. Fixtures can be wired with 90° C supply wiring if supply wires are routed 3" away from ballast.

#### Patents:

RAB sensor and fixture designs are protected under U.S. and International Intellectual Property laws

#### Color:

Bronze

#### Weight:

9.2

### DIMENSIONS

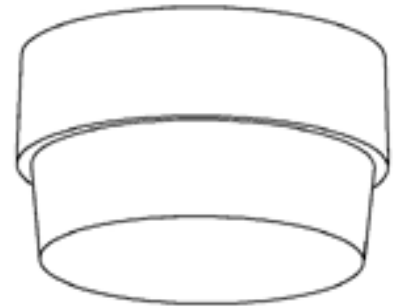

### PHOTOMETRIC

100w HPS @ 8' Mounting Height

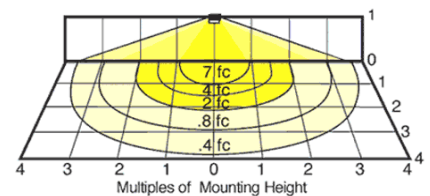

| Mounting Height | Multiplier | Watts | Multiplier HPS | MH | CFL |
|-----------------|------------|-------|----------------|----|-----|
| 8'              | 1.0        | 35    | .2             |    |     |
| 9'              | .8         | 50    | .4             |    |     |
| 10'             | .7         | 70    | .6             |    |     |
| 12'             | .4         | 100   | 1.0            | .9 |     |
| 14'             | .3         | 150   | 1.6            |    |     |
|                 |            | 64    |                |    | .5  |

### ORDERING INFORMATION

**High Pressure Sodium**  
Lamp supplied with fixture

| Total Watts | Lamp Type | Lamp Base | Ballast    |
|-------------|-----------|-----------|------------|
| 35          | ED17      | Medium    | R-NPF 120V |

| Starting Amps/ Operating Amps |      |      |      |
|-------------------------------|------|------|------|
| 120V                          | 208V | 240V | 277V |
| 1.4/0.9                       |      |      |      |

| Input Watts | LAMP ANSI | Initial Lumens | Lamp Hours |
|-------------|-----------|----------------|------------|
| 46          | S76       | 2250           | 24000      |

**Factory Installed Options**  
Add suffix to Catalog Number

Swivel Photocontrol (/PCS)  
Quartz Restrike (HPS & MH only) (/QR)

Mini Motion Sensor (/MS)  
Button Photocontrol (/PC)

Note: Specifications may change without notice