

**JUNO®**

Project: \_\_\_\_\_

Fixture Type: \_\_\_\_\_

Location: \_\_\_\_\_

Contact/Phone: \_\_\_\_\_



# 6" IC 600 LUMEN WARMDIM® LED DOWNLIGHT NEW CONSTRUCTION

IC22LED WD (G4N 06LM) RECESSED HOUSING

**OPEN TRIMS**

## PRODUCT DESCRIPTION

Dedicated LED, Air-Loc® sealed new construction housing with patented WarmDim® technology • LED color temperature warms while dimming to emulate the dimming performance of traditional incandescent light sources • Shallow housing allows for fit in 2 x 6 construction • Can be completely covered with insulation • Fully sealed housing stops infiltration and exfiltration of air, reducing heating and air cooling costs without the use of additional gaskets • LED housing is designed to provide 50,000 hours of life and is compatible with many standard Juno trims • 5 year limited warranty on LED components.

## ENVIRONMENTALLY FRIENDLY, ENERGY EFFICIENT

- No harmful ultraviolet or infrared wavelengths
- No lead or mercury
- Comparable light output to 65W BR30 incandescent while consuming 10W

## PRODUCT SPECIFICATIONS

**LED Light Engine** Proprietary patented micro processor controlled light engine emulates dimming performance of incandescent light source • Replaceable light engine integrated to thermally conductive housing provides uninterrupted heat transfer to ensure long life of the LEDs • 3000K color temperature at full lumen output • 90 CRI minimum throughout dimming range • Design covered under Patent US 8,710,754.

**Optical System** Computer-optimized reflector design with high reflectance white finish coupled with a high transmission diffusing lens conceals the LEDs and produces uniform aperture luminance • Deep regression of lens produces a low glare, efficient system that can produce over 600 lumens with select trims (see page 2 for details) using 10W • Wide flood distribution (>70°) shipped as standard with optional optic accessory available and sold separately.

**Aesthetic Trim Selections** Compatible with wide selection of existing Juno trims • Shadow free, knife edge design blends seamlessly into ceiling.

**LED Driver** Dedicated 120 volt driver • Power factor > 0.9 • Dimmable with the use of most incandescent, magnetic low voltage and electronic low voltage wall box dimmers • For a list of compatible dimmers, see [JUNOICLED-DIM](#) • Mounted between the j-box and housing for easy access and cool operation.

**Life** Rated for 50,000 hours at 70% lumen maintenance.

**Labels** ENERGY STAR® Certified when used with select trims • Certified to the high efficacy requirements of California T24 JA8-2016 with select trims • UL listed for U.S. and Canada, through-branch wiring and damp locations • Union made • UL and cUL.

**Testing** All reports are based on published industry procedures; field performance may differ from laboratory performance.

Product specifications subject to change without notice.

## HOUSING FEATURES

**Housing** Designed for use in IC (insulated ceiling) or non-IC construction • Aluminum housing sealed for Air-Loc® compliance • Housing is vertically adjustable to accommodate up to a 2" ceiling thickness.

**Junction Box** Pre-wired junction box provided with (5) 1/2" and (1) 3/4" knockouts, (4) knockouts for 12/2 or 14/2 NM cable and ground wire • UL listed and cUL listed for through-branch wiring, maximum 8 #12 branch circuit conductors • Junction box provided with removable access plates • Knockouts equipped with pryout slots • Quick connect electrical connectors supplied as standard for fast, secure installation.

**Mounting Frame** 22-gauge die-formed galvanized steel mounting frame • Rough-in section (junction box, mounting frame, housing and bar hangers) fully assembled for ease of installation.

**Real Nail 3 Bar Hangers** Telescoping Real Nail® 3 system permits quick placement of housing anywhere within 24" O.C. joists or suspended ceilings • Includes removable nail for repositioning of fixture in wood joist construction • Integral T-bar notch and clip for suspended ceilings • Design covered under US Patent D552,969.

## DIMENSIONS

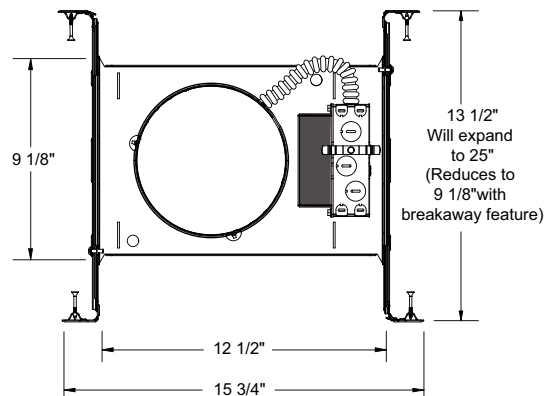
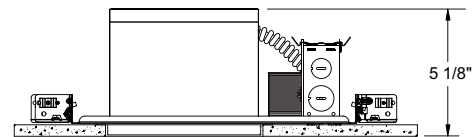

6 7/8" CEILING CUTOUT

## ELECTRICAL DATA

### Dedicated 120V Only Driver

120V	
Input Power	10W (+/- 5%)
Input Current	0.08A
Frequency	50/60 Hz
EMI/RFI	FCC Title 47 CFR, Part 15 (Class B (residential))
Minimum starting temp	-20°C

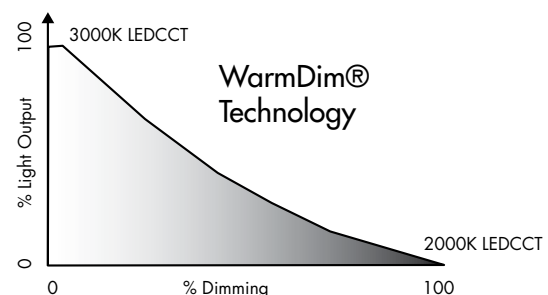
**MAINSTREAM  
DYNAMIC**  
BY ACUITY BRANDS®

# 6" IC 600 LUMEN WARMDIM® LED DOWNLIGHT NEW CONSTRUCTION

IC22LED WD (G4N 06LM) RECESSED HOUSING  
**OPEN TRIMS**

**ORDERING INFORMATION** Housing and trim can be ordered together or separate, but will always ship separately.

**Example:** IC22LED WD G4N 06LM 30K 90CRI 120 FRPC

Series	Dynamic Feature	Generation	Lumens	Color Temperature	CRI	Voltage	Driver
IC22LED 6" LED New Construction Downlight	WD Warm Dim	G4N Generation 4 New	06LM 600 Nominal Lumens	30K 3000K	90CRI 90+ CRI	120 120V	FRPC Forward/Reverse Phase Cut

## Trim/Description

	<b>24 BABZ</b> <sup>1,2</sup> <b>24 BBL</b> <sup>1,2</sup> <b>24 BSC</b> <sup>1,2</sup> <b>24 BWH</b> <sup>1,2</sup> <b>24 WWH</b>	Downlight Tapered Black Baffle, Classic Aged Bronze Trim Ring Downlight Tapered Black Baffle, Black Trim Ring Downlight Tapered Black Baffle, Satin Chrome Trim Ring Downlight Tapered Black Baffle, White Trim Ring Downlight Tapered White Baffle, White Trim Ring		<b>9024 WWH</b>	White Octagonal w/ White Baffle
	<b>27 BWH</b> <sup>1,2</sup> <b>27 CWH</b> <b>27 GWH</b> <b>27 HZWH</b> <b>27 PTSC</b> <b>27 WHZABZ</b> <b>27 WHZWH</b> <b>27 WWH</b>	Downlight Tapered Black Cone, White Trim Ring Downlight Tapered Clear Cone Alzak®, White Trim Ring Downlight Tapered Gold Cone, White Trim Ring Downlight Tapered Haze Cone, White Trim Ring Downlight Tapered Pewter Cone, Satin Chrome Trim Ring Downlight Tapered Wheat Haze Cone, Classic Aged Bronze Trim Ring Downlight Tapered Wheat Haze Cone, White Trim Ring Downlight Tapered White Cone, White Trim Ring		<b>9324 SC</b>	Luminous Disk (Frosted)
				<b>9524 SC</b>	Chrome Band
				<b>9702</b>	Luminous Collar (Frosted)

## Accessories

Catalog Number	Description
<b>LEDOPTICG3 MFL</b>	Medium Flood Optic (50°)
To order, specify catalog number.	
Catalog Number	Description
<b>TR6 ABZ</b>	6" Trim Ring - Classic Aged Bronze
<b>TR6 BL</b>	6" Trim Ring - Black
<b>TR6 SC</b>	6" Trim Ring - Satin Chrome
<b>TR6 WH</b>	6" Trim Ring - White
To order, specify catalog number.	
*TR6 available for 24 and 27 trim series only	

Trim Size: 24, 27, 9324, 9524 - 7<sup>5</sup>/<sub>8</sub>" O.D.; 9702 - 7<sup>3</sup>/<sub>4</sub>" O.D.; 9024 - 8" O.D.

Alzak is a registered trademark of Alcoa Corp.

Note: In Canada when insulation is present, Type IC fixtures must be used.

<sup>1</sup> Not ENERGY STAR® Certified

# 6" IC 600 LUMEN WARMDIM® LED DOWNLIGHT NEW CONSTRUCTION

IC22LED WD (G4N 06LM) RECESSED HOUSING  
OPEN TRIMS

## PHOTOMETRICS

### PHOTOMETRIC REPORT

**Test Report #:** PT08142501  
**Catalog No:** IC22LED WD G4N 06LM  
30K 120 with 24 WWH Trim and standard wide flood optic

**Luminaire Spacing Criterion:** 1.18

**Luminaire LPW:** 68

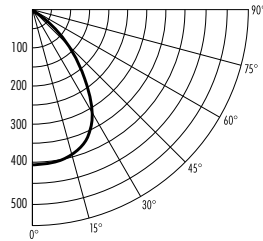

### CANDLEPOWER DISTRIBUTION (Candelas)

Degrees	0°
0	417
5	414
15	393
25	355
35	276
45	123
55	56
65	28
75	17
85	4
90	0

### AVERAGE INITIAL FOOTCANDLES

Multiple Units (Square Array, 60'x60' room)  
Ceiling 80% Wall 50% Floor 20%

Spacing	RCR1	RCR3	RCR5
4.0'	46	37	31
5.0'	29	24	20
6.0'	20	17	14
7.0'	17	13	11
8.0'	13	11	9
9.0'	10	8	7
10.0'	7	6	5

### ZONAL LUMEN SUMMARY

Zone	Lumens	%Lamp	%Fixture
0-30°	313	N/A	45.9
0-40°	481	N/A	70.6
0-60°	630	N/A	92.6
0-90°	681	N/A	100.0

### INITIAL FOOTCANDLES

(One Unit, 10W, 78.8° Beam)

Distance to Illuminated Plane (Feet)	Footcandles Beam Center	Beam Diameter
4	26.1	6.6'
6	11.6	9.9'
8	6.5	13.1'
10	4.2	16.4'

### LUMINANCE (Average cd/m²)

Degrees	Average Luminance
45	10312
55	5771
65	3937
75	3812
85	2591

### PHOTOMETRIC REPORT

**Test Report #:** PT08142504  
**Catalog No:** IC22LED WD G4N 06LM  
30K 120 with 27 HZWH Trim and standard wide flood optic

**Luminaire Spacing Criterion:** 0.78

**Luminaire LPW:** 71

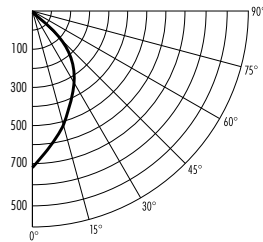

### CANDLEPOWER DISTRIBUTION (Candelas)

Degrees	0°
0	724
5	679
15	512
25	406
35	294
45	118
55	36
65	6
75	0
85	0
90	0

### AVERAGE INITIAL FOOTCANDLES

Multiple Units (Square Array, 60'x60' room)  
Ceiling 80% Wall 50% Floor 20%

Spacing	RCR1	RCR3	RCR5
4.0'	49	41	35
5.0'	31	26	22
6.0'	22	18	16
7.0'	18	15	13
8.0'	14	12	10
9.0'	11	9	8
10.0'	8	7	6

### ZONAL LUMEN SUMMARY

Zone	Lumens	%Lamp	%Fixture
0-30°	393	N/A	55.5
0-40°	573	N/A	80.9
0-60°	701	N/A	99.0
0-90°	708	N/A	100.0

### INITIAL FOOTCANDLES

(One Unit, 10W, 59° Beam)

Distance to Illuminated Plane (Feet)	Footcandles Beam Center	Beam Diameter
4	45.2	4.5'
6	20.1	6.8'
8	11.3	9.1'
10	7.2	11.3'

### LUMINANCE (Average cd/m²)

Degrees	Average Luminance
45	9926
55	3678
65	802
75	0
85	0

Fixtures tested to IES recommended standard for solid state lighting per LM-79-08. Photometric performance on a single unit represents a baseline of performance for the fixture. Results may vary in the field.