

**JUNO®**

Project: \_\_\_\_\_

Fixture Type: \_\_\_\_\_

Location: \_\_\_\_\_

Contact/Phone: \_\_\_\_\_

# 4" IC 600 LUMEN WARMDIM® LED DOWNLIGHT NEW CONSTRUCTION

IC1LED (WD G4N 06LM) RECESSED HOUSING

**OPEN TRIMS**

## PRODUCT DESCRIPTION

Dedicated LED, Air-Loc® sealed new construction housing with patented WarmDim® technology • LED color temperature warms while dimming to emulate the dimming performance of traditional incandescent light sources • Double wall, shallow housing construction allows for fit in 2 x 6 construction • Can be completely covered with insulation • Fully sealed housing stops infiltration and exfiltration of air, reducing heating and air cooling costs without the use of additional gaskets • LED housing is designed to provide 50,000 hours of life and is compatible with many standard Juno trims • 5 year limited warranty on LED components.

## ENVIRONMENTALLY FRIENDLY, ENERGY EFFICIENT

- No harmful ultraviolet or infrared wavelengths
- No lead or mercury, RoHS compliant
- Comparable light output to 65W incandescent while consuming 12W

## PRODUCT SPECIFICATIONS

**LED Light Engine** Proprietary patented micro processor controlled light engine emulates dimming performance of incandescent light source • Replaceable light engine attached to high purity aluminum, thermally conductive inner housing provides superior heat transfer to ensure long life of the LEDs • 3000K color temperature at full lumen output • 90 CRI minimum throughout dimming range • Design covered under Patent US 8,710,754.

**Optical System** Computer-optimized reflector design with high reflectance finish coupled with a high transmission diffusing lens conceals the LEDs and produces uniform aperture luminance • Deep regression of lens produces a low glare, efficient system that can produce over 600 lumens with select trims (see page 2 for details) using 10W.

**Aesthetic Trim Selections** Compatible with wide selection of existing Juno trims • Shadow free, knife edge design blends seamlessly into ceiling.

**LED Driver** Dedicated 120 volt driver • Power factor > 0.9 • Dimmable with the use of most incandescent, magnetic low voltage and electronic low voltage wall box dimmers • For a list of compatible dimmers, see [JUNOICLED-DIM](#) • Mounted inside housing for easy access from below ceiling.

**Life** Rated for 50,000 hours at 70% lumen maintenance.

**Labels** ENERGY STAR® Certified when used with select trims • Certified to the high efficacy requirements of California T24 JA8-2016 with select trims • UL listed for U.S. and Canada, through-branch wiring and damp locations • Union made • UL and cUL.

**Testing** All reports are based on published industry procedures; field performance may differ from laboratory performance.

Product specifications subject to change without notice.

## HOUSING FEATURES

**Housing** Designed for use in IC (insulated ceiling) or non-IC construction • Aluminum housing sealed for Air-Loc® compliance • Housing is vertically adjustable to accommodate up to a 1½" ceiling thickness.

**Junction Box** Pre-wired junction box provided with (6) ½" and (1) ¾" knockouts, (4) knockouts for 12/2 or 14/2 NM cable and ground wire • UL listed and cUL listed for through-branch wiring, maximum 6 #12 branch circuit conductors • Junction box provided with removable access plates • Knockouts equipped with pryout slots • Quick connect electrical connectors supplied as standard for fast, secure installation.

**Mounting Frame** 22-gauge die-formed galvanized steel mounting frame • Rough-in section (junction box, mounting frame, housing and bar hangers) fully assembled for ease of installation.

**Real Nail 3 Bar Hangers** Telescoping Real Nail® 3 system permits quick placement of housing anywhere within 24" O.C. joists or suspended ceilings • Includes removable nail for repositioning of fixture in wood joist construction • Integral T-bar notch and clip for suspended ceilings • Design covered under US Patent D552,969.

## DIMENSIONS

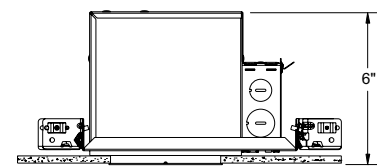
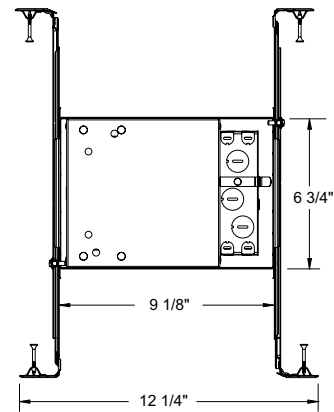

4 1/2" CEILING CUTOUT

## ELECTRICAL DATA

### Dedicated 120V Only Driver

120V	
Input Power	10W (+/- 5%)
Input Current	0.08A
Frequency	50/60 Hz
EMI/RFI	FCC Title 47 CFR, Part 15 Class B (residential)
Minimum starting temp	-20°C

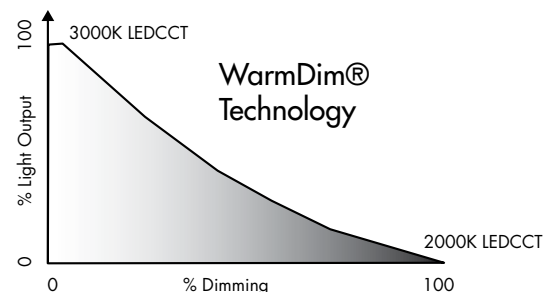

# 4" IC 600 LUMEN WARMDIM® LED DOWNLIGHT NEW CONSTRUCTION

IC1LED (WD G4N 06LM) RECESSED HOUSING  
**OPEN TRIMS**

**ORDERING INFORMATION** Housing and trim can be ordered together or separate, but will always ship separately.

**Example:** IC1LED WD G4N 06LM 30K 90CRI 120 FRPC

Series	Dynamic Feature	Generation	Lumens	Color Temperature	CRI	Voltage	Driver
IC1LED 4" LED IC New Construction Downlight	WD Warm Dim	G4N Generation 4 New	06LM 600 Nominal Lumens	30K 3000K	90CRI 90+ CRI	120 120V	FRPC Forward/Reverse Phase Cut

## Trim/Description



**13 WH** 4" Pinhole with Integral Shield - White



**14 BABZ<sup>1</sup>** 4" Downlight Baffle Trim - Black Baffle, Classic Aged Bronze Trim Ring



**14 BBL<sup>1</sup>** 4" Downlight Baffle Trim - Black Baffle, Black Trim Ring



**14 BSC<sup>1</sup>** 4" Downlight Baffle Trim - Black Baffle, Satin Chrome Trim Ring



**14 BWH<sup>1</sup>** 4" Downlight Baffle Trim - Black Baffle, White Trim Ring



**14 WWH** 4" Downlight Baffle Trim - White Baffle, White Trim Ring



**17 BWH** 4" Downlight Cone Trim - Black Cone, White Trim Ring



**17 CWH** 4" Downlight Cone Trim - Clear Alzak® Cone, White



**17 GWH** 4" Downlight Cone Trim - Gold Cone, White Trim

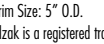

**17 HZWH** 4" Downlight Cone Trim - Haze Cone, White Trim

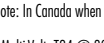

**17 PTSC** 4" Downlight Cone Trim - Pewter Cone, Satin Chrome Trim

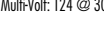

**17 WHZABZ** 4" Downlight Cone Trim - Wheat Haze Cone, Classic Aged Bronze Trim



**17 WHZWH** 4" Downlight Cone Trim - Wheat Haze Cone, White Trim



**17 WWH** 4" Downlight Cone Trim - White Cone, White Trim Ring



**4103 FROSTSC<sup>1</sup>** 4" Decorative Beveled Cylinder Trim - Frosted Glass, Satin Chrome Trim Ring



**4103 FROSTWH<sup>1</sup>** 4" Decorative Beveled Cylinder Trim - Frosted Glass, White Trim Ring



**4104 HZSC** 4" Decorative Beveled Cone Trim - Haze Cone, Satin Chrome Trim Ring



**4104 WHZABZ** 4" Decorative Beveled Cone Trim - Wheat Haze, Classic Aged Bronze Trim



**4150 MESHSC** 4" Decorative Glass Cylinder Trim - Mesh Glass, Satin Chrome Trim Ring

Trim Size: 5" O.D.

Alzak is a registered trademark of Alcoa Corp.

Note: In Canada when insulation is present, Type IC fixtures must be used.

<sup>1</sup> Multi-Volt: T24 @ 30K, 35K, 40K only

# 4" IC 600 LUMEN WARMDIM® LED DOWNLIGHT NEW CONSTRUCTION

IC1LED (WD G4N 06LM) RECESSED HOUSING  
OPEN TRIMS

## PHOTOMETRICS

### PHOTOMETRIC REPORT

Test Report #: PT09141901  
Catalog No: IC1LED WD G4N 06LM 30K  
90CRI 120 with 14 WWH Trim  
Luminaire Spacing Criterion: 0.76  
Luminaire LPW: 71

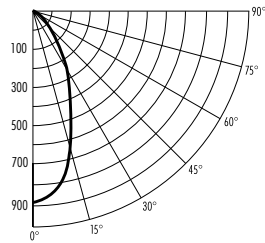

### CANDLEPOWER DISTRIBUTION (Candelas)

Degrees Vertical	0°
0	888
5	864
15	673
25	432
35	220
45	74
55	26
65	10
75	6
85	1
90	0

### AVERAGE INITIAL FOOTCANDLES

Multiple Units (Square Array, 60'x60' room)  
Ceiling 80% Wall 50% Floor 20%

Spacing	RCR1	RCR3	RCR5
4.0'	48	41	36
5.0'	31	27	23
6.0'	22	18	16
7.0'	17	15	13
8.0'	14	12	10
9.0'	11	9	8
10.0'	8	7	6

### ZONAL LUMEN SUMMARY

Zone	Lumens	%Lamp	%Fixture
0-30°	465	N/A	65.9
0-40°	602	N/A	85.4
0-60°	686	N/A	97.3
0-90°	705	N/A	100.0

### INITIAL FOOTCANDLES (One Unit, 10W, 49° Beam)

Distance to Illuminated Plane (Feet)	Footcandles Beam Center	Beam Diameter
4	55.5	3.6'
6	24.7	5.5'
8	13.9	7.3'
10	8.9	9.1'

### LUMINANCE (Average cd/m<sup>2</sup>)

Degrees	Average Luminance
45	16923
55	7238
65	4006
75	4026
85	2615

### PHOTOMETRIC REPORT

Test Report #: PT09141903  
Catalog No: IC1LED WD G4N 06LM 30K  
90CRI 120 with 17 HZWH Trim  
Luminaire Spacing Criterion: 0.74  
Luminaire LPW: 72

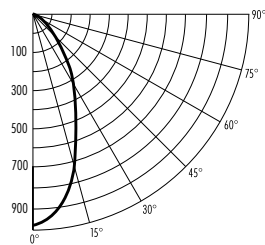

### CANDLEPOWER DISTRIBUTION (Candelas)

Degrees Vertical	0°
0	972
5	941
15	722
25	464
35	219
45	70
55	19
65	3
75	0
85	0
90	0

### AVERAGE INITIAL FOOTCANDLES

Multiple Units (Square Array, 60'x60' room)  
Ceiling 80% Wall 50% Floor 20%

Spacing	RCR1	RCR3	RCR5
4.0'	50	43	38
5.0'	32	27	24
6.0'	22	19	17
7.0'	18	15	14
8.0'	14	12	11
9.0'	11	9	8
10.0'	8	7	6

### ZONAL LUMEN SUMMARY

Zone	Lumens	%Lamp	%Fixture
0-30°	499	N/A	69.7
0-40°	638	N/A	89.1
0-60°	713	N/A	99.5
0-90°	716	N/A	100.0

### INITIAL FOOTCANDLES (One Unit, 10W, 48.2° Beam)

Distance to Illuminated Plane (Feet)	Footcandles Beam Center	Beam Diameter
4	60.8	3.6'
6	27.0	5.4'
8	15.2	7.2'
10	9.7	8.9'

### LUMINANCE (Average cd/m<sup>2</sup>)

Degrees	Average Luminance
45	16048
55	5393
65	1040
75	0
85	0

Fixtures tested to IES recommended standard for solid state lighting per LM-79-08. Photometric performance on a single unit represents a baseline of performance for the fixture. Results may vary in the field.