

Whisper LED Design2Ship™
Luminous Center

Gently sloping side panels give Whisper LED its depth and appealing angles. Whether units are installed in rows or individually, the look is artfully clean and simple. Whisper LED is available in 1' x 4', 2' x 2' and 2' x 4' sizes, and it fits perfectly in a variety of business and institutional settings including offices, schools and hospitals.

The Whisper Luminous Center is an alternate appearance to the Whisper LED that provides a unique and visually stunning aesthetic. With Luminous Center, the center element is the primary source of illumination with the side panels softly glowing, adding a captivating allure to the ceiling plane.

Type:

Project:

Catalog Number:

DO NOT TYPE HERE. Autopopulated field.

Specification Features (continued on page 2)

- Housing**
Nominal 1'x4', 2'x2' or 2'x4' housings fabricated from 22-gauge, cold-rolled steel.
- Finish**
Matte-white powder coat.
- Reflector**
Precision-formed steel; highly reflective white.
- Shielding**
Hinged door frame is constructed of extruded aluminum center and side rails with cold-rolled steel end caps capturing the 3 individual optical panels, forming a single unit. The frame can be positioned on either side of the fixture housing to provide easy room side access for maintenance. Shielding options

- are as follows:
Center Panel: Soft-white acrylic or optional microprismatic conical de-glaring lens.
Side Panels: Soft-white acrylic.
- Mounting**
Accommodates 9/16" slot grid or 15/16" inverted tee or 9/16" inverted tee.
- For recessed mounting in hard ceiling applications, use a Drywall Grid Adapter (DGA22, DGA24, or DGA14WHS). Ordered separately.
- Design2Ship**
Maximum order quantity of 250 units per order.
5 business days from clean release of the order.

Technical Drawings

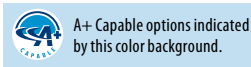
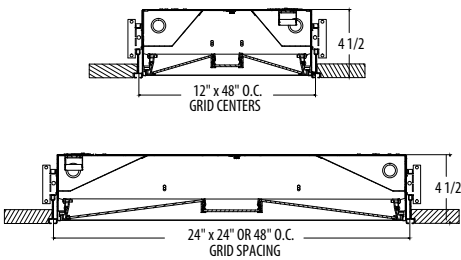

A+ Capable options indicated by this color background.



Ordering

Example: WHSPR LCTR QS 2X4 4800LM 35K 80CRI MIN1 NLIGHT MVOLT PDT SWC

Series		Decorative Element		Program		Size		LED Output ¹		LED Color Temp		LED Color Rendering		Minimum Dimming Level		Control Input	
WHSPR	Whisper LED	LCTR	Luminous Center	QS	Quick Ship (5 day Shipping)	2X2	2' x 2'	2000LM ²	2000 Lumens	30K	3000K	80CRI	>80 CRI	NODIM ³	Non-dimming	(blank)	No control input. For use with non-dimming
						2X4	2' x 4'	3000LM ³	3000 Lumens	35K	3500K	90CRI	>90 CRI	MIN10 ¹⁷	10% Minimum Dimming	ZT	0-10v
						1X4	1' x 4'	3300LM ⁴	3300 Lumens	40K	4000K			MIN1	1% Minimum Dimming	NLIGHT ¹⁰	nLight Enabled
								4000LM	4000 Lumens					DARK	<1% Minimum Dimming	NLTAIR2 ¹¹	nLight Air (wireless) Enabled
								4800LM ⁵	4800 Lumens								
								6000LM ⁶	6000 Lumens								
								7200LM ⁷	7200 Lumens								
								8500LM ⁸	8500 Lumens								
For additional ordering assistance consult 'Intelligent Luminaire Technology Guide'.																	

Voltage		Primary Sensors ¹²		Shielding Center		Options	
MVOLT	MVOLT	(blank)	No Sensor	SWC	Soft White Acrylic	E10WLCP ¹³	10 Watt battery pack, constant power with self diagnostic. T20 Compliant.
120	120V	PIR	Occupancy Sensor- Passive Infrared			EMG ¹⁴	Emergency nLight device for use with generator supply EM power
277	277V	PDT	Occupancy Sensor- Dual Technology (Passive Infrared & Microphonics)	YBC	Microprismatic Conical Deglaring Lens	CP ¹⁵	Chicago Plenum
347	347V	API	PIR Occupancy Sensor & Photocell			PWS1836	6' pre-wire, 3/8" diameter, 18 gauge, 1 circuit
		APD	PDT Occupancy Sensor & Photocell			PWS1846 PWSLV ¹⁶	Two cables: one 6' pre-wire, 3/8" diameter, 18 gauge, 2 circuits; one 6' pre-wire, 3/8" diameter, 18 gauge, purple and gray
		For additional ordering assistance consult 'Intelligent Luminaire Technology Guide'.					
						PWS1856LV ¹⁶	6' pre-wire, 3/8" diameter, 18 gauge, 1 circuit w/low voltage purple and grey wires
						PWS1846	6' pre-wire, 3/8" diameter, 18 gauge, 2 circuit

For footnotes, see page 2.

Specification Features (continued)

Source

Static LED: 3000K, 3500K, 4000K, 5000K; standard CRI >80 with optional >90

LED Life

Rated 60,000 hours (L80) at 25° C ambient temperature.

Color Consistency

The Acuity Brands circuit boards with color a variation of no greater than a 2.5 Step MacAdam (2.5SDCM) along the black body locus from board to board.

Driver

eldoLED constant current driver options deliver choice of dimming range for ultra-smooth dimming resolution from 100% to less than 1%, and choices for control, while assuring flicker free, low current inrush, 89% efficiency and low EMI. Generic 10% dimming driver also available for MIN10 option.

Two drivers used for lumen packages over 6000LM.

Consult 'Intelligent Luminaire Technology Guide' for additional details.

Integrated Controls

Optional nLight® embedded controls make luminaire addressable- allowing it to digitally communicate with other nLight enabled controls such as dimmers, switches, occupancy sensors and photocontrols. Simply connect all the nLight enabled control devices using standard CAT5 Cabling.

Consult 'Intelligent Luminaire Technology Guide' for additional details.

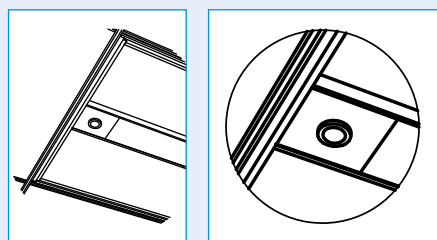

Pictured with Occupancy Sensor and Photocell

Maintenance

Serviceable from below with easy access to electrical components.

A+ Capable Luminaire

This item is an A+ capable luminaire, which has been designed and tested to provide consistent color appearance and out-of-the-box control compatibility with simple commissioning.

- All configurations of this luminaire meet the Acuity Brands' specification for chromatic consistency
- This luminaire is part of an A+ Certified solution for nLight® control networks when ordered with drivers marked by a **shaded background***
- This luminaire is part of an A+ Certified solution for nLight control networks, providing advanced control functionality at the luminaire level, when selection includes driver and control options marked by a **shaded background***

To learn more about A+, [visit www.acuitybrands.com/aplus](http://www.acuitybrands.com/aplus).

*See ordering tree for details

Certification

CSA Certified to meet U.S. and Canadian standards, CSA Certified for damp locations, IC-rated, optional Chicago plenum rating available. DesignLights Consortium® (DLC) qualified product. Not all versions of this product may be DLC qualified. Please check the DLC Qualified Products List at www.designlights.org/QPL to confirm which versions are qualified.

Warranty

5-year limited warranty. Complete warranty terms located at:

www.acuitybrands.com/CustomerResources/Terms_and_conditions.aspx

Note: Actual performance may differ as a result of end-user environment and application.

All values are design or typical values, measured under laboratory conditions at 25 °C.

Specifications subject to change without notice.

* Applies to eldoLED driver configurations.

Notes

1. Nominal values. Consult Fixture Performance table for actual delivered lumens.
2. 2000LM output valid for 2x2 and 1x4 sizes. Not available with MIN10 driver.
3. 3000LM output valid for 2x4 size. Not available with MIN10 option.
4. 3300LM output valid for 2x2 and 1x4 sizes.
5. 4800LM not available with MIN10 in 2x2 or 1x4, only with 2x4.
6. 6000LM output valid for 2x4 and 1x4 sizes. Not available with MIN10 driver.
7. 7200LM output valid for 2x4 and 1x4 sizes. Not available with MIN10 driver.
8. 8500LM output valid for 2x4 size. Not available with MIN10 driver.
9. If NODIM is selected, do not select a value from the Control Input category.
10. NLIGHT only available with MIN1 or DARK dimming.
11. NLTAIR2 not available with 1x4. Must select MIN1 or DARK. If sensor required must select API or APD.
12. Not available with 1x4 or MIN10 driver. Only available with ZT or NLIGHT control inputs. If paired with ZT, sensor will be integral but not nLight enabled. All sensors are factory-installed onboard sensors. PIR and PDT only available with NLIGHT.
13. Not available with 7200LM or 8500LM lumen packages. Test switch located on internal reflector behind diffuser. Glow of test switch visible from below.
14. nLight EMG option requires a connection to existing nLight network. Power is provided from a separate nLight cabled fixture.
15. CP not available with NLIGHT option.
16. Pre-wire whips with low voltage leads not valid with non-dimming (NODIM) fixtures or NLIGHT.
17. Must select ZT.

Fixture Performance

		Delivered Lumens	Input Watts	Lumens/ Watt
2x2	2000LM	2011	21	95
	3300LM	3349	30	113
	4000LM	4097	36	114
	4800LM	4817	50	97
2x4	3000LM	3202	30	108
	4000LM	4230	34	124
	4800LM	5063	43	118
	6000LM	6315	57	111
1x4	7200LM	7591	59	128
	8500LM	8896	95	94
	2000LM	2068	19	110
	3300LM	3345	26	129
	4000LM	4051	34	119
	4800LM	4929	46	107
	6000LM	6149	50	124
	7200LM	7277	69	105

*Results at 3500K, 80CRI, with SWC center shielding option.

How to Calculate Delivered Lumens in Emergency Mode

Use the formula below to determine the delivered lumens in emergency mode

Delivered Lumens = 1.25 x P x LPW

P = Output power of emergency driver. P = 10W for E10WLCP option.

LPW = Lumen per watt rating of the luminaire. This information is available on the ABL luminaire spec sheet. LPW = Lumen per watt rating of the luminaire. LPW information available in Performance Data section.

Design2Ship™ Program Details

- 1. All Quick Ship orders should be activated through Agile.
- 2. Ship dates are 5 business days from date of clean release. Order lines must process and code upon entry, if you have an UNK, NCI or BOM status, re-check your spec sheet to correct nomenclature.
- 3. All order received after 3:30pm EST will be processed the next business day and will receive an ESD from that date.
- 4. All purchase orders must be clearly identified as Quick Ship. Non-Quick Ship products should be ordered on a separate purchase order.
- 5. Orders with both Quick Ship products and non-Quick Ship products will default to the longest lead-time.
- 6. If an order exceeds the product specification sheet quantity, then the following shall apply:
 - a. If less than or equal to 2 times maximum Quick Ship quantity, the order will be split into two delivery dates. The first will go in 5 days followed by the second in 10 days.
 - b. If the order is more than 2 times maximum Quick Ship quantity, then the order would not qualify as a Quick Ship order.
- MAXIMUM QUANTITY OF 250 PER ORDER
- 7. Changes to the order is not permitted.
- 8. Cancellation after release will result in a 50% restock fee, minimum.
- 9. Order requirements:
 - a. Complete ship to address
 - b. Contact information
 - c. Complete Quick Ship catalog number
 - d. Pricing and commission rate
 - e. Any shipping notes / site restrictions

Mounting

Recessed, lay-in formed steel trim. Universal trim accommodates 9/16" slot grid or 15/16" inverted tee, or 9/16" inverted tee.

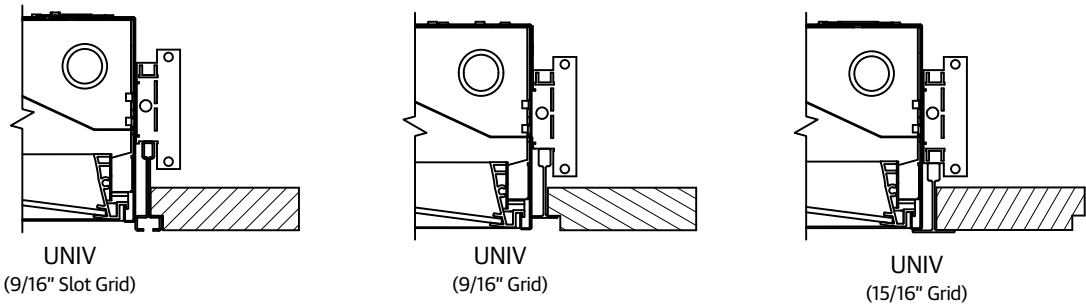

For recessed mounting in hard ceiling applications, use one of the following drywall grid adapters (ordered separately).

Fixture	Drywall Grid Adapter (DGA)
WHSPR 2X2	DGA22
WHSPR 2X4	DGA24
WHSPR 1X4	DGA14WHS

nLight Air Wireless

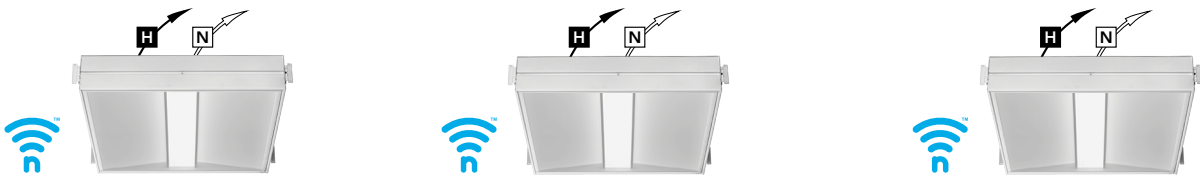

Simple as 1,2,3

- 1. Install the nLight® AIR fixtures with embedded smart sensor
- 2. Install the wireless battery-powered wall switch
- 3. With our CLAIRITY app, pair the fixtures with the wall switch and if desired, customize the sensor settings for the intended outcome



Intelligent Luminaire Technology Guide

Choose nomenclature from these columns							
Driver Configurations for Whisper	Minimum Dimming Level	Control Input		Driver	Dimming Range	Notes	
	NODIM	+	(blank)	=	0 10V Generic Driver	-	Includes no 0 10V leads from the driver.
	MIN10	+	ZT	=	0 10V Generic Driver	100 to 10%	Linear dimming
	MIN1	+	ZT	=	0 10V eldoLED ECOdrive	100 to 1%	Formerly (EZ1) nomenclature. Linear dimming
	MIN1	+	NLIGHT	=	0 10V eldoLED ECOdrive	100 to 1%	Linear dimming
	MIN1	+	ECOD	=	Lutron Digital Ecosystem (LDE1 Series)	100 to 1%	Hi-lume 1% EcoSystem LED driver with Soft-on, Fade-to-Black. Formerly (EES1) nomenclature.
	DARK	+	ZT	=	0 10V eldoLED SOLOdrive	100 to 0.1%	Formerly (EZB) nomenclature. Logarithmic dimming
	DARK	+	NLIGHT	=	0 10V eldoLED SOLOdrive	100 to 0.1%	Logarithmic dimming
	DARK	+	DALI	=	DALI compatible eldoLED SOLOdrive	100 to 0.1%	Compatible with DALI. Formerly (EDB & EDAB) nomenclature. Logarithmic dimming
	DARK	+	DMX	=	DMX compatible eldoLED POWERdrive	100 to 0.1%	Compatible with DMX / Remote Device Management. Formerly (EXB & EDXB) nomenclature.

Control / Sensor Configurations for Whisper

Choose nomenclature from these columns			
Control Input		Sensor	
ZT	+	API	=
ZT	+	APD	=
NLIGHT	+	(blank)	=
NLIGHT		EMG	=
NLIGHT	+	PIR	=
NLIGHT	+	API	=
NLIGHT	+	PDT	=
NLIGHT	+	APD	=
NLTAIR2		(blank)	
NLTAIR2		API	
NLTAIR2		APD	

Sensor
MSD 7 ADCX
MSD PDT 7 ADCX
nIO EZ PH
nIO EZ PH ER
nIO EZ PH + nES 7
nIO EZ PH + nES 7 ADCX
nIO EZ PH + nES PDT 7
nIO EZ PH + nES PDT 7 ADCX
RIO EZDL 90D G2
RES7 G2
RES7 PDT G2

Notes
Individual fixture control only. PIR integral occupancy sensor with automatic dimming control photocell. (Old nomenclature: ZT + PIR + ADC)
Individual fixture control only. PDT integral occupancy sensor with automatic dimming control photocell. (Old nomenclature: ZT + PDT + ADC)
nLight enabled only. No onboard sensor.
Emergency nLight enabled only. No onboard sensor.
nLight nES 7 PIR integral occupancy sensor. (Old nomenclature: NLIGHT + PIR)
nLight nES 7 ADCX PIR integral occupancy sensor with automatic dimming photocell. (Old nomenclature: NLIGHT + PIR + ADC)
nLight nES PDT 7 dual technology integral occupancy sensor. (Old nomenclature: NLIGHT + PDT)
nLight nES PDT 7 dual technology integral occupancy sensor with automatic dimming photocell. (Old nomenclature: NLIGHT + PDT + ADC)
https://www.acuitybrands.com/products/detail/778845/nLight/r10/Fixture-embedded-nLight-AIR-network-interface
https://www.acuitybrands.com/products/detail/593899/nLight/RES7_Sensor/nLight-AIR-Fixture-Integrated-Wireless-Sensor
https://www.acuitybrands.com/products/detail/593899/nLight/RES7_Sensor/nLight-AIR-Fixture-Integrated-Wireless-Sensor