



D-Series Size 0 LED Area Luminaire



Catalog Number
Notes
Type

Hit the Tab key or mouse over the page to see all interactive elements.

A+ Capable Luminaire

This item is an A+ capable luminaire, which has been designed and tested to provide consistent color appearance and system-level interoperability.

- All configurations of this luminaire meet the Acuity Brands' specification for chromatic consistency
- This luminaire is A+ Certified when ordered with DTL® controls marked by a **shaded background**. DTL DLL equipped luminaires meet the A+ specification for luminaire to photocontrol interoperability¹
- This luminaire is part of an A+ Certified solution for ROAM® or XPoint™ Wireless control networks, providing out-of-the-box control compatibility with simple commissioning, when ordered with drivers and control options marked by a **shaded background**¹

To learn more about A+, visit www.acuitybrands.com/aplus.

- See ordering tree for details.
- A+ Certified Solutions for ROAM require the order of one ROAM node per luminaire. Sold Separately: [Link to Roam](#); [Link to DTL DLL](#)

Specifications

EPA: 0.95 ft²
(.09 m²)

Length: 26"
(66.0 cm)

Width: 13"
(33.0 cm)

Height: 7"
(17.8 cm)

Weight (max): 16 lbs
(7.25 kg)

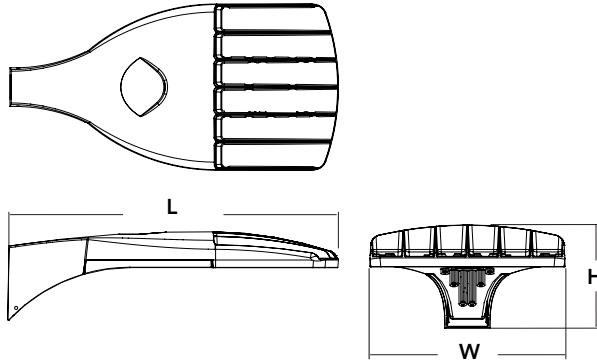

A+ Capable options indicated by this color background.

Ordering Information

EXAMPLE: DSX0 LED P6 40K T3M MVOLT SPA DDBXD

DSX0 LED					
Series	LEDs	Color temperature	Distribution	Voltage	Mounting
DSX0 LED	Forward optics P1 P4 P7 P2 P5 P3 P6 Rotated optics P10 ¹ P12 ¹ P11 ¹ P13 ¹	30K 3000 K 40K 4000 K 50K 5000 K AMBPC Amber phosphor converted ²	T1S Type I short T2S Type II short T2M Type II medium T3S Type III short T3M Type III medium T4M Type IV medium TFTM Forward throw medium TSVS Type V very short T5S Type V short T5M Type V medium T5W Type V wide BLC Backlight control ^{2,3} LCCO Left corner cutoff ³ RCCO Right corner cutoff ³	MVOLT ^{4,5} 120 ⁶ 208 ^{5,6} 240 ^{5,6} 277 ⁶ 347 ^{5,6,7} 480 ^{5,6,7}	Shipped included SPA Square pole mounting RPA Round pole mounting WBA Wall bracket SPUMBA Square pole universal mounting adaptor ⁸ RPUMBA Round pole universal mounting adaptor ⁸ Shipped separately KMA8 DDBXD U Mast arm mounting bracket adaptor (specify finish) ⁹

Control options	Other options	Finish (required)
Shipped installed NLTAIR2 nLight AIR generation 2 enabled ¹⁰ PER NEMA twist-lock receptacle only (control ordered separate) ¹¹ PER5 Five-wire receptacle only (control ordered separate) ^{11,12} PER7 Seven-wire receptacle only (control ordered separate) ^{11,12} DMG 0-10V dimming extend out back of housing for external control (control ordered separate) PIR Bi-level, motion/ambient sensor, 8-15' mounting height, ambient sensor enabled at 5fc ^{5,13,14} PIRH Bi-level, motion/ambient sensor, 15-30' mounting height, ambient sensor enabled at 5fc ^{5,13,14} PIRHN Network, Bi-Level motion/ambient sensor ¹⁵ PIR1FC3V Bi-level, motion/ambient sensor, 8-15' mounting height, ambient sensor enabled at 1fc ^{5,13,14}	PIRH1FC3V Bi-level, motion/ambient sensor, 15-30' mounting height, ambient sensor enabled at 1fc ^{5,13,14} BL30 Bi-level switched dimming, 30% ^{5,16,17} BL50 Bi-level switched dimming, 50% ^{5,16,17} PNMTDD3 Part night, dim till dawn ^{5,18} PNMT5D3 Part night, dim 5 hrs ^{5,18} PNMT6D3 Part night, dim 6 hrs ^{5,18} PNMT7D3 Part night, dim 7 hrs ^{5,18} FAO Field adjustable output ¹⁹	Shipped installed HS House-side shield ²⁰ SF Single fuse (120, 277, 347V) ⁶ DF Double fuse (208, 240, 480V) ⁶ L90 Left rotated optics ¹ R90 Right rotated optics ¹ DDL Diffused drop lens ²⁰ Shipped separately BS Bird spikes ²¹ EGS External glare shield ²¹
		DDBXD Dark bronze DBLXD Black DNAXD Natural aluminum DWHXD White DDBTXD Textured dark bronze DBLBXD Textured black DNATXD Textured natural aluminum DWHGXD Textured white



Ordering Information

Accessories

Ordered and shipped separately.

DLL127F 1.5 JU	Photocell - SSL twist-lock (120-277V) ²²
DLL347F 1.5 CUL JU	Photocell - SSL twist-lock (347V) ²²
DLL480F 1.5 CUL JU	Photocell - SSL twist-lock (480V) ²²
DSHORT SBK U	Shorting cap ²²
DSX0HS 20C U	House-side shield for 20 LED unit ²⁰
DSX0HS 30C U	House-side shield for 30 LED unit ²⁰
DSX0HS 40C U	House-side shield for 40 LED unit ²⁰
DSX0DDL U	Diffused drop lens (polycarbonate) ²⁰
PUMBA DDBXD U*	Square and round pole universal mounting bracket adaptor (specify finish) ²³
KMA8 DDBXD U	Mast arm mounting bracket adaptor (specify finish) ²³

For more control options, visit [DTL](#) and [ROAM](#) online.

NOTES

- P10, P11, P12 and P13 and rotated options (L90 or R90) only available together.
- AMBPC is not available with BLC, LCCO, RCCO, P4, P7 or P13.
- Not available with HS or DDL.
- MVOLT driver operates on any line voltage from 120-277V (50/60 Hz).
- Any PIRx with BL30, BL50 or PNMT, is not available with 208V, 240V, 347V, 480V or MVOLT. It is only available in 120V or 277V specified.
- Single fuse (SF) requires 120V, 277V or 347V. Double fuse (DF) requires 208V, 240V or 480V.
- Not available in P4, P7 or P13. Not available with BL30, BL50 or PNMT options.
- Existing drilled pole only. Available as a separate combination accessory; for retrofit use only: PUMBA (finish U); 1.5 G vibration load rating per ANCI C136.31.
- Must order fixture with SPA mounting. Must be ordered as a separate accessory; see Accessories information. For use with 2-3/8" mast arm (not included).
- Must be ordered with PIRHN.
- Photocell ordered and shipped as a separate line item from Acuity Brands Controls. See accessories. Shorting Cap included.
- If ROAM" node required, it must be ordered and shipped as a separate line item from Acuity Brands Controls. Shorting Cap included.
- Reference Motion Sensor table on page 3.
- Reference PER Table on page 3 to see functionality.
- Must be ordered with NLTAIR2. For more information on nLight Air 2 visit [this link](#).
- Requires (2) separately switched circuits.
- Not available with 347V, 480V or PNMT. For PER5 or PER7 see PER Table on page 3. Requires isolated neutral.
- Not available with 347V, 480V, BL30 and BL50. For PER5 or PER7 see PER Table on page 3. Separate Dusk to Dawn required.
- Not available with other dimming controls options.
- Not available with BLC, LCCO and RCCO distribution. Also available as a separate accessory; see Accessories information.
- Must be ordered with fixture for factory pre-drilling.
- Requires luminaire to be specified with PER, PER5 or PER7 option. See PER Table on page 3.
- For retrofit use only.

External Glare Shield

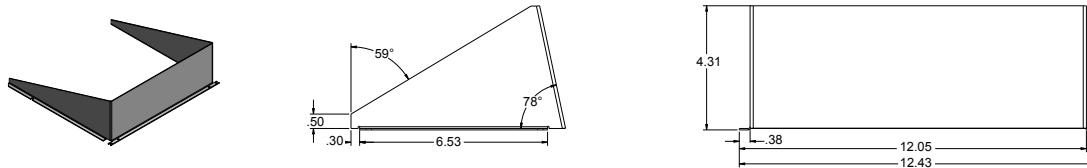

Drilling

HANDHOLE ORIENTATION

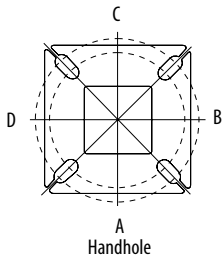

Tenon Mounting Slipfitter**

Tenon O.D.	Single Unit	2 at 180°	2 at 90°	3 at 120°	3 at 90°	4 at 90°
2-3/8"	AST20-190	AST20-280	AST20-290	AST20-320	AST20-390	AST20-490
2-7/8"	AST25-190	AST25-280	AST25-290	AST25-320	AST25-390	AST25-490
4"	AST35-190	AST35-280	AST35-290	AST35-320	AST35-390	AST35-490

Pole drilling nomenclature: # of heads at degree from handhole (default side A)

DM19AS	DM28AS	DM29AS	DM32AS	DM39AS	DM49AS
1 @ 90°	2 @ 280°	2 @ 90°	3 @ 120°	3 @ 90°	4 @ 90°
Side B	Side B & D	Side B & C	Round pole only	Side B, C, & D	Sides A, B, C, D

Note: Review luminaire spec sheet for specific nomenclature

Template #8

Top of Pole

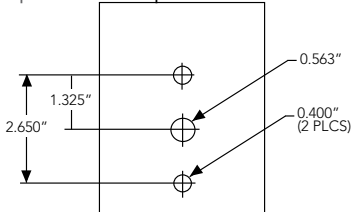

Pole top or tenon O.D.	4.5" @ 90°	4" @ 90°	3.5" @ 90°	3" @ 90°	4.5" @ 120°	4" @ 120°	3.5" @ 120°	3" @ 120°
DSX SPA	Y	Y	Y	N	-	-	-	-
DSX RPA	Y	Y	N	N	Y	Y	Y	Y
DSX SPUMBA	Y	N	N	N	-	-	-	-
DSX RPUMBA	N	N	N	N	Y	Y	Y	N

*3 fixtures @ 120 require round pole top/tenon.

Photometric Diagrams

To see complete photometric reports or download .ies files for this product, visit [Lithonia Lighting's D-Series Area Size 0 homepage](#).

Isofootcandle plots for the DSX0 LED 40C 1000 40K. Distances are in units of mounting height (20').

LEGEND

Green	0.1 fc
Dark Green	0.5 fc
Blue	1.0 fc

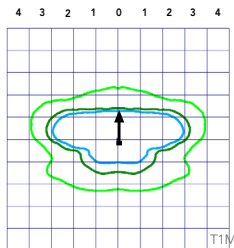

Test No. LTL23451P25 tested in accordance with IESNA LM-79-08.

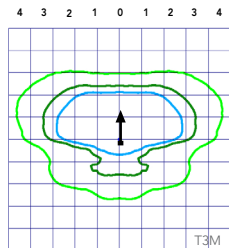

Test No. LTL23456P25 tested in accordance with IESNA LM-79-08.

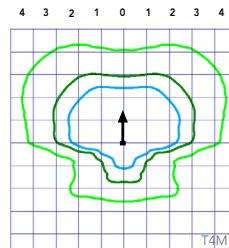

Test No. LTL23457P25 tested in accordance with IESNA LM-79-08.

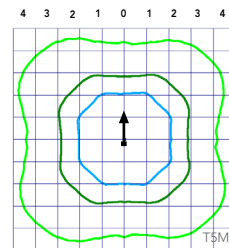

Test No. LTL23458P25 tested in accordance with IESNA LM-79-08.



Performance Data

Lumen Ambient Temperature (LAT) Multipliers

Use these factors to determine relative lumen output for average ambient temperatures from 0-40°C (32-104°F).

Ambient		Lumen Multiplier
0°C	32°F	1.04
5°C	41°F	1.04
10°C	50°F	1.03
15°C	59°F	1.02
20°C	68°F	1.01
25°C	77°F	1.00
30°C	86°F	0.99
35°C	95°F	0.98
40°C	104°F	0.97

Projected LED Lumen Maintenance

Data references the extrapolated performance projections for the platforms noted in a **25°C ambient**, based on 10,000 hours of LED testing (tested per IESNA LM-80-08 and projected per IESNA TM-21-11).

To calculate LLF, use the lumen maintenance factor that corresponds to the desired number of operating hours below. For other lumen maintenance values, contact factory.

Operating Hours	25000	50000	100000
Lumen Maintenance Factor	0.96	0.92	0.85

Electrical Load

	Performance Package	LED Count	Drive Current	Wattage	Current (A)					
					120	208	240	277	347	480
Forward Optics (Non-Rotated)	P1	20	530	38	0.32	0.18	0.15	0.15	0.10	0.08
	P2	20	700	49	0.41	0.23	0.20	0.19	0.14	0.11
	P3	20	1050	71	0.60	0.37	0.32	0.27	0.21	0.15
	P4	20	1400	92	0.77	0.45	0.39	0.35	0.28	0.20
	P5	40	700	89	0.74	0.43	0.38	0.34	0.26	0.20
	P6	40	1050	134	1.13	0.65	0.55	0.48	0.39	0.29
	P7	40	1300	166	1.38	0.80	0.69	0.60	0.50	0.37
Rotated Optics (Requires L90 or R90)	P10	30	530	53	0.45	0.26	0.23	0.21	0.16	0.12
	P11	30	700	72	0.60	0.35	0.30	0.27	0.20	0.16
	P12	30	1050	104	0.88	0.50	0.44	0.39	0.31	0.23
	P13	30	1300	128	1.08	0.62	0.54	0.48	0.37	0.27

Motion Sensor Default Settings

Option	Dimmed State	High Level (when triggered)	Photocell Operation	Dwell Time	Ramp-up Time	Ramp-down Time
PIR or PIRH	3V (37%) Output	10V (100%) Output	Enabled @ 5FC	5 min	3 sec	5 min
*PIR1FC3V or PIRH1FC3V	3V (37%) Output	10V (100%) Output	Enabled @ 1FC	5 min	3 sec	5 min

*for use with Inline Dusk to Dawn or timer.

PER Table

Control	PER (3 wire)	PER5 (5 wire)		PER7 (7 wire)	
		Wire 4/Wire5	Wire 4/Wire5	Wire 6/Wire7	Wire 6/Wire7
Photocontrol Only (On/Off)	✓	⚠	⚠	⚠	⚠
ROAM	⊘	✓	⚠	⚠	⚠
ROAM with Motion (ROAM on/off only)	⊘	⚠	⚠	⚠	⚠
Future-proof*	⊘	⚠	✓	✓	⚠
Future-proof* with Motion	⊘	⚠	✓	✓	⚠

✓	Recommended
⊘	Will not work
⚠	Alternate

*Future-proof means: Ability to change controls in the future.

Performance Data

Lumen Output

Lumen values are from photometric tests performed in accordance with IESNA LM-79-08. Data is considered to be representative of the configurations shown, within the tolerances allowed by Lighting Facts. Contact factory for performance data on any configurations not shown here.

Forward Optics																								
LED Count	Drive Current	Power Package	System Watts	Dist. Type	30K (3000 K, 70 CRI)					40K (4000 K, 70 CRI)					50K (5000 K, 70 CRI)					AMBPC (Amber Phosphor Converted)				
					Lumens	B	U	G	LPW	Lumens	B	U	G	LPW	Lumens	B	U	G	LPW	Lumens	B	U	G	LPW
40	700	P5	89W	T1S	10,831	2	0	2	122	11,668	2	0	2	131	11,816	2	0	2	133					
				T2S	10,820	2	0	2	122	11,656	2	0	2	131	11,803	2	0	2	133					
				T2M	10,876	2	0	2	122	11,716	2	0	2	132	11,864	2	0	2	133					
				T3S	10,532	2	0	2	118	11,346	2	0	2	127	11,490	2	0	2	129					
				T3M	10,849	2	0	2	122	11,687	2	0	2	131	11,835	2	0	2	133					
				T4M	10,613	2	0	3	119	11,434	2	0	3	128	11,578	2	0	3	130					
				TFTM	10,842	2	0	2	122	11,680	2	0	2	131	11,828	2	0	2	133					
				TSVS	11,276	3	0	1	127	12,148	3	0	1	136	12,302	3	0	1	138					
				TSS	11,286	3	0	1	127	12,158	3	0	1	137	12,312	3	0	1	138					
				TSM	11,257	4	0	2	126	12,127	4	0	2	136	12,280	4	0	2	138					
				TSW	11,344	4	0	3	127	12,221	4	0	3	137	12,375	4	0	3	139					
				BLC	8,890	1	0	2	100	9,576	1	0	2	108	9,698	1	0	2	109					
				LCCO	6,615	1	0	3	74	7,126	1	0	3	80	7,216	1	0	3	81					
				RCCO	6,615	1	0	3	74	7,126	1	0	3	80	7,216	1	0	3	81					
40	1050	P6	134W	T1S	14,805	3	0	3	110	15,949	3	0	3	119	16,151	3	0	3	121	6,206	2	0	2	68
				T2S	14,789	3	0	3	110	15,932	3	0	3	119	16,134	3	0	3	120	6,322	2	0	2	69
				T2M	14,865	3	0	3	111	16,014	3	0	3	120	16,217	3	0	3	121	6,201	2	0	2	68
				T3S	14,396	3	0	3	107	15,509	3	0	3	116	15,705	3	0	3	117	6,247	1	0	2	69
				T3M	14,829	2	0	3	111	15,975	3	0	3	119	16,177	3	0	3	121	6,308	2	0	2	69
				T4M	14,507	2	0	3	108	15,628	3	0	3	117	15,826	3	0	3	118	6,275	1	0	2	69
				TFTM	14,820	2	0	3	111	15,965	3	0	3	119	16,167	3	0	3	121	6,203	1	0	2	68
				TSVS	15,413	4	0	1	115	16,604	4	0	1	124	16,815	4	0	1	125	6,671	2	0	0	73
				TSS	15,426	3	0	1	115	16,618	4	0	1	124	16,828	4	0	1	126	6,569	2	0	0	72
				TSM	15,387	4	0	2	115	16,576	4	0	2	124	16,786	4	0	2	125	6,491	3	0	1	71
				TSW	15,506	4	0	3	116	16,704	4	0	3	125	16,915	4	0	3	126	6,504	3	0	2	71
				BLC	12,151	1	0	2	91	13,090	1	0	2	98	13,255	1	0	2	99					
				LCCO	9,041	1	0	3	67	9,740	1	0	3	73	9,863	1	0	3	74					
				RCCO	9,041	1	0	3	67	9,740	1	0	3	73	9,863	1	0	3	74					
40	1300	P7	166W	T1S	17,023	3	0	3	103	18,338	3	0	3	110	18,570	3	0	3	112					
				T2S	17,005	3	0	3	102	18,319	3	0	3	110	18,551	3	0	3	112					
				T2M	17,092	3	0	3	103	18,413	3	0	3	111	18,646	3	0	3	112					
				T3S	16,553	3	0	3	100	17,832	3	0	3	107	18,058	3	0	3	109					
				T3M	17,051	3	0	3	103	18,369	3	0	3	111	18,601	3	0	3	112					
				T4M	16,681	3	0	3	100	17,969	3	0	3	108	18,197	3	0	3	110					
				TFTM	17,040	3	0	3	103	18,357	3	0	4	111	18,590	3	0	4	112					
				TSVS	17,723	4	0	1	107	19,092	4	0	1	115	19,334	4	0	1	116					
				TSS	17,737	4	0	2	107	19,108	4	0	2	115	19,349	4	0	2	117					
				TSM	17,692	4	0	2	107	19,059	4	0	2	115	19,301	4	0	2	116					
				TSW	17,829	5	0	3	107	19,207	5	0	3	116	19,450	5	0	3	117					
				BLC	13,971	2	0	2	84	15,051	2	0	2	91	15,241	2	0	2	92					
				LCCO	10,396	1	0	3	63	11,199	1	0	3	67	11,341	1	0	3	68					
					10,396	1	0	3	63	11,199	1	0	3	67	11,341	1	0	3	68					

FEATURES & SPECIFICATIONS

INTENDED USE

The sleek design of the D-Series Size 0 reflects the embedded high performance LED technology. It is ideal for many commercial and municipal applications, such as parking lots, plazas, campuses, and pedestrian areas.

CONSTRUCTION

Single-piece die-cast aluminum housing has integral heat sink fins to optimize thermal management through conductive and convective cooling. Modular design allows for ease of maintenance and future light engine upgrades. The LED driver is mounted in direct contact with the casting to promote low operating temperature and long life. Housing is completely sealed against moisture and environmental contaminants (IP65). Low EPA (0.95 ft²) for optimized pole wind loading.

FINISH

Exterior parts are protected by a zinc-infused Super Durable TGIC thermoset powder coat finish that provides superior resistance to corrosion and weathering. A tightly controlled multi-stage process ensures a minimum 3 mils thickness for a finish that can withstand extreme climate changes without cracking or peeling. Available in both textured and non-textured finishes.

OPTICS

Precision-molded proprietary acrylic lenses are engineered for superior area lighting distribution, uniformity, and pole spacing. Light engines are available in 3000 K, 4000 K or 5000 K (70 CRI) configurations. The D-Series Size 0 has zero uplight and qualifies as a Nighttime Friendly™ product, meaning it is consistent with the LEED® and Green Globes™ criteria for eliminating wasteful uplight.

ELECTRICAL

Light engine(s) configurations consist of high-efficacy LEDs mounted to metal-core circuit boards to maximize heat dissipation and promote long life (up to L85/100,000 hours at 25°C). Class 1 electronic drivers are designed to have a power factor >90%, THD <20%, and an expected life of

100,000 hours with <1% failure rate. Easily serviceable 10kV surge protection device meets a minimum Category C Low operation (per ANSI/IEEE C62.41.2).

INSTALLATION

Included mounting block and integral arm facilitate quick and easy installation. Stainless steel bolts fasten the mounting block securely to poles and walls, enabling the D-Series Size 0 to withstand up to a 3.0 G vibration load rating per ANSI C136.31. The D-Series Size 0 utilizes the AERIS™ series pole drilling pattern (template #8). Optional terminal block and NEMA photocontrol receptacle are also available.

LISTINGS

UL Listed for wet locations. Light engines are IP66 rated; luminaire is IP65 rated. Rated for -40°C minimum ambient. U.S. Patent No. D672,492 S. International patent pending.

DesignLights Consortium® (DLC) Premium qualified product and DLC qualified product. Not all versions of this product may be DLC Premium qualified or DLC qualified. Please check the DLC Qualified Products List at www.designlights.org/QPL to confirm which versions are qualified.

International Dark-Sky Association (IDA) Fixture Seal of Approval (FSA) is available for all products on this page utilizing 3000K color temperature only.

WARRANTY

5-year limited warranty. Complete warranty terms located at: www.acuitybrands.com/CustomerResources/Terms_and_conditions.aspx

Note: Actual performance may differ as a result of end-user environment and application. All values are design or typical values, measured under laboratory conditions at 25 °C. Specifications subject to change without notice.

