

**JUNO****TRAC-MASTER®**

Project: \_\_\_\_\_

Avant Garde

Fixture Type: \_\_\_\_\_

**UNO/DUO™ LOW VOLTAGE SERIES**

Location: \_\_\_\_\_

**T811, T812, T814, T816, T817 and T819**

Contact/Phone: \_\_\_\_\_

**PRODUCT DESCRIPTION**

The concentric gimbal rings springing off the bottom edge of the chiseled monolith is a perfect example of "form follows function" in design. The monolith remains perfectly aligned with the trac while the gimbal ring mechanisms are free to provide broad aiming capability. On MR16 versions, the integral transformer is cleverly concealed in the monolith; also, enclosed versions are offered which eliminate any stray backlight effect from the lamps. Framed Duo models share some of the same design details of the AVIO™ series allowing both to be tastefully integrated into the same environment.

**Lamp** 20-75W MR16 (see individual fixture for max. rating).

**Lens** Glass lens included with each lampholder • Can accept up to two 2" accessories simultaneously.

**Socket** Ceramic bi-pin.

**Aiming** Uno & Duo may be adjusted up to 90° perpendicular to the trac in either direction and up to 45° parallel to the trac either direction • Framed Duo has 45° vertical aiming capability in all directions.

**Transformer** Integral solid state electronic transformer • Dimmable using dimmer specifically design for use with electronic transformers.

**Construction** Extruded aluminum vertical monolith • Durable die-cast aluminum concentric gimbal rings offer optimum adjustability • Enclosed MR16 versions eliminate stray backlight effect from lamps • Precision, one-piece die-cast aluminum grid frames on Framed Duo offer premium, consistent aesthetics.

**Adapter** Copper alloy contacts provide precise spring action -no arcing and will not take a set • True, positive electrical ground • Spring-loaded positive latch polarity indicator embossed on copper contact • "Pull-up" contact to up position for two-circuit application.

**Labels** UL listed, CSA certified.

Product specifications subject to change without notice.

**Low Voltage MR16 Uno – Open Back**

Catalog Number	Description	Finish	Lamp
<b>T811WH</b>	1-Lamp (Uno)	White	20-75W MR16
<b>T811BL</b>	1-Lamp (Uno)	Black	20-75W MR16
<b>T811SL</b>	1-Lamp (Uno)	Silver	20-75W MR16

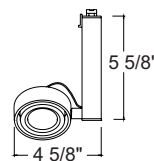
**Low Voltage MR16 Uno – Enclosed Back**

Catalog Number	Description	Finish	Lamp
<b>T816WH</b>	1-Lamp (Uno)	White	20-50W MR16
<b>T816BL</b>	1-Lamp (Uno)	Black	20-50W MR16
<b>T816SL</b>	1-Lamp (Uno)	Silver	20-50W MR16
<b>T816GP</b>	1-Lamp (Uno)	Graphite	20-50W MR16

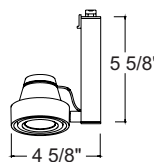
**ACCESSORIES**

Cat. No.	Description	Cat. No.	Description	Cat. No.	Description
<b>T741-6</b>	Color Filters	<b>T7477</b>	Prismatic Spread Lens	<b>T7478</b>	Linear Spread Lens
<b>T7401-18</b>	Dichroic Lenses	<b>T7420</b>	Diffuse Spread Lens	<b>T7421</b>	Uniformity Lens
<b>T7422</b>	UV Filter Lens	<b>T7459BL</b>	Hexcell Louver		

See specification sheet D1.2.2 for details.

**ELECTRICAL DATA**

	Uno	Duo
Input Voltage	120VAC	120VAC
Input Current	0.64A	0.96A
Power Factor	>0.95	>0.95
T.H.D.	<11%	<20%
Nominal Output (at max. load) volts	11.7V	11.5V
Operating Frequency	>40kHz	>25kHz

**TRAC-MASTER®**

Avant Garde

**UNO/DUO™ LOW VOLTAGE SERIES****T811, T812, T814, T816, T817 and T819****Low Voltage MR16 Duo – Open Back**

Catalog Number	Description	Finish	Lamp
<b>T812WH</b>	2-Lamp (Duo)	White	20-50W MR16
<b>T812BL</b>	2-Lamp (Duo)	Black	20-50W MR16
<b>T812SL</b>	2-Lamp (Duo)	Silver	20-50W MR16

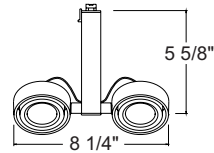
**Low Voltage MR16 Duo – Enclosed Back**

Catalog Number	Description	Finish	Lamp
<b>T817WH</b>	2-Lamp (Duo)	White	20-50W MR16
<b>T817BL</b>	2-Lamp (Duo)	Black	20-50W MR16
<b>T817SL</b>	2-Lamp (Duo)	Silver	20-50W MR16
<b>T817GP</b>	2-Lamp (Duo)	Graphite	20-50W MR16

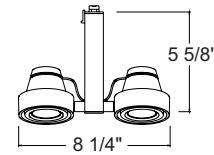
**ACCESSORIES**

Cat. No.	Description	Cat. No.	Description	Cat. No.	Description
<b>T741-6</b>	Color Filters	<b>T7477</b>	Prismatic Spread Lens	<b>T7478</b>	Linear Spread Lens
<b>T7401-18</b>	Dichroic Lenses	<b>T7420</b>	Diffuse Spread Lens	<b>T7421</b>	Uniformity Lens
<b>T7422</b>	UV Filter Lens	<b>T7459BL</b>	Hexcell Louver		

See specification sheet D1.2.2 for details.

**Low Voltage MR16 Framed Duo – Open Back**

Catalog Number	Description	Finish	Lamp
<b>T814WH</b>	2-Lamp (Duo) Framed	White	20-50W MR16
<b>T814BL</b>	2-Lamp (Duo) Framed	Black	20-50W MR16
<b>T814SL</b>	2-Lamp (Duo) Framed	Silver	20-50W MR16

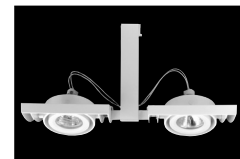
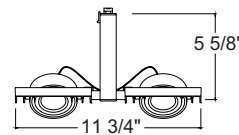
**Low Voltage MR16 Framed Duo – Enclosed Back**

Catalog Number	Description	Finish	Lamp
<b>T819WH</b>	2-Lamp (Duo) Framed	White	20-50W MR16
<b>T819BL</b>	2-Lamp (Duo) Framed	Black	20-50W MR16
<b>T819SL</b>	2-Lamp (Duo) Framed	Silver	20-50W MR16
<b>T819GP</b>	2-Lamp (Duo) Framed	Graphite	20-50W MR16

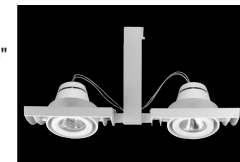
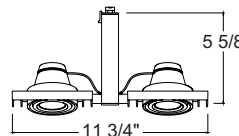
**ACCESSORIES**

Cat. No.	Description	Cat. No.	Description	Cat. No.	Description
<b>T741-6</b>	Color Filters	<b>T7477</b>	Prismatic Spread Lens	<b>T7478</b>	Linear Spread Lens
<b>T7401-18</b>	Dichroic Lenses	<b>T7420</b>	Diffuse Spread Lens	<b>T7421</b>	Uniformity Lens
<b>T7422</b>	UV Filter Lens	<b>T7459BL</b>	Hexcell Louver		

See specification sheet D1.2.2 for details.

**AIRFOIL TRIM ACCESSORY**

One piece snap-in steel construction transforms the Framed Duo appearance to a more sophisticated, sculpted look. Available in silver, graphite, white and black finishes. Custom paint or laminates may be applied in field. Materials must be rated for temperatures up to 60° C.

Catalog Number	Description	Finish
<b>T814T-WH</b>	MR16 Framed Duo Airfoil Trim	White
<b>T814T-BL</b>	MR16 Framed Duo Airfoil Trim	Black
<b>T814T-SL</b>	MR16 Framed Duo Airfoil Trim	Silver

Order airfoil trims separately.

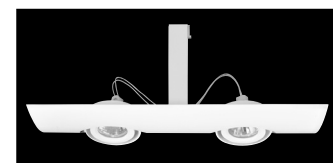
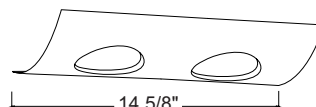

1300 S. Wolf Road • Des Plaines, IL 60018 • Phone (847) 827-9880 • Fax (847) 827-2925  
 220 Chrysler Drive • Brampton, Ontario • Canada L6S 6B6 • Phone (905) 792-7335 • Fax (905) 792-0064  
 Visit us at [www.junolightinggroup.com](http://www.junolightinggroup.com)

Printed in U.S.A. ©2009 Juno Lighting, LLC.