



Recessed and Trac Lighting

# INSTALLATION INSTRUCTIONS

## For LED Decorative Pendants

### Installation Instructions For Juno TLQJPLED78/TLQJPLED144 Pendant Cords

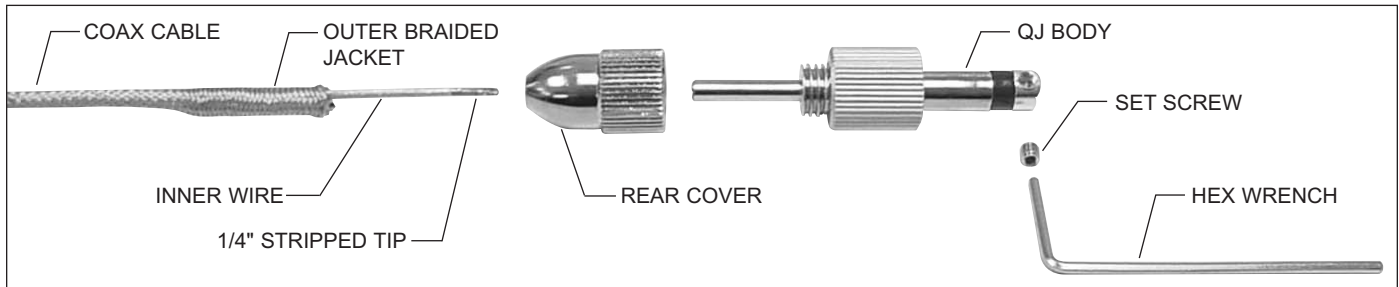

**CAUTION:** To reduce the risk of fire and electrical shock use these products only with the appropriate Juno trac system or monopoints having Quick Jack receptacles.

**WARNING:** Make sure power is off before assembly.

#### IMPORTANT SAFETY INSTRUCTIONS

1. Read all instructions completely before beginning installation. Keep these instructions in a safe place for future reference.
2. To reduce the risk of fire and burns, do not install pendant cords where the exposed conductor can be shorted or contact any conductive material.
3. Do not install any shade closer than 6 inches (15.25 cm) from any curtain or similar combustible materials.
4. To reduce the risk of fire and overheating make sure all connections are tight.
5. Turn off the electrical power before modifying the lighting system in any way.
6. Qualified electricians, in accordance with local electrical codes should perform all installations.

#### SAVE THESE INSTRUCTIONS

#### CAUTION ELECTROSTATIC DISCHARGE SENSITIVE

This product uses components that can be damaged by electrostatic discharge (ESD). Do not remove diffuser ball or touch without proper grounding.

- 1 Remove Quick Jack connector from **coax cable** by unthreading **rear cover** from **QJ body**, sliding **rear cover** down cable, loosening **set screw**, and pulling cord from connector. Remove **rear cover** from coax cable.

- 2 Using cord sleeve as a threading device, pass cord through shade as shown.

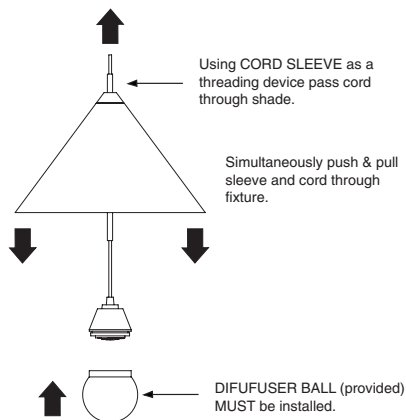

- 3 Determine desired cord length by holding cord alongside **threaded nipple** on monopoint and mark cord at the bottom edge of the **threaded nipple**. Add one inch, mark again and then cut with sharp wire cutters.

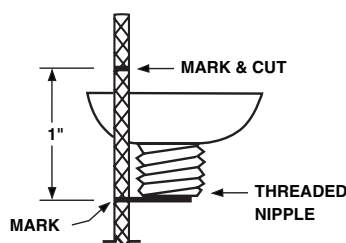

- 4 Slide **rear cover** onto the **coax cable**.



- 5 Slide back the **outer braided jacket** on the **coax cable** to expose the **inner wire**.



- 6 Strip off 1/4" of the insulation from the end of the **inner wire**. Tip: twist the exposed wires tight.



- 7 Verify the **set screw** in the tip of the **QJ body** is loosened enough for the inner wire to pass through the hole in the tip.



ETL CLASSIFIED  
CONFORMS TO UL  
STD 1598 AND  
CSA STD. C22.2 NO.250



JUNO LIGHTING GROUP  
by Schneider Electric



Recessed and Trac Lighting

# INSTALLATION INSTRUCTIONS

## For LED Decorative Pendants

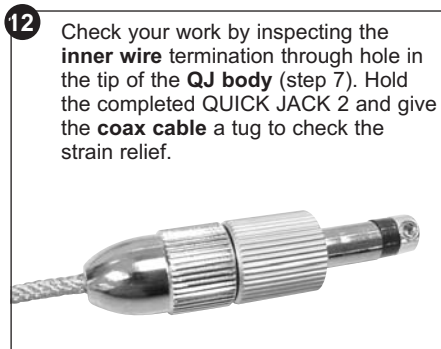
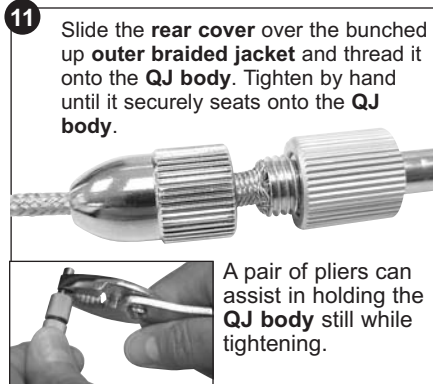
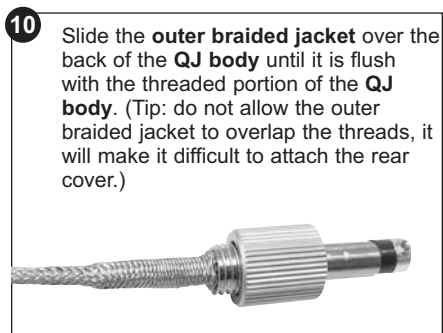
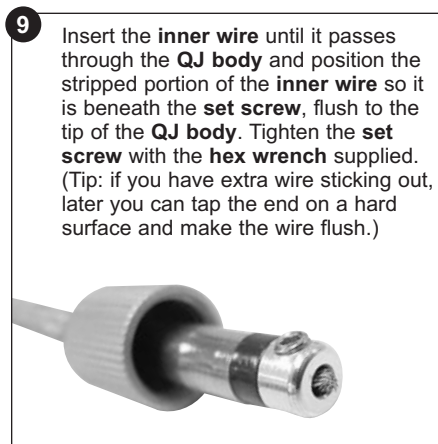
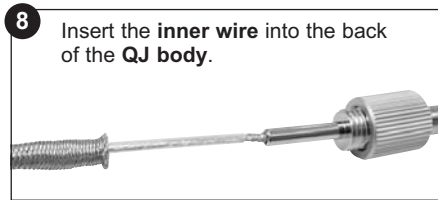

Product Services Phone (888) 387-2212

1300 South Wolf Road • Des Plaines, IL 60018 • Phone 800-323-5068 • [www.junolightinggroup.com](http://www.junolightinggroup.com)



JUNO LIGHTING GROUP  
by Schneider Electric

© 2010 Juno Lighting, LLC.

Rev 1/10

P2835

pg 2 of 2