

TRAC-MASTER®

Classics

Project: _____

Fixture Type: _____

Location: _____

Contact/Phone: _____

34W FLAT BACK CYLINDER LED

T285L

PRODUCT DESCRIPTION

With its integral driver, the cylindrical aesthetic of the T285L Series offers the simplest of form factors. It is designed with a unique, patent pending, precision optical system which produces uniform spot, flood or narrow flood distributions. The 34W T285L Series can deliver up to 3126 lumens, utilizing less than 1/3 of the energy of halogen equivalents and having a rated life of 50,000 hours. It is available in 2700K, 3000K, 3500K and 4000K color temperatures and 80 or 90 CRI versions. Optional SpectralWhite color/white enhancing versions offer CRI and Color Quality Scale (CQS) scores of 90+, rendering colors richly and making whites appear naturally brilliant. These fixtures also have an integral, bayonet-mounted optical system that enables quick conversion between beam spreads.



PRODUCT SPECIFICATIONS

Construction Die cast aluminum housing and vented concealed heat sink provides outstanding thermal management, yielding 70% average lumen maintenance at 50,000 hours of operation • Passively-cooled design – no moving parts to break or wear-out • Fashionable, elegant design complements any decor • Available in white, black or silver painted finishes.

LED High performance LED array provides outstanding reliability, performance and color quality/consistency • 2700K, 3000K, 3500K or 4000K white phosphor high performance LEDs • Chromaticity range within a 3-step MacAdam Ellipse • 80 CRI minimum on standard product • Optional high CRI versions offer 90 CRI minimum • Optional SpectralWhite color/white enhancing versions are available which make whites appear naturally brilliant and render colors more richly.

Driver Assembled into upper housing to visually integrate within fixture design • Insulating air gap between driver and LED light engine optimizes thermal operation • Provides quiet operation with or without dimming • Dimmable using high quality reverse phase dimmers approved by Juno - see [T283L-T285L-DIM](#) • Solid state electronic, Class 2 compliant • Integral overcurrent and short circuit protection • Class B FCC Part 15 rated.

Reflector Precision designed custom optical system provides either spot, narrow flood or flood beam distributions • Patent pending, multi-step optical system ensures a properly color-mixed beam • Accessory optical assemblies available to quickly and easily convert from one beam distribution to another in the field.

Accessories Filters and lenses may only be installed with Accessory Holder, Snoot or Band Doors (order separately) • Louver may only be installed with Accessory Holder or Snoot (order separately) • Accessory Holder, Snoot or Band Doors are externally mounted and attach to fixture using three set screws • Up to two of any combination of filters, lenses and louver may be installed simultaneously.

Adapter Copper alloy contacts provide precise spring action – no arcing and will not take a set • True, positive electrical ground • On /off switch included • Patented embossed polarity arrows on bottom of adapter • Spring-loaded positive latch with embossed polarity arrows secures trac light to trac • "Pull-up" contact to up positive for two-circuit application.

Aiming 360° horizontal coverage • Greater than 90° vertical aiming capability.

Labels UL and C-UL Listed • ENERGY STAR® Qualified • DesignLights Consortium® Qualified.

Warranty Warranty period is 5 years from date of purchase • Standard Juno Lighting Group product guarantee terms and conditions apply.

Product specifications subject to change without notice.

ORDERING INFORMATION:

Fixture Type	Color Temperature	Color Rendering Index	Beam Spread	Finish
T285L	27 2700K	K 80 CRI Minimum	S Spot	BL Black
34W	3 3000K	HC 90 CRI Minimum	N Narrow Flood	SL Silver
Flat Back	35 3500K	V SpectralWhite	F Flood	WH White
Cylinder LED	4 4000K	(3000K & 3500K only)		

Ordering Examples: T285L-27HCSBL, T285L-3KNWH, T285L-35VSL

ACCESSORIES:

Cat. No.	Description	Cat. No.	Description
T770BL	Black Accessory Holder	T5721	Uniformity Lens*
T770SL	Silver Accessory Holder	T5777	Prismatic Spread Lens*
T770WH	White Accessory Holder	T5778	Linear Spread Lens*
T5774BL	Black Barn Doors	T579BL	Black Cube Cell Louver*
T5788BL	Black Snoot	TR10-CL-SP	Optical Assembly - Spot
T571-6	Color Filters*	TR10-CL-NFL	Optical Assembly - Narrow Flood
T5718	Color Correction Filter* ¹	TR10-CL-FL	Optical Assembly - Flood

See specification sheet [D1.2.2](#) for details.

* Accessory Holder, Snoot or Barn Doors required to install filters or lenses; Accessory Holder or Snoot required to install louver.

¹ T5718 corrects 3000K color to approximately 2700K and 4000K color to approximately 3400K.

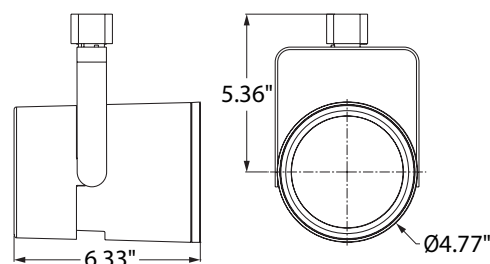

TRAC-MASTER®

Classics

34W FLAT BACK CYLINDER LED**T285L****PERFORMANCE DATA¹:**

Catalog Number	Voltage	Input Watts (Typical)	Lumens	Efficacy (LPW)	Rated Life (Hours)
T285L-27KS	120V	34	2714	80	50,000
T285L-27KN	120V	34	2673	79	50,000
T285L-27KF	120V	34	2864	84	50,000
T285L-27HCS	120V	34	2233	66	50,000
T285L-27HCN	120V	34	2199	65	50,000
T285L-27HCF	120V	34	2356	69	50,000
T285L-3KS	120V	34	2811	83	50,000
T285L-3KN	120V	34	2768	81	50,000
T285L-3KF	120V	34	2965	87	50,000
T285L-3HCS	120V	34	2302	68	50,000
T285L-3HCN	120V	34	2267	67	50,000
T285L-3HCF	120V	34	2429	71	50,000
T285L-3VS	120V	34	2456	72	50,000
T285L-3VN	120V	34	2419	71	50,000
T285L-3VF	120V	34	2592	76	50,000
T285L-35KS	120V	34	2930	86	50,000
T285L-35KN	120V	34	2885	85	50,000
T285L-35KF	120V	34	3091	91	50,000
T285L-35HCS	120V	34	2318	70	50,000
T285L-35HCN	120V	34	2345	69	50,000
T285L-35HCF	120V	34	2512	74	50,000
T285L-35VS	120V	34	2523	74	50,000
T285L-35VN	120V	34	2485	73	50,000
T285L-35VF	120V	34	2662	78	50,000
T285L-4KS	120V	34	2963	87	50,000
T285L-4KN	120V	34	2918	86	50,000
T285L-4KF	120V	34	3126	92	50,000
T285L-4HCS	120V	34	2434	72	50,000
T285L-4HCN	120V	34	2397	71	50,000
T285L-4HCF	120V	34	2569	76	50,000

ELECTRICAL DATA

Input Voltage	120V
Input Current (max.)	0.32A
Power Factor	>0.90
T.H.D.	<20%

¹Performance data, including Rated Life, is based on measurements of an individual fixture operating in a 25°C ambient.

TRAC-MASTER®

Classics

34W FLAT BACK CYLINDER LED



T285L

PERFORMANCE DATA:

CBCP • Centerbeam candlepower
FC • Footcandles at beam center (aim point)

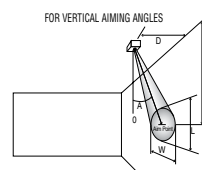
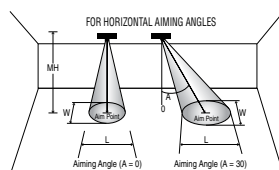
In vertical aiming applications, aim point (X) is determined by dividing distance from the wall (D) by the tangent of the desired aim angle (A) [0.5774 for 30°, 1.0 for 45°, 1.732 for 60°].

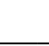

Fixture	Beam Type	Beam Spread	Rated Life	CBCP	0°			30°			30°				45°				60°						
					MH	FC	L	W	FC	L	W	D	FC	X	L	W	FC	X	L	W	D	FC	X	L	W
T285L 34W LED, 3000K Spot	S	14° 	50000	24212	10	242	2.5	2.5	157	3.4	2.9	4	189	6.9	4.2	2.0	535	4.0	2.0	1.4	8	246	4.6	2.7	2.3
					12	168	3.0	3.0	109	4.0	3.5	6	84	10.4	6.3	3.0	238	6.0	3.1	2.1	10	157	5.8	3.4	2.9
					14	124	3.5	3.5	80	4.7	4.1	8	47	13.9	8.4	4.0	134	8.0	4.1	2.8	12	109	6.9	4.0	3.5
					16	95	4.0	4.0	61	5.4	4.6	10	30	17.3	10.5	5.0	86	10.0	5.1	3.5	14	80	8.1	4.7	4.1
					18	75	4.5	4.5	49	6.1	5.2	12	21	20.8	12.6	6.0	59	12.0	6.1	4.3	16	61	9.2	5.4	4.6
T285L 34W LED, 3000K Narrow Flood	N	23° 	50000	10869	6	302	2.5	2.5	196	3.4	2.9	3	151	5.2	5.7	2.5	427	3.0	2.6	1.8	6	196	3.5	3.4	2.9
					8	170	3.3	3.3	110	4.5	3.8	4	85	6.9	7.6	3.3	240	4.0	3.5	2.3	7	144	4.0	3.9	3.3
					10	109	4.1	4.1	71	5.6	4.8	5	54	8.7	9.5	4.1	154	5.0	4.3	2.9	8	110	4.6	4.5	3.8
					12	75	5.0	5.0	49	6.7	5.7	6	38	10.4	11.4	5.0	107	6.0	5.2	3.5	9	87	5.2	5.0	4.3
					14	55	5.8	5.8	36	7.8	6.7	7	28	12.1	13.3	5.8	78	7.0	6.1	4.1	10	71	5.8	5.6	4.8
T285L 34W LED, 3000K Flood	F	40° 	50000	4927	5	197	3.7	3.7	128	5.1	4.2	2	154	3.5	9.8	2.9	435	2.0	3.4	2.1	4	200	2.3	4.1	3.4
					6	137	4.4	4.4	89	6.1	5.1	3	68	5.2	14.7	4.4	194	3.0	5.1	3.1	5	128	2.9	5.1	4.2
					7	101	5.1	5.1	65	7.2	5.9	4	38	6.9	19.6	5.9	109	4.0	6.8	4.1	6	89	3.5	6.1	5.1
					8	77	5.9	5.9	50	8.2	6.8	5	25	8.7	24.5	7.3	70	5.0	8.5	5.2	7	65	4.0	7.2	5.9
					9	61	6.6	6.6	40	9.2	7.6	6	17	10.4	**	8.8	48	6.0	10.1	6.2	8	50	4.6	8.2	6.8

For 2700K fixtures, use 0.97 multiplier; for 2700HC fixtures, use 0.79 multiplier; for 3000HC fixtures, use 0.82 multiplier; for 3000V fixtures, use 0.87 multiplier; for 3500K fixtures, use 1.04 multiplier; for 3500HC fixtures, use 0.85 multiplier; for 3500V fixtures, use 0.90 multiplier; for 4000K fixtures, use 1.05 multiplier; for 4000HC fixtures, use 0.87 multiplier.

**Due to steep aiming angle, length of beam extends beyond 25'.