



TRAC-MASTER®

Avant Garde STUDIO II

T291, T292, T293, T294 and T296

Project: _____

Fixture Type: _____

Location: _____

Contact/Phone: _____

PRODUCT DESCRIPTION

Add theatrical styling to lighting applications. Striking finishes and innovative product details make the Studio II an important design element and an effective lighting product. T292 and T296 include barn doors for PAR30 and PAR38 lamps.

Construction Die-formed aluminum housing with steel yokes and die-formed steel ring.

Lampholder Low voltage uses ceramic bi-pin socket • Line voltage uses medium base porcelain socket with nickel plated copper screw shell.

Aiming 90° vertical aiming capability and 358° horizontal rotation • One locking knob provided.

Adapter Copper alloy contacts provide precise spring action - no arcing and will not take a set • True, positive electrical ground • On/off switch included • Patented embossed polarity arrows on bottom of adapter • Spring-loaded positive latch with embossed polarity arrows secures trac light to trac • "Pull-up" contact to up position for two-circuit application.

Labels UL listed, CSA certified.

Product specifications subject to change without notice.



Line Voltage MR16 Studio II

Transformer T537 or T538 12V solid state electronic transformer with on/off switch • Dimmable • Must be ordered separately • Refer to specification sheet D1.2.1.

Catalog Number	Finish/Description	Lamp
T291WH	White/Black Integral Accessory Ring	20-50W MR16
T291BL	Black/Black Integral Accessory Ring	20-50W MR16
T291SL	Silver/Black Integral Accessory Ring	20-50W MR16

ACCESSORIES

Cat. No.	Description	Cat. No.	Description	Cat. No.	Description
T551-5	Color Filters/Lenses	T557	Prismatic Spread Lens	T559	Linear Spread Lens
T5501-16	Dichroic Lenses	T5520	Diffuse Spread Lens	T5521	Uniformity Lens
T5522	UV Filter Lens	T5559BL	Hexcell Louver		

See specification sheet D1.2.2 for details.

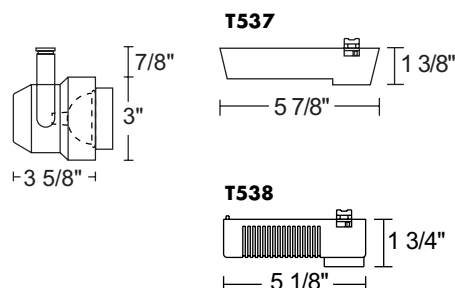

Line Voltage PAR30

Catalog Number	Finish/Description	Lamp
T293WH	White/Black Integral Accessory Ring	50-75W PAR30
T293BL	Black/Black Integral Accessory Ring	50-75W PAR30
T293SL	Silver/Black Integral Accessory Ring	50-75W PAR30

ACCESSORIES

Cat. No.	Description	Cat. No.	Description	Cat. No.	Description
T561-6	Color Filters	T569BL	Cube Cell Louver	T5677	Prismatic Spread Lens
T5678	Linear Spread Lens	T5621	Uniformity Lens	T5622	UV Filter

See specification sheet D1.2.2 for details.

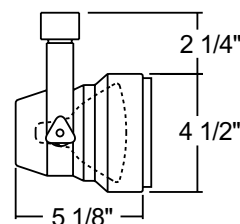

TRAC-MASTER®

Avant Garde

STUDIO II**T291, T292, T293, T294 and T296****Line Voltage PAR30**

Catalog Number	Finish/Description	Lamp
T292SL	Silver/Black Barn Door & Accessory Clips	75W PAR30
T292BL	Black/Black Barn Door & Accessory Clips	75W PAR30

ACCESSORIES

Cat. No.	Description	Cat. No.	Description	Cat. No.	Description
T571-6	Color Filters	T579BL	Cube Cell Louver	T5777	Prismatic Spread Lens
T5778	Linear Spread Lens	T5721	Uniformity Lens	T5722	UV Filter

See specification sheet D1.2.2 for details.

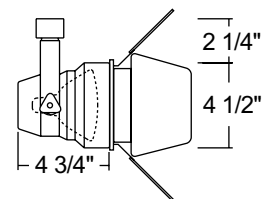
**Line Voltage PAR38**

Catalog Number	Finish/Description	Lamp
T294WH	White/Black Integral Accessory Ring	45-150W PAR38
T294BL	Black/Black Integral Accessory Ring	45-150W PAR38
T294SL	Silver/Black Integral Accessory Ring	45-150W PAR38

ACCESSORIES

Cat. No.	Description	Cat. No.	Description	Cat. No.	Description
T571-6	Color Filters	T579BL	Cube Cell Louver	T5777	Prismatic Spread Lens
T5778	Linear Spread Lens	T5721	Uniformity Lens	T5722	UV Filter

See specification sheet D1.2.2 for details.

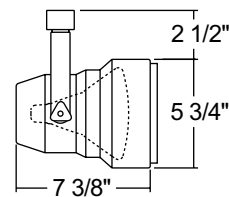
**Line Voltage PAR38**

Catalog Number	Finish/Description	Lamp
T296SL	Silver/Black Barn Door & Accessory Clips	45-150W PAR38
T296BL	Black/Black Barn Door & Accessory Clips	45-150W PAR38

ACCESSORIES

Cat. No.	Description	Cat. No.	Description
T581-6	Color Filters	T589BL	Cube Cell Louver

See specification sheet D1.2.2 for details.

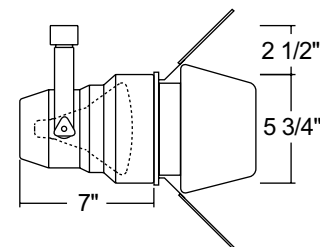

1300 S. Wolf Road • Des Plaines, IL 60018 • Phone (847) 827-9880 • Fax (847) 827-2925
 220 Chrysler Drive • Brampton, Ontario • Canada L6S 6B6 • Phone (905) 792-7335 • Fax (905) 792-0064
 Visit us at www.junolightinggroup.com

Printed in U.S.A. ©2009 Juno Lighting, LLC.