

Classic Series Front Lamping Gimbals



Front Lamping Gimbals

A Juno innovation, the front-loading gimbal ring combines the practicality, versatility and economy of traditional gimbal ring trac fixtures with a fixed socket housing to allow simplified front relamping.

Dimensions

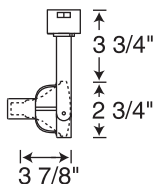

Catalog

T687WH
T687BL
T687NA

Finish

White
Black
Natural

Lamp

35-50W PAR20



Dimensions

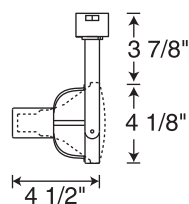

Catalog

T689WH
T689BL
T689NA

Finish

White
Black
Natural

Lamp

35-75W PAR30



Dimensions

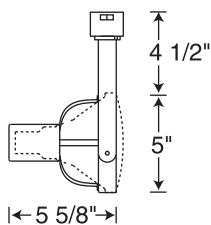

Catalog

T690WH
T690BL
T690NA

Finish

White
Black
Natural

Lamp

45-250W PAR38



Trac-Master®

Note: The Natural (NA) finish is merely a raw finish with a clear protective coating applied—inconsistencies, scratches, and minor processing marks are part of the unique aesthetic created by this process and should be expected.



JUNO LIGHTING GROUP
by Schneider Electric