

Facet®

Sweeping lines, arresting angles, and a brilliant lack of symmetry result in a totally unexpected design. Facet's socket housing morphs into a stem that is uniquely horizontal in nature. Concealed wiring and sleek trac adapter complete the ultra-clean appearance. Facet for Trac-Master is designed for use with 50W PAR20, 75W PAR30, and 150W PAR38 line-voltage halogen lamps and 50W MR16 low-voltage halogen lamps. An optional, integral, bayonet-mount media cartridge is available for the PAR30 fixture that simultaneously accepts up to two light control accessories. A dual accessory media cartridge is standard on the MR16 fixture.

Dimensions

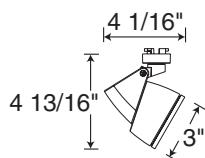

Catalog

T850WH
T850BL
T850SL

Finish

White
Black
Silver

Lamp

12V, 20-50W MR16



T537 or T538 Transformer required.
Must order separately. See page 821 for detailed information.

Dimensions

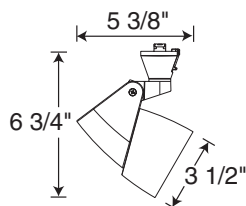

Catalog

T852WH
T852BL
T852SL

Finish

White
Black
Silver

Lamp

35-50W PAR20



Dimensions

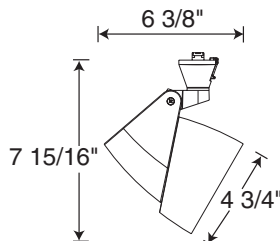

Catalog

T853WH
T853BL
T853SL

Finish

White
Black
Silver

Lamp

35-75W PAR30



Dimensions

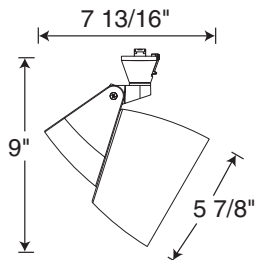

Catalog

T858WH
T858BL
T858SL

Finish

White
Black
Silver

Lamp

45-150W PAR38



Light Control Accessories

For Fixtures:	T850	T853
Accessory Holder*	-	T853MC-WH, -BL, -SL
Color Filters/Lenses	T741-6	T561-6*
Prismatic Spread Lens	T7477	T5677*
Linear Spread Lens	T7478	T5678*
Dichroic Lenses	T7401-18	T5618*
Diffuse Spread Lens	T7420	-
Uniformity Lens	T7421	T5621*
UV Filter Lens	T7422	T5622*
Hexcell Louver	T7459BL	-
Cube Cell Louver	-	T569BL*

*Filters, lenses and louver require dual accessory holder for installation.

20-75VA 12V Transformers

Both **T537** and **T538** are available in white, black or silver finishes. See page 821 for a full description, or page 819 for Monopoint Transformers.

T537

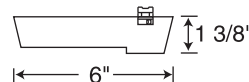

T538

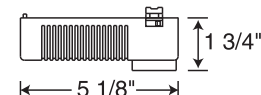

JUNO LIGHTING GROUP
by Schneider Electric

Mamba®

The Mamba is a strikingly original, front loading gimbal ring design. Gracefully curved and tapered elements flow into a gimbal ring that appears to float, while the gently scooped socket housing reinforces a concave/convex theme. Mamba for Trac-Master low voltage is designed to use 50W MR16CG halogen lamps with integral cover glass. Media cartridges are not available for this fixture due to the unique characteristics of the gimbal ring design.



Catalog

T860WH
T860BL
T860SL

Finish

White
Black
Silver

Lamp

12V, 20-50W MR16CG
Cover Glass

Dimensions

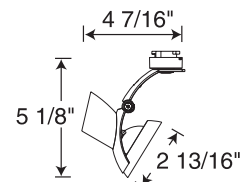

T537 or T538 transformer required.
Must order separately. See page 821 for detailed information.

Xanadu®

Stunning simplicity yields a classic beauty. Xanadu's stem elevates from the fixture as though carved from a section of its cone shaped body. Its pure shape is devoid of extraneous detail. Concealed wiring produces an ultra-clean appearance. Xanadu for Trac-Master low voltage is designed to use 50W MR16 halogen lamps. A dual accessory media cartridge is standard on the MR16 fixture.



Catalog

T870WH
T870BL
T870SL

Finish

White
Black
Silver

Lamp

12V, 20-50W MR16

Dimensions

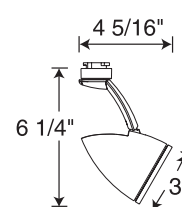

T537 or T538 transformer required.
Must order separately. See page 821 for detailed information.

Facet®

Sweeping lines, arresting angles, and a brilliant lack of symmetry result in a totally unexpected design. Concealed wiring completes the ultra-clean appearance. Facet for Trac-Master low voltage is designed to use with 50W MR16 halogen lamps. A dual accessory media cartridge is standard on the MR16 fixture.



Catalog

T850WH
T850BL
T850SL

Finish

White
Black
Silver

Lamp

12V, 20-50W MR16

Dimensions

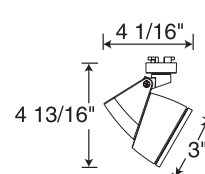

T537 or T538 transformer required.
Must order separately. See page 821 for detailed information.

Light Control Accessories

For Fixtures: T850, T870

Color Filters/Lenses	T741-6
Prismatic Spread Lens	T7477
Linear Spread Lens	T7478
Dichroic Lenses	T7401-18
Diffuse Spread Lens	T7420
Uniformity Lens	T7421
UV Filter Lens	T7422
Hexcell Louver	T7459BL

20-75VA 12V Transformers

Both **T537** and **T538** are available in white, black or silver finishes. See page 821 for a full description, or page 819 for Monopoint Transformers.

T537

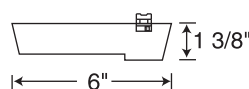

T538

