

Juno® Trac 12/25

Installation Instructions

For Juno TLR95 and TLR96 Cable Feed and Mechanical Support Important Safety Instructions-Save these Instructions

Read all of these installation instructions before installing the trac system.

Do not install this trac in damp or wet locations.

Do not install any fixture assembly closer than 6" from any curtain or similar combustible material.

Disconnect electrical power before adding to or changing the configuration of the trac.

Do not attempt to energize anything other than lighting fixtures on the trac. To reduce the risk of fire or electrical shock, do not attempt to connect power tools, extension cords, appliances and the like to the trac.

Power to this trac system is to be supplied by either Juno 12V transformers (TL544N, TL547 (remote mounted only), TL548, TL549, TL550, TL554, TF5150, TF5300, TF5300-277, TF5600, TF5600-277, TF6150E, TF6300) or 24V transformers (TL551, TL552, TL553, TF5600-24V, TF5600-277-24V, TF51200-24V, TF51200-277-24V). Check with a qualified electrician before wiring trac. If 25 amps is exceeded anywhere in the installed trac system, an overload will occur, resulting in a potential fire.

These mounting kits are to be used with Juno TLR series trac systems only. Use only fixtures intended for use with Juno TL or TLR series trac. Save these instructions and refer to them when additions to or changes in the trac configuration are made.

TLR95 Adjustable Stainless Steel Cable Mechanical Support Kit

Provides mechanical support to Trac12/25 with an adjustable stainless steel cable. TLR95 is compatible with most standard 15/16" exposed tee ceiling suspension systems (using either flush or drop ceiling tiles) or a drywall ceiling.

NOTE: The total number of cable suspension kits per section of trac must be as follows:

- * 2' (TLR2), 4' (TLR4) and 6' (TLR6) require 2 pendant mounting kits per section of trac.
- * 8' (TLR8) requires 3 pendant mounting kits per section of trac.

1. Based on Figure 1, select the TLR95 components that correspond to the current application (note: all parts in kit will not be used).
2. Determine where the mounting kit will be installed, and mark the mounting surface or T-bar.

3. Based on the application, choose one of the following:

Grid Mounting:

- * Put the chosen screw through the hole in the T-bar grid clip (verify screw rotation is prevented by the forms in the T-bar grid clip). Snap the T-bar grid clip / screw assembly over the marks from step 2, and rotate until the grid clip locks into place. (see figure 2)
- * If using the TLR95 with a drop ceiling tile, thread the #10-32 nut about halfway onto the installed T-bar grid clip / screw assembly (reference figure 1). Push the canopy over the screw until it stops on the #10-32 nut; adjust the height of the #10-32 nut until the canopy sits flush with the bottom of the ceiling tile.
- * Push the canopy over the installed grid clip / screw assembly, and secure in place with the nylon nut.

(continued on page 2)

TLR95 Configuration Diagram

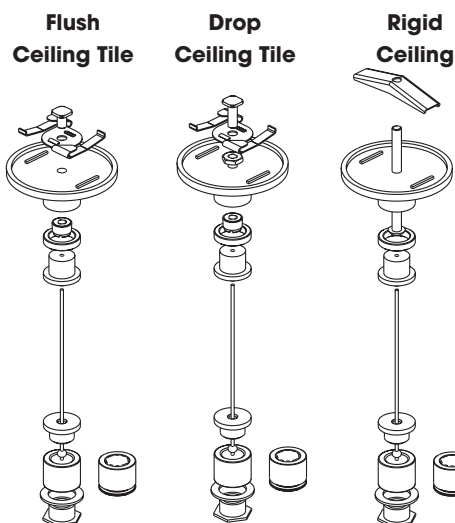

WARRANTY

Juno warrants that its products are free from defects in material and workmanship. Juno's obligation is expressly limited to repair or replacement, without charge, at Juno's factory after prior written return authorization has been granted. This warranty shall not apply to products which have been altered or repaired outside of Juno's factory. This warranty is in lieu of all other warranties, express or implied, and without limiting the generality of the foregoing phrase, excludes any implied warranty of merchantability. Also, there are no warranties which extend beyond the description of the product on the company's literature setting forth terms of sale.

Product Services phone (888) 387-2212

© 2003 Juno Printed in USA Juno lighting, inc 1300 S. Wolf Road Des Plaines, IL 60017 Visit us at www.junolighting.com

P2510 Pg 1 of 4

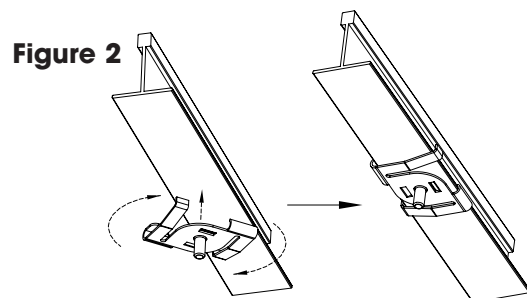
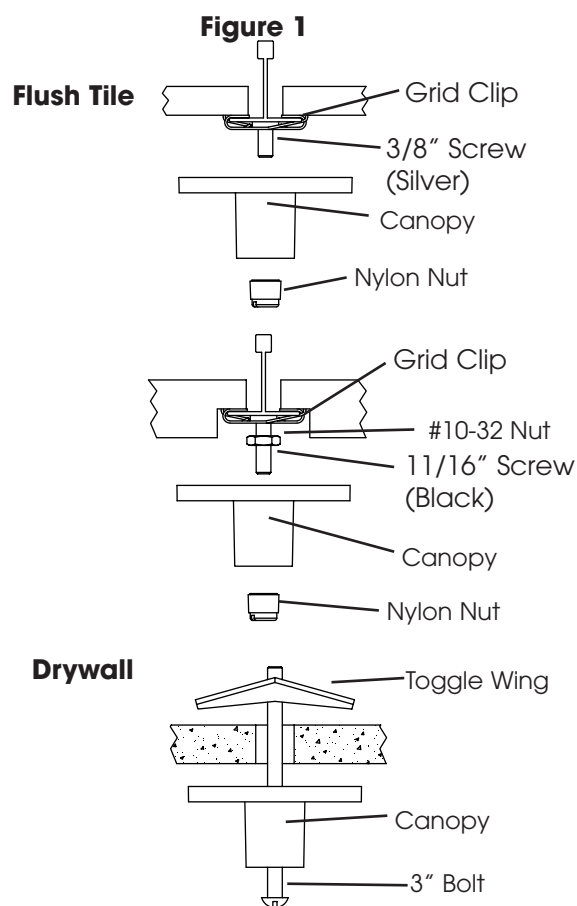

JUNO® Trac 12/25

Drywall mounting:

* Drill a 5/16" hole in the surface at the mark from step 2.

* Insert the 3" bolt through the hole in the center of the canopy and start the toggle wing on the end of the 3" bolt (reference figure 1). While holding the toggle wing closed, insert the assembly through the 5/16" hole in the surface. Pull down slightly on the canopy while tightening the 3" bolt until the toggle wing is adequately securing the assembly.

4. Determine if the trac will be supported from a TLR series connector or from the TLR series trac extrusion, and select the corresponding components according to figure 3. The components that are not used can be discarded. Pass the end of the cable without the ball through the hole in the cable stop bushing as shown in figure 3. Thread the cable stop bushing into either the coupling or sliding bushing.

5. Insert 2" of cable through the adjuster (reference figure 4) and put the spacer over the threaded portion of the cable adjuster. Bring the cable assembly close to the canopy, and line up the cable so it passes through the canopy hole. Thread the cable adjuster assembly into the canopy. Note: an 11/16 open-end wrench eases installation.

6. Adjust the cable to desired height by either pulling on the extra cable from the canopy hole to raise, or depressing the center sleeve on the cable adjuster and pulling cable away from canopy to lower. The cable can be trimmed flush with the canopy hole once final position is obtained.

7. If fastening the TLR95 to a connector, make the remaining mechanical connections as shown in figure 3. Follow the instructions included with the connector for additional mechanical & electrical installation requirements. If fastening the TLR95 to the trac extrusion, slide to desired location on track (note: the small plastic grommet in the TLR series trac (used for flush mount applications) can be pushed out of the way by hand if it interferes with the sliding bushing).

Figure 3

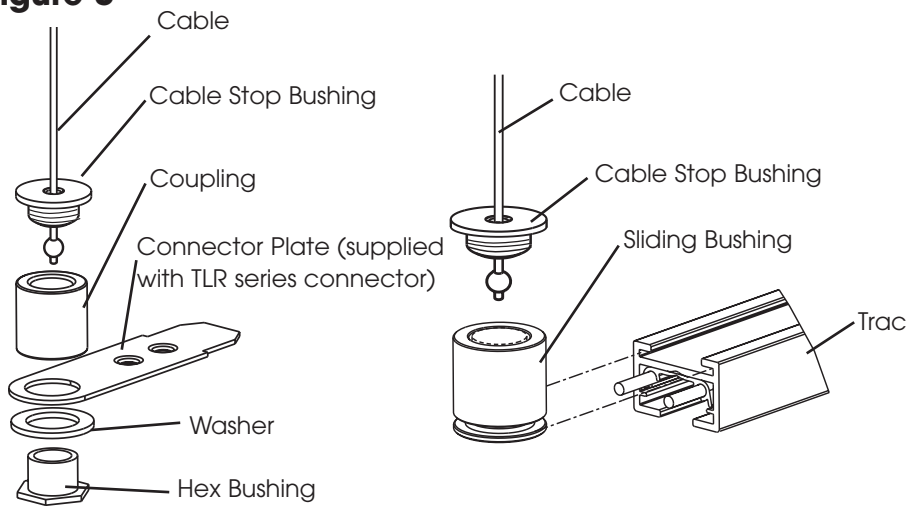
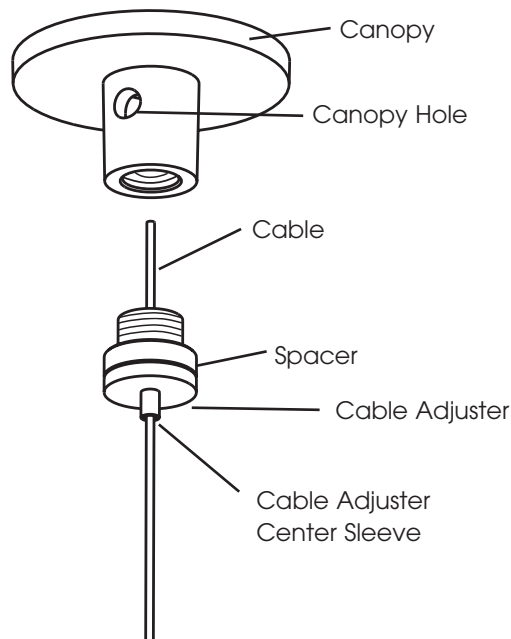

Figure 4



JUNO® Trac 12/25

TLR96 Adjustable Stainless Steel Cable Feed & Mechanical Support

Provides an electrical connection to trac with a 10ga clear tandem cord from a remote mounted low voltage transformer when mounted to a J-Box. The TLR96 also provides mechanical support of trac via stainless steel cable.

Notes:

- * The TLR96 requires a TLR50 (purchased separately) for connection to TLR Series Trac.
- * The total number of cable suspension kits per section of trac must be as follows:
 - 2' (TLR2) and 4' (TLR4) require 2 pendant-mounting kits per section of trac.
 - 6' (TLR6) and 8' (TLR8) require 3 pendant-mounting kits per section of trac.

1. Remove the TLR50 cover and terminal block as outlined in the TLR50 instructions.

2. Pass the tandem cord through the TLR50 mounting plate and through the slot in the strain relief bracket (supplied with TLR96) as shown in figure 5.

3. Bend tandem cord towards front of plate. Adjust position of wire until the factory stripped end lines up with the corresponding marks on the plate.

4. Bend tandem cord around the strain relief bracket so they straddle the bracket as shown in figure 6.

5. Connect the TLR50 terminal block to the end of the tandem cord and connect terminal block to mounting plate outlined in the TLR50 instructions

6. Pass the end of the cable without the ball through the hole in the cable stop bushing as shown in figure 3 (connection to trac). Thread the cable stop bushing into the sliding bushing and slide to desired location on track (note: the small plastic grommet in the TLR series trac (used for flush mount applications) can be pushed out of the way by hand if it interferes with the sliding bushing).

7. Connect the TLR50 to the trac and fasten TLR50 cover as outlined in the TLR50 instructions.

8. Remove strap from canopy by removing the 2 screws, and set strap aside. Insert the end of the cable through the center hole in the cable adjuster (installed in the canopy). While holding the canopy in place by hand, adjust the cable to desired height by either pulling on the extra cable from the back side of the cable adjuster to raise, or depressing the center sleeve on the cable adjuster and pulling cable away from canopy to lower. The cable can be trimmed once final position is obtained.

9. Insert tandem cord through slot in canopy. Place fiber washer over tandem cord, followed by the strain relief clamp. Route wires along the cable with the enclosed wire ties. When cable is in the intended position, tighten strain relief clamp until snug (see figure 7). Trim tandem cord wires minimum 6" from the backside of the canopy.

10. Make electrical connection to the transformer secondary wires in the junction box in accordance with Local & National Electric Codes.

11. Install the strap to the junction box with the 2 junction box screws (not supplied). (strap is compatible with 3 1/4" & 4" octagon / round j-box, plaster ring j-box covers, handy boxes & switch boxes).

12. Line up the canopy holes with the tapped holes in the strap. Hold in place while securing the canopy with the 2 screws removed in step 8.

Figure 5

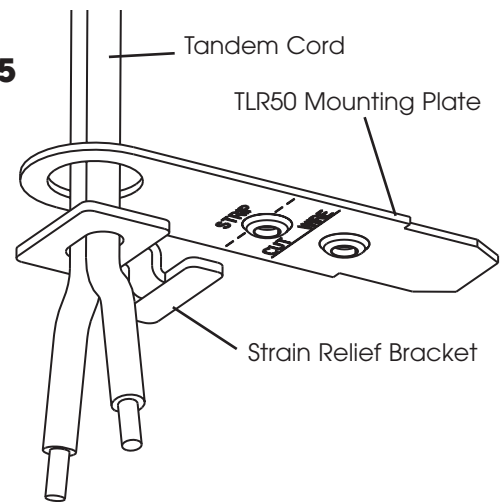

Figure 6

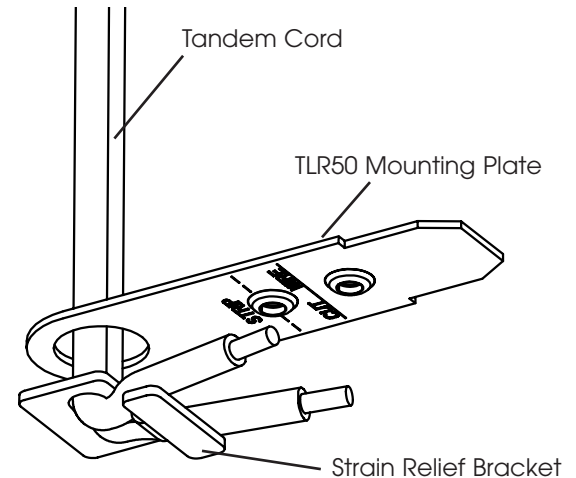
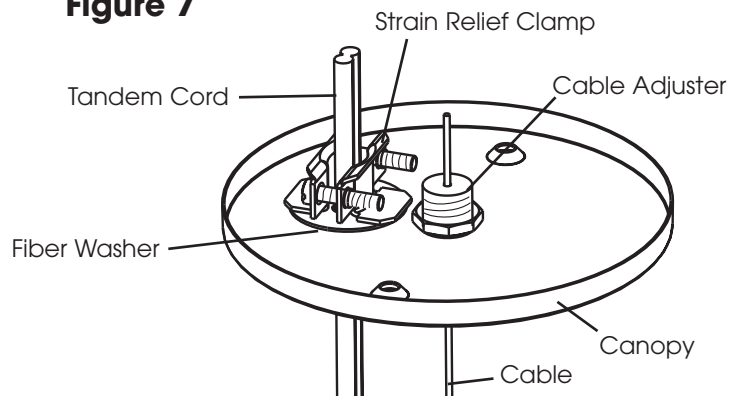

Figure 7



TLR96 Configuration Diagram

