



Project: _____

Fixture Type: _____

Location: _____

Contact/Phone: _____

PRODUCT DESCRIPTION

Dedicated LED new construction housing with integral light engine • Shallow housing allows for fit in 2 x 6 construction • TC housing design for use in non-insulated areas • If installed where insulation is present, the insulation must be pulled back 3" from all sides of the TC housing • LED housing is designed to provide 50,000 hours of life and is compatible with many standard Juno trims • 5 year limited warranty on LED components.

ENVIRONMENTALLY FRIENDLY, ENERGY EFFICIENT

- No harmful ultraviolet or infrared wavelengths
- No lead or mercury
- Comparable light output to two 26W or one 57W compact fluorescent, while consuming 26W*

PRODUCT SPECIFICATIONS

LED Light Engine LED array integrated to one piece high purity aluminum, thermally conductive housing provides uninterrupted heat transfer to ensure long life of the LED • Replaceable light engine mounts directly to housing and incorporates the latest generation, high lumen output LED array • LEDs are binned within a 3-Step MacAdam Ellipse exceeding ENERGY STAR® requirements yielding superior fixture to fixture color uniformity • 2700K, 3000K, 3500K or 4100K color temperatures available • 90 CRI minimum.

Optical System Painted white scoop is designed to work with computer-optimized reflector design to direct light toward wall uniform illumination on vertical surfaces while concealing LED optic assembly and minimizing glare • LEDs are concealed by high transmission diffusing lens • Retention bar holds scoop assembly to trim • White or black baffle available.

Aesthetic Trim Selections Low profile scoop wall wash trim • Shadow free, knife edge design blends seamlessly into ceiling.

LED Driver Universal voltage driver that accommodates input voltage from 120-277 volts AC at 50/60Hz is standard and is dimmable with the use of most 0-10V dimmers • Power factor > 0.9 at 120V input • Optional Lutron Hi-Lume® A-Series driver accommodates 120-277 volts AC at 50/60Hz • Mounted between the j-box and housing for easy access and cool operation • For a list of compatible dimmers, see [JUNOTCLED-DIM](#).

Emergency Battery Option Battery factory assembled to housing with remote mounted test switch included • Drives LED array for 90 minutes to meet Life Safety Code (NFPA-LSC), National Electrical Code (NEC) and UL requirements • Provides 24% light output in emergency mode.

Life Rated for 50,000 hours at 70% lumen maintenance.

Labels UL listed for U.S. and Canada through-branch wiring, damp locations • Union made • UL and cUL listed.

Testing All reports are based on published industry procedures; field performance may differ from laboratory performance.

Product specifications subject to change without notice.

HOUSING FEATURES

Housing Designed for use in TC applications (non-insulated) • Aluminum housing • Housing is vertically adjustable to accommodate up to a 2" ceiling thickness.

Junction Box Pre-wired junction box provided with (5) 1/2" and (1) 3/4" knockouts and ground wire, UL listed and cUL listed for through-branch wiring, maximum 8 No. 12 AWG 90° C branch circuit conductors (4 in, 4 out) • Junction box provided with removable access plates • Knockouts equipped with pryout slots.

Mounting Frame 16-gauge galvanized steel mounting ring equipped with vertically adjustable mounting brackets that accept 1/2" conduit or "C" channels (HB-26 or HB-50), linear flat bars (LB-27) or Patented (US Patent D552,969) Real Nail® 3 bar hangers (HB-1).

*Nominal input wattage @ 120V with standard universal voltage driver under stable operating conditions

6" TC 2000 LUMEN LED DOWNLIGHT NEW CONSTRUCTION

TC2022LED4 RECESSED HOUSING WALL WASH TRIMS

DIMENSIONS

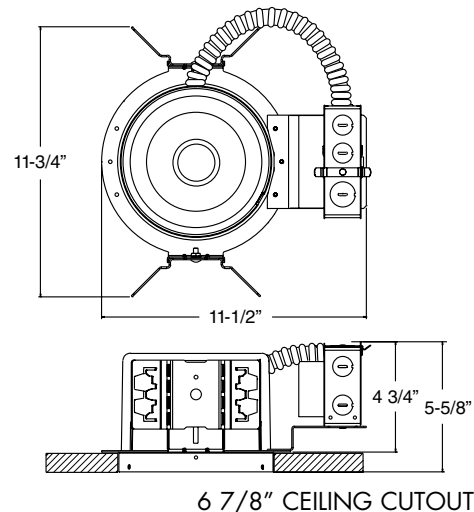

ELECTRICAL DATA

STANDARD UNIVERSAL VOLTAGE DRIVER (-U)

	120V	277V
Input Power	26.3W (+/-5%)	26.0W (+/-5%)
Input Current	0.22A	0.10A
Frequency	50/60Hz	50/60Hz
EMI/RFI	FCC Title 47 CFR, Part 15, Class A (Commercial)	FCC Title 47 CFR, Part 15, Class A (Commercial)
Minimum starting temp	-40°C (-40°F)	-40°C (-40°F)

UNIVERSAL VOLTAGE DRIVER WITH EMERGENCY OPTION (-UBR)

	120V	277V
Input Power	29.1W (+/-5%)	28.8W (+/-5%)
Input Current	0.27A	0.15A
Frequency	50/60Hz	50/60Hz
EMI/RFI	FCC Title 47 CFR, Part 15, Class A (Commercial)	FCC Title 47 CFR, Part 15, Class A (Commercial)
Minimum starting temp	0°C (32°F)	0°C (32°F)

LUTRON HI-LUME® LED DRIVER (-L)

	120V	277V
Input Power	27.0W (+/-5%)	27.0W (+/-5%)
Input Current	0.23A	0.10A
Frequency	50/60Hz	50/60Hz
EMI/RFI	FCC Title 47 CFR, Part 15, Class A (Commercial)	FCC Title 47 CFR, Part 15, Class A (Commercial)
Minimum starting temp	0°C (32°F)	0°C (32°F)

LUTRON HI-LUME® LED DRIVER WITH EMERGENCY OPTION (-LBR)

	120V	277V
Input Power	29.7W (+/-5%)	29.7W (+/-5%)
Input Current	0.27A	0.15A
Frequency	50/60Hz	50/60Hz
EMI/RFI	FCC Title 47 CFR, Part 15, Class A (Commercial)	FCC Title 47 CFR, Part 15, Class A (Commercial)
Minimum starting temp	0°C (32°F)	0°C (32°F)

6" TC 2000 LUMEN LED DOWNLIGHT NEW CONSTRUCTION

TC2022LED4 RECESSED HOUSING

WALL WASH TRIMS

ORDERING INFORMATION: Housing, trim and accessories each ordered separately.
Example: **TC2022LED4-27K-UBR**

Catalog No.	Color Temp.	Voltage	Options
TC2022LED4	27K 2700K 3K 3000K 35K 3500K 41K 4100K	U Universal Voltage 120-277V (0-10V dimming) L Lutron Hi-Lume 3-wire Dimming Ecosystem® Compatible	BR¹ Emergency Battery Back-up w/Remote Switch CP Chicago Plenum Chicago Plenum is not available with emergency option ¹ Not ENERGY STAR® Qualified.

Example: **HB-26**

Accessories

Cat. #	Description
HB-1	Two 13 1/2" - 25" Real Nail® 3 bar hangers
HB-26	Two 26" C-channel bar hangers
HB-50	Two 50" C-channel bar hangers
LB-27	Two 27" linear bar hangers

Example: **262G3W-WH**

Trim/Description
262G3W-WH Scoop Wall Wash with White Baffle
262G3B-WH Scoop Wall Wash with Black Baffle

 Trim Size: 7 5/8" O.D.
 Trim Finish: WH - White.

Note: In Canada when insulation is present, Type IC fixtures must be used.

PHOTOMETRIC REPORT

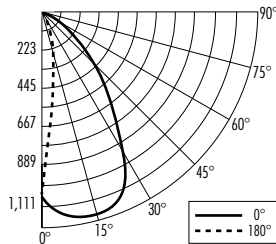
 Test Report#: PT08152806R
 Catalog No: TC2022LED4-35K-U
 with 262G3W-WH Wall Wash Trim
 Luminaire Spacing Criteria: 1.30
 Luminaire LPW: 52

CANDLEPOWER DISTRIBUTION (Candelas)

Degrees Vertical	0° Wall Wash	180° Downlight
0	1092	1092
5	1186	817
10	1222	418
15	1206	237
20	1150	171
25	1080	128
30	994	98
35	851	76
40	638	63
45	416	59
50	302	58
55	248	52
60	204	43
65	168	30
70	145	17
75	114	4
80	80	0
85	50	0
90	24	0

Multiplier: 27K - 0.93
3K - 0.97
41K - 1.02

ZONAL LUMEN SUMMARY

Zone	Lumens	%Lamp	%Fixture
0-30°	626	N/A	46.0
0-40°	922	N/A	67.90
0-60°	1213	N/A	89.20
0-90°	1359	N/A	100.0

LUMINANCE (Average cd/m²)

Degrees	Average 0° Luminance
45	34937
55	25737
65	23568
75	26268
85	34093

FOOTCANDLES ON WALL FROM MULTIPLE FIXTURES

Fixture Distance to Wall	2'						3'					
Fixture Centers (spacing)	2'			3'			3'			4'		
1'	41	40	41	32	24	32	17	16	17	14	11	14
2'	58	57	58	44	35	44	25	25	25	21	17	21
3'	72	73	72	53	46	53	28	27	28	23	20	23
4'	66	66	66	45	47	45	33	33	33	27	24	27
5'	51	52	51	36	36	36	34	34	34	26	26	26
6'	40	40	40	28	29	28	31	31	31	24	24	24
7'	31	32	31	23	23	23	27	27	27	21	21	21
8'	25	26	25	18	19	18	22	23	22	18	17	18
9'	19	20	19	15	15	15	18	19	18	14	14	14

*For 262G3B-WH trim, use 0.84 multiplier.

*Note: Multipliers are provided for estimating purposes only. Use IES photometric files for precise photometric information.