



Project: _____

Fixture Type: _____

Location: _____

Contact/Phone: _____

6" IC 600 LUMEN LED DOWNLIGHT NEW CONSTRUCTION

IC22LEDG3 RECESSED HOUSING

WALL WASH TRIM

PRODUCT DESCRIPTION

Dedicated LED, Air-Loc® sealed new construction housing with integral light engine • Shallow housing allows for fit in 2 x 6 construction • Can be completely covered with insulation • Fully sealed housing stops infiltration and exfiltration of air, reducing heating and air cooling costs without the use of additional gaskets • LED housing is designed to provide 50,000 hours of life and is compatible with many standard Juno trims • 5 year limited warranty on LED components.

ENVIRONMENTALLY FRIENDLY, ENERGY EFFICIENT

- No harmful ultraviolet or infrared wavelengths
- No lead or mercury
- Comparable light output to 65W BR30 incandescent while consuming less than 11W*



PRODUCT SPECIFICATIONS

LED Light Engine LED array integrated to one piece high purity aluminum, thermally conductive housing provides uninterrupted heat transfer to ensure long life of the LED • Replaceable light engine mounts directly to housing and incorporates the latest generation, high lumen output LED array • LEDs are binned to standards that exceed ENERGY STAR® requirements yielding superior fixture to fixture color uniformity • 2700K, 3000K, 3500K, or 4100K color temperatures available • 83 CRI typical.

Optical System Painted white scoop is designed to work with computer-optimized reflector design to direct light toward wall for uniform illumination on vertical surfaces while concealing LED optic assembly and minimizing glare. • LEDs are concealed by high transmission diffusing lens • Retention bar holds scoop assembly to trim • White or black baffle available.

Aesthetic Trim Selections Low profile scoop wall wash trim • Shadow free, knife edge design blends seamlessly into ceiling.

LED Driver Choice of dedicated 120 volt driver or universal voltage driver that accommodates input voltages from 120-277 volts AC at 50/60Hz • Power factor > 0.9 at 120V input • 120 volt only driver is dimmable with the use of most incandescent, magnetic low voltage and electronic low voltage wall box dimmers • Universal voltage driver is dimmable with the use of most 0-10V wall box dimmers • For a list of compatible dimmers, see [JUNOLEDG3-DIM](#) • Mounted between the j-box and housing for easy access and cool operation.

Life Rated for 50,000 hours at 70% lumen maintenance.

Labels UL listed for U.S. and Canada through-branch wiring, damp locations • Union made • UL and cUL.

Testing All reports are based on published industry procedures; field performance may differ from laboratory performance.

Product specifications subject to change without notice.

HOUSING FEATURES

Housing Designed for use in IC (insulated ceiling) or non-IC construction • Aluminum housing sealed for Air-Loc® compliance • Housing is vertically adjustable to accommodate up to a 2" ceiling thickness.

Junction Box Pre-wired junction box provided with (5) 1/2" and (1) 3/4" knockouts, (4) knockouts for 12/2 or 14/2 NM cable and ground wire • UL listed and cUL listed for through-branch wiring, maximum 8 #12 branch circuit conductors • Junction box provided with removable access plates • Knockouts equipped with pryout slots • Quick connect electrical connectors supplied as standard for fast, secure installation.

Mounting Frame 22-gauge die-formed galvanized steel mounting frame • Rough-in section (junction box, mounting frame, housing and bar hangers) fully assembled for ease of installation.

Real Nail 3 Bar Hangers Telescoping Real Nail 3® system permits quick placement of housing anywhere within 24" O.C. joists or suspended ceilings • Includes removable nail for repositioning of fixture in wood joist construction • Integral T-bar notch and clip for suspended ceilings • Design covered under Patents US5,505,419 and D552,969.

DIMENSIONS

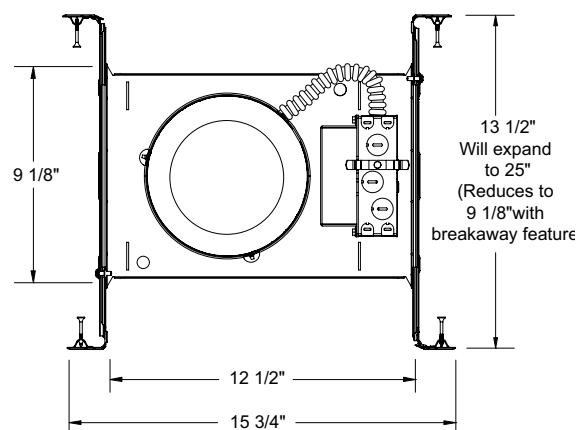
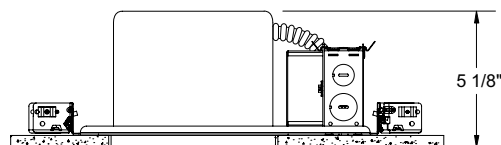

6 7/8" CEILING CUTOUT

ELECTRICAL DATA

Dedicated 120V Only Driver Option

120V	
Input Power	10.5W (+/-5%)
Input Current - Max	0.10A
Frequency	50/60Hz
EMI/RFI	FCC Title 47 CFR, Part 18, Class B (consumer)
Minimum starting temp	-20°C

ELECTRICAL DATA

Universal Voltage

	120V	277V
Input Power	12W (+/-5%)	12.3W (+/-5%)
Input Current - Max	0.11A	0.055A
Frequency	50/60Hz	50/60Hz
EMI/RFI	FCC Title 47 CFR, Part 15, Class A (non-consumer)	FCC Title 47 CFR, Part 15, Class A (non-consumer)
Minimum starting temp	-40°C	-40°C

* Nominal input wattage @ 120-volt operation with dedicated 120-volt driver under stable operating conditions.

6" IC 600 LUMEN LED DOWNLIGHT NEW CONSTRUCTION

IC22LEDG3 RECESSED HOUSING WALL WASH TRIM

ORDERING INFORMATION: Housing, trim and accessories each ordered separately.

Example: **IC22LEDG3-3K-1**

Housing	Color Temperature	Input Voltage
IC22LEDG3	27K 2700K 3K 3000K 35K 3500K 41K 4100K	1 Dedicated 120V Only (Forward Phase + ELV dimmable) U Universal Voltage, 120-277V (0-10V dimmable)

Example: **262G3W-WH**

Trim/Description
 262G3W-WH Scoop Wall Wash with White Baffle
262G3B-WH Scoop Wall Wash with Black Baffle

Trim Size: 7 5/8" O.D.
Trim Finish: WH - White.

Note: In Canada when insulation is present, Type IC fixtures must be used.

PHOTOMETRIC REPORT

Test Report #: PT10111901

Catalog No: IC22LEDG3-35K
with 262G3W-WH Trim

Luminaire Spacing Criterion @ 90°: 1.03

Luminaire: 6" IC LEDG3 Downlight,
Scoop Type Wall Wash Trim

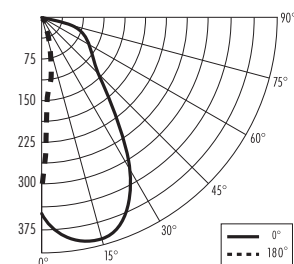

CANDLEPOWER DISTRIBUTION (Candelas)

Degrees	0°	180°
Vertical	Wall Wash	Downlight
0	319	319
5	358	221
10	368	123
15	369	79
20	360	60
25	344	46
30	315	36
35	265	27
40	196	22
45	136	20
50	102	20
55	83	18
60	71	15
65	63	11
70	58	6
75	45	0
80	29	0
85	17	0
90	0	0

Multiplier: 27K - 0.90, 3K - 0.97, 41K - 1.04

ZONAL LUMEN SUMMARY

Zone	Lumens	%Lamp	%Fixture
0 - 30°	193	N/A	44.5
0 - 40°	286	N/A	66.0
0 - 60°	381	N/A	87.9
0 - 90°	433	N/A	100.0
90 - 180°	0	N/A	0
0 - 180°	433	N/A	100.0

LUMINANCE (Average cd/m²)

Degrees	Average 180° Downlight Luminance
45	1569
55	1728
65	1393
75	0
85	0

FOOTCANDLES ON WALL FROM MULTIPLE FIXTURES

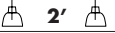
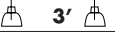
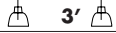
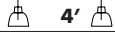
Fixture Distance to Wall		2'			3'		
Fixture Centers (spacing)							
DISTANCE FROM CEILING	1'	17 16 17	14 8 14		7 6 7	6 4 6	
	2'	19 18 19	15 10 15		8 7 8	6 5 6	
	3'	20 20 20	15 12 15		9 8 9	7 5 7	
	4'	17 17 17	11 11 11		9 9 9	7 6 7	
	5'	12 12 12	8 8 8		9 9 9	7 7 7	
	6'	9 9 9	6 6 6		8 8 8	6 6 6	
	7'	7 7 7	5 5 5		6 6 6	5 5 5	
	8'	6 6 6	4 4 4		5 5 5	4 4 4	
	9'	4 5 4	3 3 3		4 4 4	3 3 3	

*For 262G3B-WH trim, use 0.90 multiplier.

*Note: Multipliers are provided for estimating purposes only. Use IES photometric files for precise photometric information.



1300 S. Wolf Road • Des Plaines, IL 60018 • Phone (847) 827-9880 • Fax (847) 827-2925
220 Chrysler Drive • Brampton, Ontario • Canada L6S 6B6 • Phone (905) 792-7335 • Fax (905) 792-0064
Visit us at www.junolightinggroup.com

Printed in U.S.A. ©2011 Juno Lighting, LLC.