



Project: _____

Fixture Type: _____

Location: _____

Contact/Phone: _____

6" IC 600 LUMEN LED DOWNLIGHT NEW CONSTRUCTION

IC22LEDG3 RECESSED HOUSING

OPEN TRIMS



PRODUCT DESCRIPTION

Dedicated LED, Air-Loc® sealed new construction housing with integral light engine • Shallow housing allows for fit in 2 x 6 construction • Can be completely covered with insulation • Fully sealed housing stops infiltration and exfiltration of air, reducing heating and air cooling costs without the use of additional gaskets • LED housing is designed to provide 50,000 hours of life and is compatible with many standard Juno trims • 5 year limited warranty on LED components.

ENVIRONMENTALLY FRIENDLY, ENERGY EFFICIENT

- No harmful ultraviolet or infrared wavelengths
- No lead or mercury
- Comparable light output to 65W BR30 incandescent while consuming less than 11W*



PRODUCT SPECIFICATIONS

LED Light Engine LED array integrated to one piece high purity aluminum, thermally conductive housing provides uninterrupted heat transfer to ensure long life of the LED • Replaceable light engine mounts directly to housing and incorporates the latest generation, high lumen output LED array • LEDs are binned to standards that exceed ENERGY STAR® requirements yielding superior fixture to fixture color uniformity • 2700K, 3000K, 3500K or 4100K color temperature available • 83 CRI typical.

Optical System Computer-optimized reflector design with high reflectance white finish coupled with a high transmission diffusing lens conceals the LEDs and produces uniform aperture luminance • Deep regression of lens produces a low glare, efficient system that can produce over 600 lumens with select trims (see page 2 for details) using less than 11W* • Wide flood distribution shipped as standard with optional optic accessories available and sold separately.

Aesthetic Trim Selections Compatible with wide selection of existing Juno trims • Shadow free, knife edge design blends seamlessly into ceiling.

LED Driver Choice of dedicated 120 volt driver or universal voltage driver that accommodates input voltages from 120-277 volts AC at 50/60Hz • Power factor > 0.9 at 120V input • 120 volt only dimmable with the use of most incandescent, magnetic low voltage and electronic low voltage wall box dimmers • Universal voltage driver is dimmable with the use of most 0-10V wall dimmers • For a list of compatible dimmers, see [JUNOLEDG3-DIM](#) • Mounted between the j-box and housing for easy access and cool operation.

Life Rated for 50,000 hours at 70% lumen maintenance.

Labels ENERGY STAR® Qualified to luminaires V1.1 requirements when used with select baffle and cone trims • Certified to the high efficiency requirements of California T24-2008 with select trims • UL listed for U.S. and Canada through-branch wiring, damp locations • Union made • UL and cUL.

Testing All reports are based on published industry procedures; field performance may differ from laboratory performance.

Product specifications subject to change without notice.

HOUSING FEATURES

Housing Designed for use in IC (insulated ceiling) or non-IC construction • Aluminum housing sealed for Air-Loc® compliance • Housing is vertically adjustable to accommodate up to a 2" ceiling thickness.

Junction Box Pre-wired junction box provided with (5) ½" and (1) ¾" knockouts, (4) knockouts for 12/2 or 14/2 NM cable and ground wire • UL listed and cUL listed for through-branch wiring, maximum 8 #12 branch circuit conductors • Junction box provided with removable access plates • Knockouts equipped with pryout slots • Quick connect electrical connectors supplied as standard for fast, secure installation.

Mounting Frame 22-gauge die-formed galvanized steel mounting frame • Rough-in section (junction box, mounting frame, housing and bar hangers) fully assembled for ease of installation.

Real Nail 3 Bar Hangers Telescoping Real Nail 3® system permits quick placement of housing anywhere within 24" O.C. joists or suspended ceilings • Includes removable nail for repositioning of fixture in wood joist construction • Integral T-bar notch and clip for suspended ceilings • Design covered under Patents US5,505,419 and D552,969.

* Nominal input wattage @ 120-volt operation with dedicated 120-volt driver under stable operating conditions.

DIMENSIONS

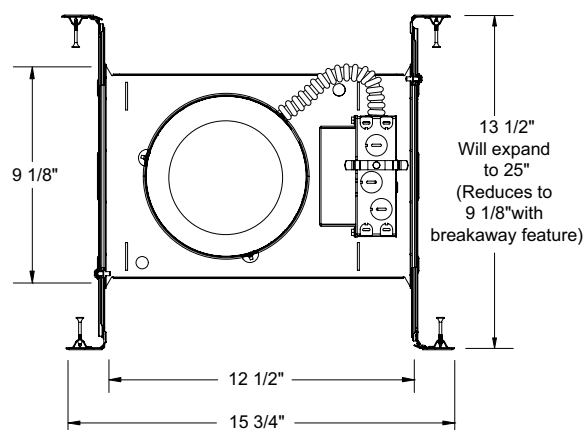
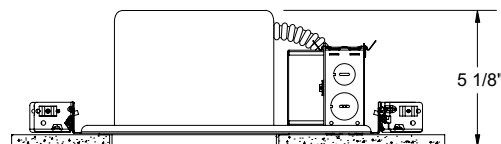

6 7/8" CEILING CUTOUT

ELECTRICAL DATA

Dedicated 120V Only Driver Option

120V	
Input Power	10.5W (+/-5%)
Input Current - Max	0.10A
Frequency	50/60Hz
EMI/RFI	FCC Title 47 CFR, Part 18, Class B (consumer)
Minimum starting temp	-20°C

ELECTRICAL DATA

Universal Voltage

	120V	277V
Input Power	12W (+/-5%)	12.3W (+/-5%)
Input Current - Max	0.11A	0.055A
Frequency	50/60Hz	50/60Hz
EMI/RFI	FCC Title 47 CFR, Part 15, Class A (non-consumer)	FCC Title 47 CFR, Part 15, Class A (non-consumer)
Minimum starting temp	-40°C	-40°C



JUNO LIGHTING GROUP
by Schneider Electric

6" IC 600 LUMEN LED DOWNLIGHT NEW CONSTRUCTION

IC22LEDG3 RECESSED HOUSING
OPEN TRIMS

ORDERING INFORMATION: Housing, trim and accessories each ordered separately.

Example: **IC22LEDG3-3K-1**





Housing	Color Temperature	Input Voltage
IC22LEDG3	27K 2700K 3K 3000K 35K 3500K 41K 4100K	1 Dedicated 120V Only (Forward Phase + ELV dimmable) U Universal Voltage, 120-277V (0-10V dimmable)

ACCESSORIES

Catalog No.	Description
LEDOPTICG3-M	Medium Flood Optic (50°)
LEDOPTICG3-N	Narrow Flood Optic (37°)
LEDOPTICG3-S	Spot Optic (10°)

To order, specify catalog number.

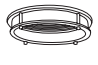
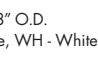
Example: **24W-WH**

Trim/Description	
	24W-WH Conical White Baffle 24B-WH^{1,2} Conical Black Baffle 24B-SC^{1,2} Conical Black Baffle 24B-ABZ^{1,2} Conical Black Baffle 24B-BL^{1,2} Conical Black Baffle
	27C-WH Conical Cone in Clear Alzak® 27G-WH Conical Cone in Gold Alzak® 27B-WH^{1,2} Conical Cone in Black Alzak® 27PT-SC Conical Cone in Pewter Alzak® 27W-WH Conical Cone in Gloss White 27HZ-WH Conical Cone in Haze 27WHZ-WH Conical Cone in Wheat Haze 27WHZ-ABZ Conical Cone in Wheat Haze
	9024W-WH White Octagonal w/ White Baffle
	9324-SC Luminous Disc (Frosted)
	9524-SC Chrome Band
	9702 Luminous Collar (Frosted)

Trim Size: 24, 27, 9324, 9524 - 7 $\frac{5}{8}$ " O.D.; 9702 - 7 $\frac{3}{4}$ " O.D.; 9024 - 8" O.D.
Trim Finish: ABZ - Classic Aged Bronze, BL - Black, SC - Satin Chrome, WH - White.
Alzak is a registered trademark of Alcoa Corp.
Note: In Canada when insulation is present, Type IC fixtures must be used.

¹ Not ENERGY STAR rated

² Universal Voltage:
T24 @ 35K, 41K only

PHOTOMETRIC REPORT

Test Report #: LTL25974R
Catalog No: IC22LEDG3-35K
with 24W-WH Trim
and standard wide flood optic
Luminaire Spacing Criterion: 1.16
Luminaire LPW: 64

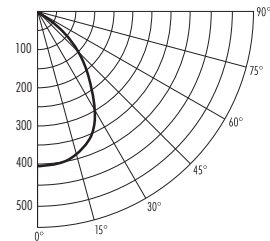

CANDLEPOWER DISTRIBUTION (Candelas)

Degrees Vertical	0°
0	404
5	401
15	379
25	337
35	261
45	139
55	61
65	28
75	16
85	4
90	0

Multiplier: 27K - 0.90
3K - 0.97
41K - 1.04

AVERAGE INITIAL FOOTCANDLES

Multiple Units (Square Array, 60'x60' room)

Ceiling 80% Wall 50% Floor 20%

Spacing	RCR1	RCR3	RCR5
4.0'	46	39	33
5.0'	30	25	21
6.0'	21	17	15
7.0'	17	14	12
8.0'	13	11	9
9.0'	10	8	7
10.0'	7	6	5

ZONAL LUMEN SUMMARY

Zone	Lumens	%Lamp	%Fixture
0-30°	300	N/A	44.4
0-40°	461	N/A	68.2
0-60°	625	N/A	92.5
0-90°	675	N/A	100.0

INITIAL FOOTCANDLES

(One Unit, 10.6W, 79.8° Beam)

Distance to Illuminated Plane (Feet)	Footcandles Beam Center	Beam Diameter
4	25.3	6.7'
6	11.2	10.0'
8	6.3	13.4'
10	4.0	16.7'

LUMINANCE (Average cd/m²)

Degrees	Average Luminance
45	11731
55	6304
65	4019
75	3756
85	2961

PHOTOMETRIC REPORT

Test Report #: LTL25975R
Catalog No: IC22LEDG3-35K
with 27C-WH Trim
and standard wide flood optic
Luminaire Spacing Criterion: 0.78
Luminaire LPW: 69

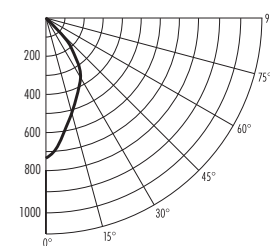

CANDLEPOWER DISTRIBUTION (Candelas)

Degrees Vertical	0°
0	718
5	674
15	512
25	401
35	286
45	137
55	43
65	9
75	0
85	0
90	0

Multiplier: 27K - 0.90
3K - 0.97
41K - 1.04

AVERAGE INITIAL FOOTCANDLES

Multiple Units (Square Array, 60'x60' room)

Ceiling 80% Wall 50% Floor 20%

Spacing	RCR1	RCR3	RCR5
4.0'	50	42	36
5.0'	32	27	23
6.0'	22	18	16
7.0'	18	15	13
8.0'	14	12	10
9.0'	11	9	8
10.0'	8	7	6

ZONAL LUMEN SUMMARY

Zone	Lumens	%Lamp	%Fixture
0-30°	390	N/A	53.9
0-40°	566	N/A	78.3
0-60°	713	N/A	98.7
0-90°	723	N/A	100.0

INITIAL FOOTCANDLES

(One Unit, 10.6W, 58.1° Beam)

Distance to Illuminated Plane (Feet)	Footcandles Beam Center	Beam Diameter
4	44.9	4.4'
6	19.9	6.7'
8	11.2	8.9'
10	7.2	11.1'

LUMINANCE (Average cd/m²)

Degrees	Average Luminance
45	11550
55	4510
65	1250
75	0
85	0

Fixtures tested to IES recommended standard for solid state lighting per LM-79-08. Photometric performance on a single unit represents a baseline of performance for the fixture. Results may vary in the field.



1300 S. Wolf Road • Des Plaines, IL 60018 • Phone (847) 827-9880 • Fax (847) 827-2925
220 Chrysler Drive • Brampton, Ontario • Canada L6S 6B6 • Phone (905) 792-7335 • Fax (905) 792-0064
Visit us at www.junolightinggroup.com

Printed in U.S.A. ©2011 Juno Lighting, LLC.