



Project: _____

Fixture Type: _____

Location: _____

Contact/Phone: _____

5" IC 600 LUMEN WARMDIM® LED DOWNLIGHT REMODEL

IC20RLWDG4N RECESSED HOUSING

**OPEN TRIMS**

PRODUCT DESCRIPTION

Dedicated LED, Air-Loc® remodel housing with integral patented WarmDim® technology • LED color temperature warms while dimming to emulate the dimming performance of traditional incandescent light sources • Shallow housing allows for fit in 2 x 6 construction • IC remodel housing for remodel application where back side of ceiling is not accessible • Installs through an opening in the ceiling from below • Secured in place by factory installed remodel springs • Can be completely covered with insulation • When used with supplied ALG kit, stops infiltration and exfiltration of air, reducing heating and air cooling costs • LED housing is designed to provide 50,000 hours of life and is compatible with many standard Juno trims • 5 year limited warranty on LED components.

ENVIRONMENTALLY FRIENDLY, ENERGY EFFICIENT

- No harmful ultraviolet or infrared wavelengths
- No lead or mercury
- Comparable light output to 65W BR30 incandescent while consuming 12W

PRODUCT SPECIFICATIONS

LED Light Engine Proprietary patented micro processor controlled light engine emulates dimming performance of incandescent light source • Replaceable light engine integrated to thermally conductive housing provides uninterrupted heat transfer to ensure long life of the LEDs • 3000K color temperature at full lumen output • 90 CRI minimum throughout dimming range • Design covered under Patent US 8,710,754.

Optical System Computer-optimized reflector design with high reflectance white finish coupled with a high transmission diffusing lens conceals the LEDs and produces uniform aperture luminance • Deep regression of lens produces a low glare, efficient system that can produce over 600 lumens with select trims (see page 2 for details) using 12W • Wide flood distribution shipped as standard with optional optic accessory available and sold separately.

Aesthetic Trim Selections Compatible with wide selection of existing Juno trims • Shadow free, knife edge design blends seamlessly into ceiling.

LED Driver Dedicated 120 volt driver • Power factor > 0.9 • Dimmable with the use of most incandescent, magnetic low voltage and electronic low voltage wall box dimmers • For a list of compatible dimmers, see [JUNOICLED-DIM](#) • Mounted between the j-box and housing for easy access and cool operation.

Life Rated for 50,000 hours at 70% lumen maintenance.

Labels ENERGY STAR® Qualified when used with select trims • Certified to the high efficacy requirements of California T24 with select trims • UL listed for U.S. and Canada, damp locations • Union made • UL and cUL.

Testing All reports are based on published industry procedures; field performance may differ from laboratory performance.

Product specifications subject to change without notice.

HOUSING FEATURES

Housing Designed for use in IC (insulated ceiling) or non-IC construction • Aluminum housing sealed for Air-Loc® compliance when used with ALG kit • Remodel springs accommodate up to 1 1/8" ceiling thickness.

Junction Box Pre-wired junction box provided with (5) 1/2" knockouts, (4) knockouts for 12/2 or 14/2 NM cable and ground wire • Knockouts equipped with pryout slots • Quick connect electrical connectors supplied as standard for fast, secure installation.



DIMENSIONS

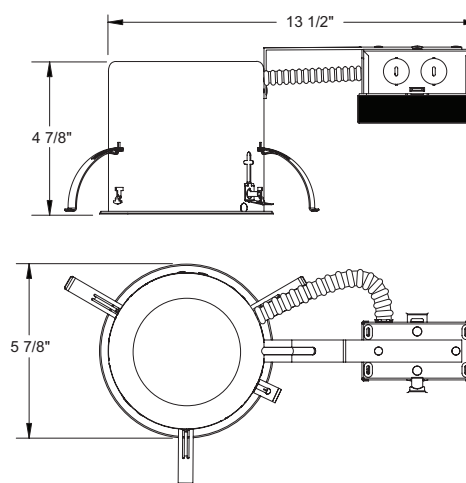

5 1/2" CEILING CUTOUT

ELECTRICAL DATA

Dedicated 120V Only Driver

120V	
Input Power	12W (+/- 5%)
Input Current	0.1A
Frequency	50/60 Hz
EMI/RFI	FCC Title 47 CFR, Part 15 Class B (residential)
Minimum starting temp	-20°C

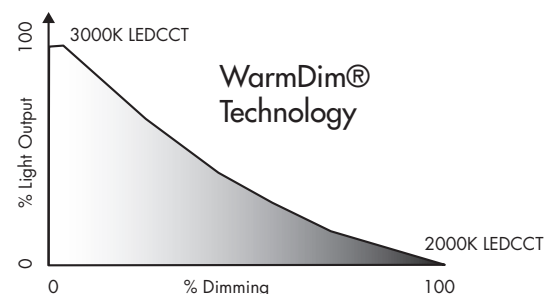

5" IC 600 LUMEN WARMDIM® LED DOWNLIGHT REMODEL

IC20RLWDG4N RECESSED HOUSING

OPEN TRIMS

ORDERING INFORMATION: Housing, trim and accessories each ordered separately.

Example: **IC20RLWDG4N-3K-1**



Housing	Color Temperature	Input Voltage
IC20RLWDG4N	3K 3000K	1 Dedicated 120V Only (Forward Phase + ELV dimmable)

ACCESSORIES

Catalog No.	Description
LEDOPTICG3-M	Medium Flood Optic (50°)

To order, specify catalog number.

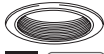
Example: **205W-WH**

Trim/Description
 205W-WH White Baffle 205B-WH¹ Black Baffle 205B-SC¹ Black Baffle 205B-ABZ¹ Black Baffle
 204C-WH Cone in Clear Alzak® 204G-WH Cone in Gold Alzak® 204B-WH¹ Cone in Black Alzak® 204PT-SC Cone in Pewter Alzak® 204W-WH Cone in Gloss White 204HZ-WH Cone in Haze 204WHZ-WH Cone in Wheat Haze 204WHZ-ABZ Cone in Wheat Haze

¹ Not ENERGY STAR® Qualified.

Trim Size: 6 1/4" O.D.

Trim Finish: ABZ - Classic Aged Bronze, SC - Satin Chrome, WH - White.

Alzak is a registered trademark of Alcoa Corp.

Note: In Canada when insulation is present, Type IC fixtures must be used.

PHOTOMETRIC REPORT

Test Report #: PT09141101
Catalog No: IC20LWDG4N-3K-1
with 205W-WH Trim
and standard wide flood optic

Luminaire Spacing Criterion: 1.12

Luminaire LPW: 51

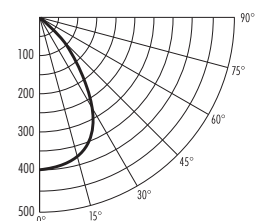

CANDLEPOWER DISTRIBUTION (Candelas)

Degrees Vertical	0°
0	402
5	400
15	384
25	334
35	227
45	102
55	54
65	31
75	18
85	4
90	0

AVERAGE INITIAL FOOTCANDLES

Multiple Units (Square Array, 60"x60" room)

Ceiling 80% Wall 50% Floor 20%

Spacing	RCR1	RCR3	RCR5
4.0'	42	34	29
5.0'	27	22	18
6.0'	19	15	13
7.0'	15	12	10
8.0'	12	10	8
9.0'	9	7	6
10.0'	7	5	5

ZONAL LUMEN SUMMARY

Zone	Lumens	%Lamp	%Fixture
0-30°	298	N/A	47.9
0-40°	438	N/A	70.3
0-60°	569	N/A	91.3
0-90°	623	N/A	100.0

INITIAL FOOTCANDLES

(One Unit, 12.1W, 73.4° Beam)

Distance to Illuminated Plane (Feet)	Footcandles Beam Center	Beam Diameter
4	25.1	6.0'
6	11.2	8.9'
8	6.3	11.9'
10	4.0	14.9'

LUMINANCE (Average cd/m²)

Degrees	Average Luminance
45	13638
55	8993
65	6866
75	6631
85	4025

PHOTOMETRIC REPORT

Test Report #: PT09141104
Catalog No: IC20LWDG4N-3K-1
with 204HZ-WH Trim
and standard wide flood optic

Luminaire Spacing Criterion: 1.20

Luminaire LPW: 56

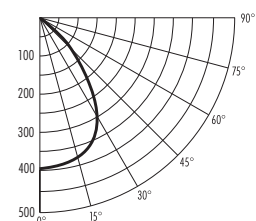

CANDLEPOWER DISTRIBUTION (Candelas)

Degrees Vertical	0°
0	386
5	386
15	381
25	346
35	252
45	125
55	69
65	37
75	15
85	0
90	0

AVERAGE INITIAL FOOTCANDLES

Multiple Units (Square Array, 60"x60" room)

Ceiling 80% Wall 50% Floor 20%

Spacing	RCR1	RCR3	RCR5
4.0'	45	37	31
5.0'	29	24	20
6.0'	20	16	14
7.0'	16	13	11
8.0'	13	11	9
9.0'	10	8	7
10.0'	7	6	5

ZONAL LUMEN SUMMARY

Zone	Lumens	%Lamp	%Fixture
0-30°	302	N/A	44.9
0-40°	457	N/A	68.0
0-60°	618	N/A	91.9
0-90°	672	N/A	100.0

INITIAL FOOTCANDLES

(One Unit, 12.1W, 78.2° Beam)

Distance to Illuminated Plane (Feet)	Footcandles Beam Center	Beam Diameter
4	24.1	6.5'
6	10.7	9.8'
8	6.0	13.0'
10	3.9	16.3'

LUMINANCE (Average cd/m²)

Degrees	Average Luminance
45	16722
55	11390
65	8324
75	5422
85	435

Fixtures tested to IES recommended standard for solid state lighting per LM-79-08. Photometric performance on a single unit represents a baseline of performance for the fixture. Results may vary in the field.



1300 S. Wolf Road • Des Plaines, IL 60018 • Phone (847) 827-9880 • Fax (847) 827-2925
220 Chrysler Drive • Brampton, Ontario • Canada L6S 6B6 • Phone (905) 792-7335 • Fax (905) 792-0064
Visit us at www.junolightinggroup.com

Printed in U.S.A. ©2014 Juno Lighting, LLC.