



Project: _____

Fixture Type: _____

Location: _____

Contact/Phone: _____

5" IC 600 LUMEN WARMDIM® LED DOWNLIGHT REMODEL

IC20RLWDG4N RECESSED HOUSING



LENSED TRIMS

PRODUCT DESCRIPTION

Dedicated LED, Air-Loc® remodel housing with integral patented WarmDim® technology • LED color temperature warms while dimming to emulate the dimming performance of traditional incandescent light sources • Shallow housing allows for fit in 2 x 6 construction • IC remodel housing for remodel application where back side of ceiling is not accessible • Installs through an opening in the ceiling from below • Secured in place by factory installed remodel springs • Can be completely covered with insulation • When used with supplied ALG kit, stops infiltration and exfiltration of air, reducing heating and air cooling costs • LED housing is designed to provide 50,000 hours of life and is compatible with many standard Juno trims • 5 year limited warranty on LED components.

ENVIRONMENTALLY FRIENDLY, ENERGY EFFICIENT

- No harmful ultraviolet or infrared wavelengths
- No lead or mercury
- Comparable light output to 65W BR30 incandescent while consuming 12W

PRODUCT SPECIFICATIONS

LED Light Engine Proprietary patented micro processor controlled light engine emulates dimming performance of incandescent light source • Replaceable light engine integrated to thermally conductive housing provides uninterrupted heat transfer to ensure long life of the LEDs • 3000K color temperature at full lumen output • 90 CRI minimum throughout dimming range • Design covered under Patent US 8,710,754.

Optical System Computer-optimized reflector design with high reflectance white finish coupled with a high transmission diffusing lens conceals the LEDs and produces uniform aperture luminance • Wide flood distribution shipped as standard with optional optic accessory available and sold separately.

Aesthetic Trim Selections Compatible with wide selection of existing Juno trims • Shadow free, knife edge design blends seamlessly into ceiling • Trims are wet location approved for covered applications.

LED Driver Dedicated 120 volt driver • Power factor > 0.9 • Dimmable with the use of most incandescent, magnetic low voltage and electronic low voltage wall box dimmers • For a list of compatible dimmers, see [JUNOICLED-DIM](#) • Mounted between the j-box and housing for easy access and cool operation.

Life Rated for 50,000 hours at 70% lumen maintenance.

Labels UL listed for U.S. and Canada, wet locations (covered ceilings) • Union made • UL and cUL.

Testing All reports are based on published industry procedures; field performance may differ from laboratory performance.

Product specifications subject to change without notice.

HOUSING FEATURES

Housing Designed for use in IC (insulated ceiling) or non-IC construction • Aluminum housing sealed for Air-Loc® compliance when used with ALG kit • Remodel springs accommodate up to 1 1/8" ceiling thickness.

Junction Box Pre-wired junction box provided with (5) 1/2" knockouts, (4) knockouts for 12/2 or 14/2 NM cable and ground wire • Knockouts equipped with pryout slots • Quick connect electrical connectors supplied as standard for fast, secure installation.



DIMENSIONS

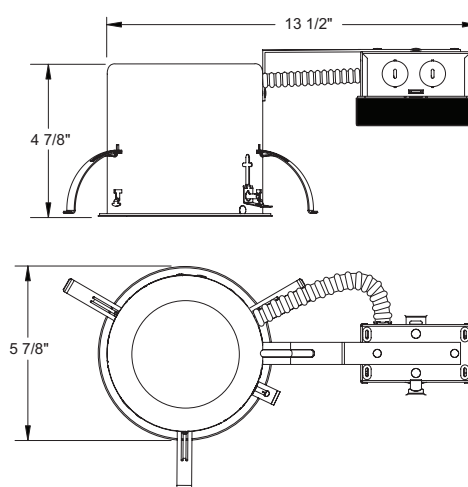

5 1/2" CEILING CUTOUT

ELECTRICAL DATA

Dedicated 120V Only Driver 120V

Input Power	12W (+/- 5%)
Input Current	0.1A
Frequency	50/60 Hz
EMI/RFI	FCC Title 47 CFR, Part 15 Class B (residential)
Minimum starting temp	-20°C

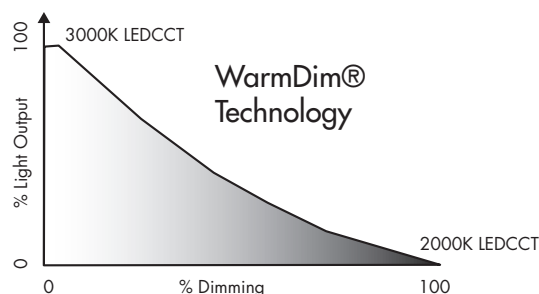

5" IC 600 LUMEN WARMDIM® LED DOWNLIGHT REMODEL

IC20RLWDG4N RECESSED HOUSING LENSED TRIMS

ORDERING INFORMATION: Housing, trim and accessories each ordered separately.

Example: **IC20RLWDG4N-3K-1**





Housing	Color Temperature	Input Voltage
IC20RLWDG4N	3K 3000K	1 Dedicated 120V Only (Forward Phase + ELV dimmable)

ACCESSORIES

Catalog No.	Description
LEDOPTICG3-M	Medium Flood Optic (50°)

To order, specify catalog number.

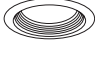
Example: **2130W-WH**

Trim/Description	
	210N-WH * 210N-SC * 210N-ABZ * Flat Glass Shower Trim
	212N-WH * 212N-SC * 212N-ABZ * Frosted Lens with Clear Center
	2130W-WH * 2130B-WH * White Baffle Regressed Frosted Dome Lens with Reflector Black Baffle Regressed Frosted Dome Lens with Reflector
	5101-ABZ * 5101-SC * 5101-WH * Beveled Frame - Frosted Dome Lens with Reflector

UL Listed for use in wet location.

* Do not use reflector shipped with trim for LED housing.

Trim Size: 210, 212, 2130 - 6 1/4" O.D.; 5101 - 6 1/2" O.D.

Trim Finish: ABZ - Classic Aged Bronze, SC - Satin Chrome, WH - White

Note: In Canada when insulation is present, Type IC fixtures must be used.

JUNO IC housings meet IECC Energy Code requirements per ASTM E283.

 Air-Loc® rated trims are pre-gasketed for minimum air leakage with IC housings.

PHOTOMETRIC REPORT

Test Report #: PT09141105

Catalog No: IC20LWDG4N-3K

with 210N-WH Trim and
Standard Wide Flood Optic

Luminaire Spacing Criterion: 0.98

Luminaire LPW: 38

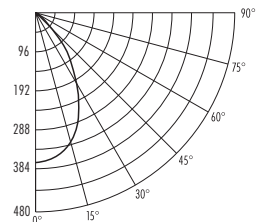

CANDLEPOWER DISTRIBUTION (Candelas)

Degrees Vertical	0°
0	358
5	354
15	326
25	256
35	146
45	70
55	37
65	21
75	10
85	3
90	0

AVERAGE INITIAL FOOTCANDLES

Multiple Units (Square Array, 60'x60' room)

Ceiling 80% Wall 50% Floor 20%

Spacing	RCR1	RCR3	RCR5
4.0'	31	26	22
5.0'	20	16	14
6.0'	14	11	10
7.0'	11	9	8
8.0'	9	7	6
9.0'	7	6	5
10.0'	5	4	3

ZONAL LUMEN SUMMARY

Zone	Lumens	%Lamp	%Fixture
0-30°	241	N/A	52.7
0-40°	333	N/A	72.9
0-60°	422	N/A	92.4
0-90°	456	N/A	100.0

INITIAL FOOTCANDLES

(One Unit, 12.1W, 64.1° Beam)

Distance to Illuminated Plane (Feet)	Footcandles Beam Center	Beam Diameter
4	22.4	5.0'
6	9.9	7.5'
8	5.6	10.0'
10	3.6	12.5'

LUMINANCE (Average cd/m²)

Degrees	Average Luminance
45	12465
55	8154
65	6188
75	5004
85	3751

Fixtures tested to IES recommended standard for solid state lighting per LM-79-08. Photometric performance on a single unit represents a baseline of performance for the fixture. Results may vary in the field.



1300 S. Wolf Road • Des Plaines, IL 60018 • Phone (847) 827-9880 • Fax (847) 827-2925
220 Chrysler Drive • Brampton, Ontario • Canada L6S 6B6 • Phone (905) 792-7335 • Fax (905) 792-0064
Visit us at www.junolightinggroup.com

Printed in U.S.A. ©2015 Juno Lighting, LLC.