

JUNO®

Project: _____

Fixture Type: _____

Location: _____

Contact/Phone: _____

5" IC 600 LUMEN LED DOWNLIGHT NEW CONSTRUCTION

IC20LEDG4 RECESSED HOUSING WALL WASH TRIM



PRODUCT DESCRIPTION

Dedicated LED, Air-Loc® sealed new construction housing with integral light engine • Shallow housing allows for fit in 2 x 6 construction • Can be completely covered with insulation • Fully sealed housing stops infiltration and exfiltration of air, reducing heating and air cooling costs without the use of additional gaskets • LED housing is designed to provide 50,000 hours of life and is compatible with many standard Juno trims • 5 year limited warranty on LED components.

ENVIRONMENTALLY FRIENDLY, ENERGY EFFICIENT

- No harmful ultraviolet or infrared wavelengths
- No lead or mercury
- Comparable light output to 65W BR30 incandescent

PRODUCT SPECIFICATIONS

LED Light Engine LED array integrated to thermally conductive housing provides uninterrupted heat transfer to ensure long life of the LED

- Replaceable light engine mounts directly to housing and incorporates the latest generation, high lumen output LED array • LEDs are binned within a 3-step MacAdam Ellipse exceeding ENERGY STAR® requirements for superior fixture to fixture color uniformity • 2700K, 3000K, 3500K, or 4100K color temperatures available • 90 CRI minimum.

Optical System Painted white scoop is designed to work with computer-optimized reflector design to direct light toward wall for uniform illumination on vertical surfaces while concealing LED optic assembly and minimizing glare • LEDs are concealed by high transmission diffusing lens • Retention bar holds scoop assembly to trim • White or black baffle available.

Aesthetic Trim Selections Low profile scoop wall wash trim • Shadow free, knife edge design blends seamlessly into ceiling.

LED Driver Choice of dedicated 120 volt driver or universal voltage driver that accommodates input voltages from 120-277 volts AC at 50/60Hz • Power factor > 0.9 at 120V input • 120 volt only driver is dimmable with the use of most incandescent, magnetic low voltage and electronic low voltage wall box dimmers • Universal voltage driver is dimmable with the use of most 0-10V wall box dimmers • For a list of compatible dimmers, see [JUNOICLED-DIM](#) • Mounted between the j-box and housing for easy access and cool operation.

Life Rated for 50,000 hours at 70% lumen maintenance.

Labels UL listed for U.S. and Canada through-branch wiring, damp locations • Union made • UL and cUL.

Testing All reports are based on published industry procedures; field performance may differ from laboratory performance.

Product specifications subject to change without notice.

HOUSING FEATURES

Housing Designed for use in IC (insulated ceiling) or non-IC construction • Aluminum housing sealed for Air-Loc® compliance • Housing is vertically adjustable to accommodate up to a 2" ceiling thickness.

Junction Box Pre-wired junction box provided with (5) 1/2" knockouts, (4) knockouts for 12/2 or 14/2 NM cable and ground wire • UL listed and cUL listed for through-branch wiring, maximum 8 #12 branch circuit conductors • Junction box provided with removable access plates • Knockouts equipped with pryout slots • Quick connect electrical connectors supplied as standard for fast, secure installation.

Mounting Frame 22-gauge die-formed galvanized steel mounting frame • Rough-in section (junction box, mounting frame, housing and bar hangers) fully assembled for ease of installation.

Real Nail 3 Bar Hangers Telescoping Real Nail 3® system permits quick placement of housing anywhere within 24" O.C. joists or suspended ceilings • Includes removable nail for repositioning of fixture in wood joist construction • Integral T-bar notch and clip for suspended ceilings • Design covered under Patents US5,505,419 and D552,969.

DIMENSIONS

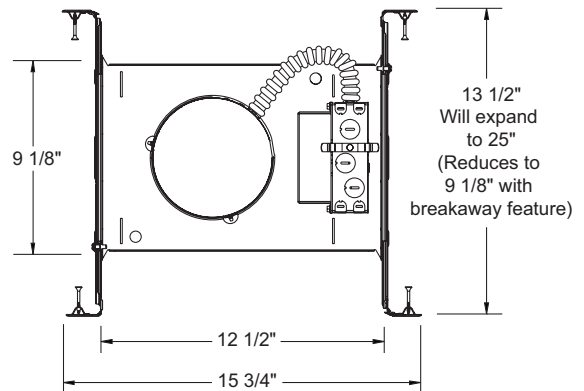
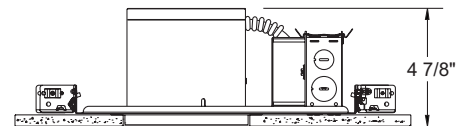

5 5/8" CEILING CUTOUT

ELECTRICAL DATA

Dedicated 120V Only Driver Option

120V	
Input Power	11.7W (+/-5%)
Input Current	0.10A
Frequency	50/60Hz
EMI/RFI	FCC Title 47 CFR, Part 15, Class B (residential)
Minimum starting temp	-25°C

ELECTRICAL DATA







Universal Voltage

	120V	277V
Input Power	12.5W (+/-5%)	12.6W (+/-5%)
Input Current	0.11A	0.05A
Frequency	50/60Hz	50/60Hz
EMI/RFI	FCC Title 47 CFR, Part 15, Class A (commercial)	FCC Title 47 CFR, Part 15, Class A (commercial)
Minimum starting temp	-40°C	-40°C

5" IC 600 LUMEN LED DOWNLIGHT NEW CONSTRUCTION

IC20LEDG4 RECESSED HOUSING WALL WASH TRIM

ORDERING INFORMATION: Housing and trim each ordered separately.

<p>Example: IC20LEDG4-3K-1</p> <table border="1" style="width: 100%; border-collapse: collapse;"> <thead> <tr> <th style="width: 25%;">Housing</th> <th style="width: 25%;">Color Temperature</th> <th style="width: 25%;">Input Voltage</th> <th style="width: 25%;"></th> </tr> </thead> <tbody> <tr> <td>IC20LEDG4</td> <td>27K 2700K 3K 3000K 35K 3500K 41K 4100K</td> <td> I Dedicated 120V Only (Forward Phase + ELV dimmable) U Universal Voltage, 120-277V (0-10V dimmable) </td> <td></td> </tr> </tbody> </table>	Housing	Color Temperature	Input Voltage		IC20LEDG4	27K 2700K 3K 3000K 35K 3500K 41K 4100K	I Dedicated 120V Only (Forward Phase + ELV dimmable) U Universal Voltage, 120-277V (0-10V dimmable)		<p>Example: 213G3W-WH</p> <table border="1" style="width: 100%; border-collapse: collapse;"> <thead> <tr> <th style="width: 50%;">Trim/Description</th> <th style="width: 50%;"></th> </tr> </thead> <tbody> <tr> <td style="text-align: center;"></td> <td>213G3W-WH Scoop Wall Wash with White Baffle</td> </tr> <tr> <td style="text-align: center;"></td> <td>213G3B-WH Scoop Wall Wash with Black Baffle</td> </tr> </tbody> </table> <p>Trim Size: 6 1/4" O.D. Trim Finish: WH - White.</p> <p>Note: In Canada, when insulation is present, Type IC fixtures must be used</p>	Trim/Description			213G3W-WH Scoop Wall Wash with White Baffle		213G3B-WH Scoop Wall Wash with Black Baffle
Housing	Color Temperature	Input Voltage													
IC20LEDG4	27K 2700K 3K 3000K 35K 3500K 41K 4100K	I Dedicated 120V Only (Forward Phase + ELV dimmable) U Universal Voltage, 120-277V (0-10V dimmable)													
Trim/Description															
	213G3W-WH Scoop Wall Wash with White Baffle														
	213G3B-WH Scoop Wall Wash with Black Baffle														

PHOTOMETRIC REPORT

Test Report #: PT10112405R
 Catalog No: IC20LEDG4-35K with 213G3W-WH Trim
 Luminaire Spacing Criterion @ 90°: 1.00
 Luminaire: 5" ICLEDG4 Downlight, Scoop Type Wall Wash Trim

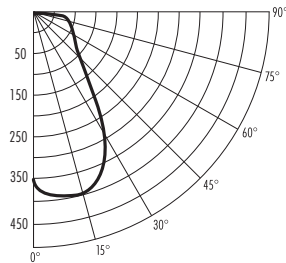

CANDLEPOWER DISTRIBUTION (Candelas)

Degrees Vertical	0°
0	354
5	389
10	396
15	392
20	372
25	338
30	287
35	215
40	147
45	110
50	89
55	75
60	67
65	60
70	53
75	39
80	24
85	14
90	0

Multiplier: 27K - 0.89
 3K - 0.94
 41K - 1.03

ZONAL LUMEN SUMMARY

Zone	Lumens	%Lamp	%Fixture
0-30°	205	N/A	47.6
0-40°	288	N/A	66.9
0-60°	380	N/A	88.3
0-90°	431	N/A	100.0

LUMINANCE (Average cd/m²)

Degrees	Average Luminance
45	12277
55	10523
65	11151
75	11819
85	12332

FOOTCANDLES ON WALL FROM MULTIPLE FIXTURES

Fixture Distance to Wall	2'			3'		
	2'	3'	4'	3'	4'	5'
1'	17 15 17	13 8 13		6 5 6	5 3 5	
2'	17 16 17	13 9 13		7 7 7	6 5 6	
3'	17 17 17	13 9 13		7 7 7	6 5 6	
4'	15 15 15	11 9 11		7 7 7	6 5 6	
5'	12 12 12	7 8 7		7 7 7	6 5 6	
6'	9 9 9	6 6 6		6 6 6	5 5 5	
7'	7 7 7	5 4 5		6 6 6	4 4 4	
8'	5 5 5	4 4 4		5 5 5	4 4 4	
9'	4 4 4	3 3 3		4 4 4	3 3 3	

*For 213G3B-WH trim, use 0.84 multiplier.
 *Note: Multipliers are provided for estimating purposes only. Use IES photometric files for precise photometric information.