

IC20 Series 5" Incandescent Housing

IC Rated

Junco

AIR-LOC

Features

- 5" Housing
- Drop socket with spring to accommodate various trim installations
- Medium base porcelain socket with nickel-plated copper screw shell
- Housing is vertically adjustable to accommodate up to a 1" ceiling thickness
- Real Nail® 3 bar hangers: telescoping system with pre-installed removable nail for easy repositioning of housing in joist construction • Integral T-bar mounting feature for secure installation in suspended ceilings
- Housing is fully assembled for ease of installation
- Pre-wired junction box with (5) 1/2" and (1) 3/4" knockouts with pryout slots, (4) non-metallic sheathed cable connectors, and ground wire
- Shadow-free, knife-edge trim design blends smoothly into the ceiling and allows architectural continuity with Aculux® trims
- UL Listed, C-UL/CSA certified for through-branch wiring, maximum (8) #12 AWG branch circuit conductors (4 in, 4 out)
- Thermally protected against improper use of lamps
- Lamp wattage ratings and apertures based on trim selection on pages 63-65

Ordering Information

Catalog Number: **IC20**

Catalog Number: **IC20W** - IC20 with push-in electrical connectors for fast, secure installation

Catalog Number: **IC20S** - IC20 with smaller footprint bar hanger (Real Nail® 2)

Catalog Number: **IC20N** - IC20 with no socket plate (use 208, 210, 215, 216 trims only)

Catalog Number: **IC20NW** - IC20 with push-in electrical connectors and no socket plate (use 208, 210, 215, 216 trims only)



Description

IC rated, energy efficient Air-Loc® sealed housing

- Can be completely covered with insulation • Air-Loc installation stops infiltration and exfiltration of air, reducing heating and cooling costs

Listings

UL Listed, C-UL/CSA certified for through-branch wiring, damp and wet locations • Wet location listed with the 210, 211, and 212 trims • The listing also includes the 215 and 216 trims, only when used with PAR30 outdoor rated lamps • Washington State IECC and MEC energy codes as tested per ASTM-E283 • Conforms with City of Chicago IP requirements

Accessories

Catalog Number	Description
ALG5	Air-Loc® Energy Conserving Gasket for 5" Air-Loc® IC housings

Dimensions

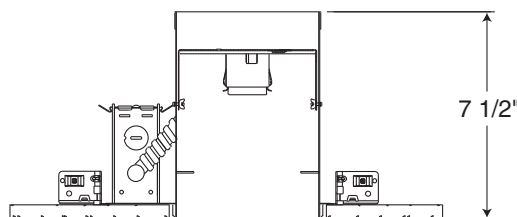
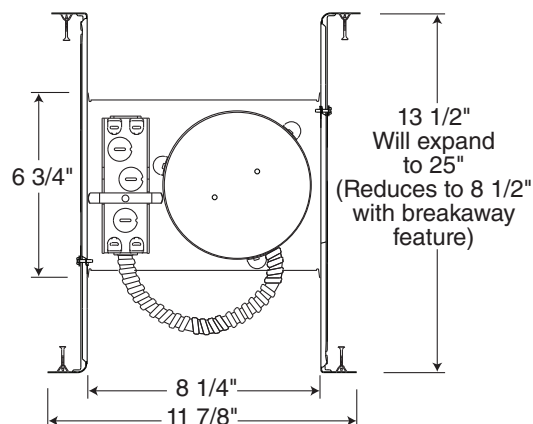

5 5/8" Ceiling Cutout



JUNCO LIGHTING GROUP
by Schneider Electric