



Project: _____

Fixture Type: _____

Location: _____

Contact/Phone: _____

4" IC 900 LUMEN WARMDIM® LED DOWNLIGHT NEW CONSTRUCTION

IC91LWDG4 RECESSED HOUSING

**WALL WASH TRIM**

PRODUCT DESCRIPTION

Dedicated LED, Air-Loc® sealed new construction housing with patented WarmDim® technology • LED color temperature warms while dimming to emulate the dimming performance of traditional incandescent light sources • Double wall, shallow housing construction allows for fit in 2 x 6 construction • Can be completely covered with insulation • Fully sealed housing stops infiltration and exfiltration of air, reducing heating and air cooling costs without the use of additional gaskets • LED housing is designed to provide 50,000 hours of life and is compatible with many standard Juno trims • 5 year limited warranty on LED components.

ENVIRONMENTALLY FRIENDLY, ENERGY EFFICIENT

- No harmful ultraviolet or infrared wavelengths
- No lead or mercury, RoHS compliant
- Comparable light output to 75W incandescent while consuming 15W

PRODUCT SPECIFICATIONS

LED Light Engine Proprietary patented (US Patent 8,710,754) micro processor controlled light engine emulates dimming performance of incandescent light source • Replaceable light engine attached to high purity aluminum, thermally conductive inner housing provides superior heat transfer to ensure long life of the LEDs • 3000K color temperature at full lumen output • 90 CRI minimum throughout dimming range.

Optical System Angle-cut aluminum reflector and specular clear kicker reflector directs light toward wall for uniform illumination on vertical surfaces while concealing LED optic assembly and minimizing glare • LEDs are concealed by high transmission diffusing lens.

Aesthetic Trim Selections Recessed lensed wall wash trim • Shadow free, knife edge design blends seamlessly into ceiling • Reflector finishes include clear, haze, wheat haze and white paint.

LED Driver Dedicated 120 volt driver • Power factor > 0.9 • Dimmable with the use of most incandescent, magnetic low voltage and electronic low voltage wall box dimmers • For a list of compatible dimmers, see [JUNOICLED-DIM](#) • Mounted inside housing for easy access from below ceiling.

Life Rated for 50,000 hours at 70% lumen maintenance.

Labels ENERGY STAR® Qualified when used with select trims • Certified to the high efficacy requirements of California T24 with select trims • UL listed for U.S. and Canada, through-branch wiring and damp locations • Union made • UL and cUL.

Testing All reports are based on published industry procedures; field performance may differ from laboratory performance.

Product specifications subject to change without notice.

HOUSING FEATURES

Housing Designed for use in IC (insulated ceiling) or non-IC construction • Aluminum housing sealed for Air-Loc® compliance • Housing is vertically adjustable to accommodate up to a 1 1/2" ceiling thickness.

Junction Box Pre-wired junction box provided with (6) 1/2" and (1) 3/4" knockouts, (4) knockouts for 12/2 or 14/2 NM cable and ground wire • UL listed and cUL listed for through-branch wiring, maximum 6 #12 branch circuit conductors • Junction box provided with removable access plates • Knockouts equipped with pryout slots • Quick connect electrical connectors supplied as standard for fast, secure installation.

Mounting Frame 22-gauge die-formed galvanized steel mounting frame • Rough-in section (junction box, mounting frame, housing and bar hangers) fully assembled for ease of installation.

Real Nail 3 Bar Hangers Patented (US Patent D552,969) Real Nail® 3 bar hangers: telescoping system permits quick placement of housing anywhere within 24" O.C. joists or suspended ceilings • Includes removable nail for repositioning of fixture in wood joist construction • Integral T-bar notch and clip for suspended ceilings.



DIMENSIONS

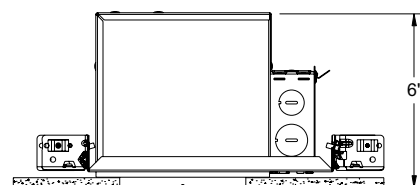
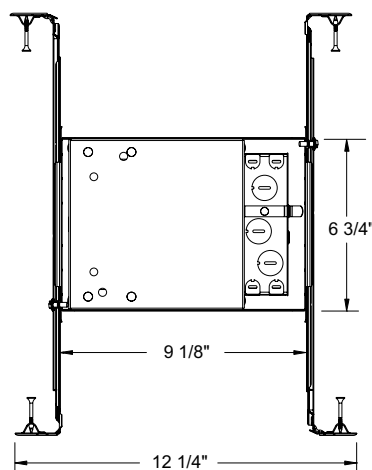

4 1/2" CEILING CUTOUT

ELECTRICAL DATA

Dedicated 120V Only Driver

120V	
Input Power	14.9W (+/- 5%)
Input Current	0.13A
Frequency	50/60 Hz
EMI/RFI	FCC Title 47 CFR, Part 15 Class B (residential)
Minimum starting temp	-20°C

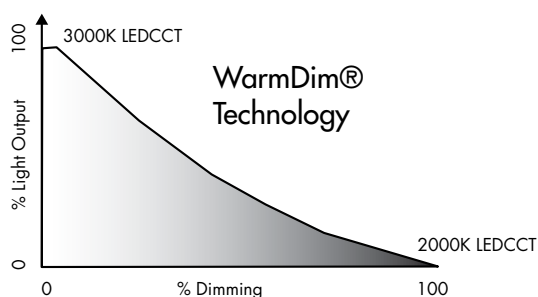

4" IC 900 LUMEN WARMDIM® LED DOWNLIGHT NEW CONSTRUCTION

IC91LWDG4 RECESSED HOUSING
WALL WASH TRIM

ORDERING INFORMATION: Housing and trim each ordered separately.

Example: **IC91LWDG4-3K-1**

Housing	Color Temperature	Input Voltage
IC91LWDG4	3K 3000K	1 Dedicated 120V Only (Forward Phase + ELV dimmable)

Example: **39C-WH**

Trim/Description	
	39C-WH Lensed Wall Wash - Clear Alzak® 39W-WH Lensed Wall Wash - Gloss White 39HZ-WH Lensed Wall Wash - Haze 39WHZ-WH Lensed Wall Wash - Wheat Haze
Trim Size: 5" O.D. Trim Finish: WH - White. Alzak is a registered trademark of Alcoa Corp. Note: In Canada when insulation is present, Type IC fixtures must be used.	

PHOTOMETRIC REPORT

Test Report #: PT11141801R

Catalog No: IC91LWDG4-3K-1

with 39C-WH Trim

Luminaire Spacing Criterion: 0.76

Luminaire LPW: 54

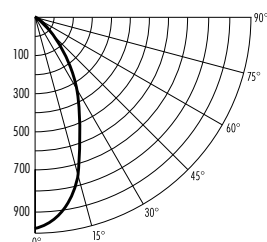

CANDLEPOWER DISTRIBUTION (Candelas)

Degrees Vertical	0°
0	974
5	959
15	748
25	478
35	241
45	91
55	40
65	21
75	8
85	0
90	0

ZONAL LUMEN SUMMARY

Zone	Lumens	%Lamp	%Fixture
0 - 30°	506	N/A	62.6
0 - 40°	665	N/A	82.3
0 - 60°	792	N/A	98.0
0 - 90°	808	N/A	100.0

LUMINANCE (Average cd/m²)

Degrees	Average Luminance
45	24193
55	13227
65	9445
75	5939
85	0

FOOTCANDLES ON WALL FROM MULTIPLE FIXTURES

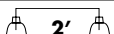
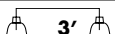
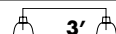
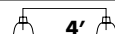
Fixture Distance to Wall		2'						3'					
Fixture Centers (spacing)													
DISTANCE FROM CEILING	1'	5	5	5	4	4	4	3	3	3	2	2	2
	2'	13	13	13	10	8	10	5	5	5	4	4	4
	3'	21	20	21	15	13	15	7	7	7	6	6	6
	4'	23	23	23	17	16	17	10	10	10	8	7	8
	5'	21	21	21	15	15	15	11	11	11	9	9	9
	6'	19	19	19	13	13	13	12	12	12	10	9	10
	7'	16	16	16	12	12	12	12	12	12	9	9	9
	8'	14	14	14	10	10	10	11	11	11	8	9	8
	9'	11	11	11	8	9	8	9	10	9	7	7	7

Fixtures tested to IES recommended standard for solid state lighting per LM-79-08. Photometric performance on a single unit represents a baseline of performance for the fixture. Results may vary in the field.