



Project: _____

Fixture Type: _____

Location: _____

Contact/Phone: _____

4" IC 900 LUMEN WARMDIM® LED DOWNLIGHT NEW CONSTRUCTION

IC91LWDG4 RECESSED HOUSING

LENSED TRIMS



PRODUCT DESCRIPTION

Dedicated LED, Air-Loc® sealed new construction housing with patented WarmDim® technology • LED color temperature warms while dimming to emulate the dimming performance of traditional incandescent light sources • Double wall, shallow housing construction allows for fit in 2 x 6 construction • Can be completely covered with insulation • Fully sealed housing stops infiltration and exfiltration of air, reducing heating and air cooling costs without the use of additional gaskets • LED housing is designed to provide 50,000 hours of life and is compatible with many standard Juno trims • 5 year limited warranty on LED components.

ENVIRONMENTALLY FRIENDLY, ENERGY EFFICIENT

- No harmful ultraviolet or infrared wavelengths
- No lead or mercury, RoHS compliant
- Comparable light output to 75W incandescent while consuming less than 15W

PRODUCT SPECIFICATIONS

LED Light Engine Proprietary patented (US Patent 8,710,754) micro processor controlled light engine emulates dimming performance of incandescent light source • Replaceable light engine attached to high purity aluminum, thermally conductive inner housing provides superior heat transfer to ensure long life of the LEDs • 3000K color temperature at full lumen output • 90 CRI minimum throughout dimming range.

Optical System Computer-optimized reflector design with high reflectance finish coupled with a high transmission diffusing lens conceals the LEDs and produces uniform aperture luminance.

Aesthetic Trim Selections Compatible with wide selection of existing Juno trims • Shadow free, knife edge design blends seamlessly into ceiling • Trims are wet location approved for covered ceiling applications.

LED Driver Dedicated 120 volt driver • Power factor > 0.9 • Dimmable with the use of most incandescent, magnetic low voltage and electronic low voltage wall box dimmers • For a list of compatible dimmers, see [JUNOICLED-DIM](#) • Mounted inside housing for easy access from below ceiling.

Life Rated for 50,000 hours at 70% lumen maintenance.

Labels ENERGY STAR® Qualified when used with select trims • Certified to the high efficacy requirements of California T24 with select trims • UL listed for U.S. and Canada through-branch wiring, damp locations • Union made • UL and cUL.

Testing All reports are based on published industry procedures; field performance may differ from laboratory performance.

Product specifications subject to change without notice.

HOUSING FEATURES

Housing Designed for use in IC (insulated ceiling) or non-IC construction • Aluminum housing sealed for Air-Loc® compliance • Housing is vertically adjustable to accommodate up to a 1 1/2" ceiling thickness.

Junction Box Pre-wired junction box provided with (6) 1/2" and (1) 3/4" knockouts, (4) knockouts for 12/2 or 14/2 NM cable and ground wire • UL listed and cUL listed for through-branch wiring, maximum 6 #12 branch circuit conductors • Junction box provided with removable access plates • Knockouts equipped with pryout slots • Quick connect electrical connectors supplied as standard for fast, secure installation.

Mounting Frame 22-gauge die-formed galvanized steel mounting frame • Rough-in section (junction box, mounting frame, housing and bar hangers) fully assembled for ease of installation.

Real Nail 3 Bar Hangers Patented (US Patent D552,969) Real Nail® 3 bar hangers: telescoping system permits quick placement of housing anywhere within 24" O.C. joists or suspended ceilings • Includes removable nail for repositioning of fixture in wood joist construction • Integral T-bar notch and clip for suspended ceilings.



DIMENSIONS

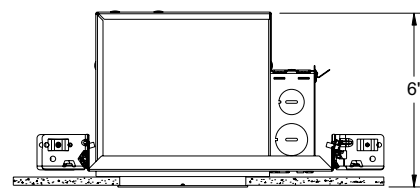
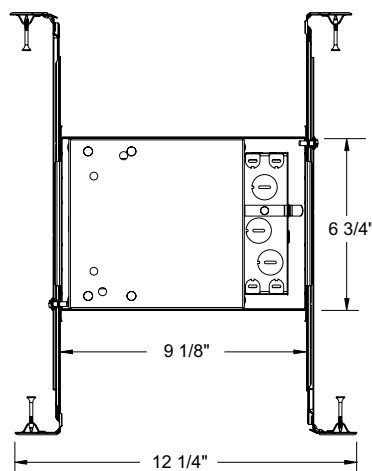

4 1/2" CEILING CUTOUT

ELECTRICAL DATA

Dedicated 120V Only Driver

120V

Input Power	14.9W (+/-5%)
Input Current	0.13A
Frequency	50/60 Hz
EMI/RFI	FCC Title 47 CFR, Part 15 Class B (residential)
Minimum starting temp	-20°C

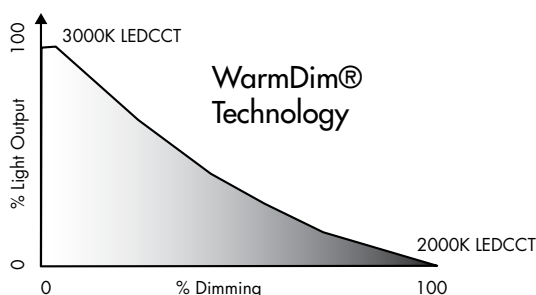

4" IC 900 LUMEN WARMDIM® LED DOWNLIGHT NEW CONSTRUCTION





IC91LWDG4 RECESSED HOUSING
LENSED TRIMS

ORDERING INFORMATION: Housing and trim each ordered separately.

Example: **IC91LWDG4-3K-1**

Housing	Color Temperature	Input Voltage
IC91LWDG4	3K 3000K	1 Dedicated 120V Only (Forward Phase + ELV dimmable)

Example: **12W-WH**

Trim/Description			
	11-WH	Drop Opal	
	12W-WH 12W-SC 12W-ABZ	Shower Trim, frosted perimeter lens	
	4101-ABZ 4101-SC 4101-WH	Beveled Dome - Shower	
	4102-ABZ 4102-SC 4102-WH	Beveled Shower	

UL Listed for use in wet location.

Trim Size: 5" O.D.

Trim Finish: ABZ - Classic Aged Bronze, SC - Satin Chrome, WH - White

Note: In Canada when insulation is present, Type IC fixtures must be used.

PHOTOMETRIC REPORT

Test Report #: PT09141904R

Catalog No: IC91LWDG4-3K
with 12W-WH Trim

Luminaire Spacing Criterion: 0.76

Luminaire LPW: 58

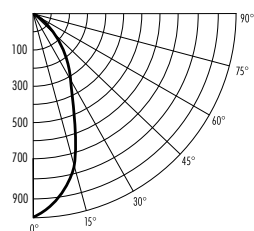

CANDLEPOWER DISTRIBUTION (Candelas)

Degrees Vertical	0°
0	975
5	961
15	775
25	453
35	225
45	117
55	67
65	38
75	17
85	2
90	0

AVERAGE INITIAL FOOTCANDLES

Multiple Units (Square Array, 60'x60' room)
Ceiling 80% Wall 50% Floor 20%

Spacing	RCR1	RCR3	RCR5
4.0'	59	49	42
5.0'	38	31	27
6.0'	26	22	19
7.0'	21	18	15
8.0'	17	14	12
9.0'	13	11	9
10.0'	9	8	7

ZONAL LUMEN SUMMARY

Zone	Lumens	%Lamp	%Fixture
0-30°	511	N/A	59.1
0-40°	654	N/A	75.6
0-60°	807	N/A	93.2
0-90°	865	N/A	100.0

INITIAL FOOTCANDLES (One Unit, 15W, 47.8° Beam)

Distance to Illuminated Plane (Feet)	Footcandles Beam Center	Beam Diameter
4	61.0	3.5'
6	27.1	5.3'
8	15.3	7.1'
10	9.8	8.9'

LUMINANCE (Average cd/m²)

Degrees	Average Luminance
45	26989
55	18884
65	14594
75	10628
85	2959

Fixtures tested to IES recommended standard for solid state lighting per LM-79-08. Photometric performance on a single unit represents a baseline of performance for the fixture. Results may vary in the field.



1300 S. Wolf Road • Des Plaines, IL 60018 • Phone (847) 827-9880 • Fax (847) 827-2925
220 Chrysler Drive • Brampton, Ontario • Canada L6S 6B6 • Phone (905) 792-7335 • Fax (905) 792-0064
Visit us at www.junolightinggroup.com

Printed in U.S.A. ©2015 Juno Lighting, LLC.