

# JUNO®

Project: \_\_\_\_\_

Fixture Type: \_\_\_\_\_

Location: \_\_\_\_\_

Contact/Phone: \_\_\_\_\_

## 4" IC 900 LUMEN LED DOWNLIGHT NEW CONSTRUCTION

IC91 LEDG4 RECESSED HOUSING

WALL WASH TRIMS



### PRODUCT DESCRIPTION

Dedicated LED, Air-Loc® sealed new construction housing with integral light engine • Double wall, shallow housing construction allows for fit in 2 x 6 construction • Can be completely covered with insulation • Fully sealed housing stops infiltration and exfiltration of air, reducing heating and air cooling costs without the use of additional gaskets • LED housing is designed to provide 50,000 hours of life and is compatible with many standard Juno trims • 5 year limited warranty on LED components.

### ENVIRONMENTALLY FRIENDLY, ENERGY EFFICIENT

- No harmful ultraviolet or infrared wavelengths
- No lead or mercury, RoHS compliant
- Comparable light output to 75W incandescent

### PRODUCT SPECIFICATIONS

**LED Light Engine** LED array attached to high purity aluminum, thermally conductive inner housing provides superior heat transfer to ensure long life of the LED • Replaceable light engine mounts directly to inner housing assembly and incorporates the latest generation, high lumen output LED array • LEDs are binned within a 3-step MacAdam Ellipse exceeding ENERGY STAR® requirements for superior fixture to fixture color uniformity • 2700K, 3000K, 3500K, or 4100K color temperatures available • 90 CRI minimum.

**Optical System** Angle-cut aluminum reflector and specular clear kicker reflector directs light toward wall for uniform illumination on vertical surfaces while concealing LED optic assembly and minimizing glare • LEDs are concealed by high transmission diffusing lens.

**Aesthetic Trim Selections** Recessed lensed wall wash trim • Shadow free, knife edge design blends seamlessly into ceiling • Reflector finishes include clear, haze, wheat haze and white paint.

**LED Driver** Choice of dedicated 120 volt driver or universal voltage driver that accommodates input voltages from 120-277 volts AC at 50/60Hz • Power factor > 0.9 at 120V input • 120 volt only driver is dimmable with the use of most incandescent, magnetic low voltage and electronic low voltage wall box dimmers • Universal voltage driver is dimmable with the use of most 0-10V wall box dimmers • For a list of compatible dimmers, see [JUNOICLED-DIM](#) • Mounted inside housing for easy access from below ceiling.

**Life** Rated for 50,000 hours at 70% lumen maintenance.

**Labels** ENERGY STAR® Qualified when used with select trims • Certified to the high efficacy requirements of California T24 with select trims • UL listed for U.S. and Canada through-branch wiring, damp locations • Union made • UL and cUL.

**Testing** All reports are based on published industry procedures; field performance may differ from laboratory performance.

Product specifications subject to change without notice.

### HOUSING FEATURES

**Housing** Designed for use in IC (insulated ceiling) or non-IC construction • Aluminum housing sealed for Air-Loc® compliance • Housing is vertically adjustable to accommodate up to a 1 1/2" ceiling thickness.

**Junction Box** Pre-wired junction box provided with (6) 1/2" and (1) 3/4" knockouts, (4) knockouts for 12/2 or 14/2 NM cable and ground wire • UL listed and cUL listed for through-branch wiring, maximum 4 #12 branch circuit conductors • Junction box provided with removable access plates • Knockouts equipped with pryout slots • Quick connect electrical connectors supplied as standard for fast, secure installation.

**Mounting Frame** 22-gauge die-formed galvanized steel mounting frame • Rough-in section (junction box, mounting frame, housing and bar hangers) fully assembled for ease of installation.

**Real Nail 3 Bar Hangers** Patented (US Patent D552,969) Real Nail® 3 bar hangers: telescoping system permits quick placement of housing anywhere within 24" O.C. joists or suspended ceilings • Includes removable nail for repositioning of fixture in wood joist construction • Integral T-bar notch and clip for suspended ceilings.



### DIMENSIONS

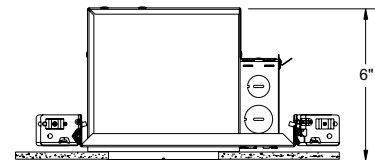
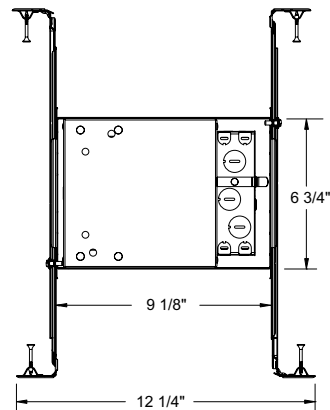

4 1/2" CEILING CUTOUT

### ELECTRICAL DATA

#### Dedicated 120V Only Driver Option

##### 120V

Input Power	14.9W (+/-5%)
Input Current	0.13A
Frequency	50/60Hz
EM/RFI	FCC Title 47 CFR, Part 15, Class B (residential)
Minimum starting temp	-25°C

### ELECTRICAL DATA

#### Universal Voltage



	120V	277V
Input Power	15.6W (+/-5%)	15.6W (+/-5%)
Input Current	0.14A	0.08A
Frequency	50/60Hz	50/60Hz
EM/RFI	FCC Title 47 CFR, Part 15, Class A (non-consumer)	FCC Title 47 CFR, Part 15, Class A (non-consumer)
Minimum starting temp	-40°C	-40°C

\* Nominal input wattage @ 120-volt operation with dedicated 120-volt driver under stable operating conditions.

# 4" IC 900 LUMEN LED DOWNLIGHT NEW CONSTRUCTION

## IC91LEDG4 RECESSED HOUSING WALL WASH TRIM

**ORDERING INFORMATION:** Housing and trim each ordered separately.

Example: <b>IC91LEDG4-3K-1</b>			Example: <b>39C-WH</b>	
Housing	Color Temperature	Input Voltage	Trim/Description	
<b>IC91LEDG4</b>	<b>27K</b> 2700K <b>3K</b> 3000K <b>35K</b> 3500K <b>41K</b> 4100K	<b>1</b> Dedicated 120V Only (Forward Phase + ELV dimmable)  <b>U</b> Universal Voltage, 120-277V (0-10V dimmable)	 <b>39C-WH</b> Lensed Wall Wash - Clear Alzak® <b>39W-WH</b> Lensed Wall Wash - Gloss White <b>39HZ-WH</b> Lensed Wall Wash - Haze <b>39WHZ-WH</b> Lensed Wall Wash - Wheat Haze	 Trim Size: 5" O.D. Trim Finish: WH - White. Alzak is a registered trademark of Alcoa Corp. Note: In Canada when insulation is present, Type IC fixtures must be used.

### PHOTOMETRIC REPORT

Test Report #: PT10142305R  
 Catalog No: IC91LEDG4-35K-1  
 with 39C-WH Trim

Luminaire Spacing Criterion: 0.70  
 Luminaire LPW: 57

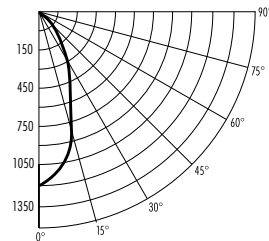

### CANDLEPOWER DISTRIBUTION (Candelas)

Degrees	Candelas
<b>Vertical</b>	<b>0°</b>
0	1200
5	1179
15	886
25	468
35	164
45	66
55	38
65	21
75	8
85	0
90	0

Multiplier: 27K - 0.89  
 3K - 0.94  
 41K - 1.03

### ZONAL LUMEN SUMMARY

Zone	Lumens	%Lamp	%Fixture
0-30°	586	N/A	68.30
0-40°	736	N/A	85.70
0-60°	843	N/A	98.20
0-90°	858	N/A	100.0

### LUMINANCE (Average cd/m²)

Degrees	Average Luminance
45	17565
55	12328
65	9525
75	6139
85	0

### FOOTCANDLES ON WALL FROM MULTIPLE FIXTURES

Fixture Distance to Wall	2'			3'		
	1'	2'	3'	1'	2'	3'
1'	5	5	5	4	4	4
2'	11	11	11	9	8	9
3'	15	15	15	12	10	12
4'	19	20	19	14	13	14
5'	20	20	20	14	14	14
6'	19	19	19	14	14	14
7'	17	17	17	12	13	12
8'	15	15	15	11	11	11
9'	13	13	13	9	9	9

Fixtures tested to IES recommended standard for solid state lighting per LM-79-08. Photometric performance on a single unit represents a baseline of performance for the fixture. Results may vary in the field.

