

JUNO 2" LED RECESSED HOUSINGS

WARNING: For your safety, read and understand instructions completely before starting installation. Before wiring to power supply, turn off electricity at the fuse or circuit breaker box.

NOTE: Juno recessed fixtures are designed to meet the latest NEC requirements and are listed in full compliance with the relevant UL standard(s). Before attempting installation of any recessed lighting fixture, check your local electrical building code. This code sets the wiring standards and installation requirements for your locality and should be understood before starting work. Use of non-Juno trims voids Juno warranty.

SAVE THESE INSTRUCTIONS

Juno Type IC fixtures are designed for direct contact with insulating materials which are approved for this application (Fig. 1). Fixtures may also be used in non-insulated ceilings.

Juno Air-Loc LED housings are supplied with pre-installed gaskets for energy savings and to comply with energy code air leakage requirements per ASTM E283.

Product ships with Mounting Frame and LED Trim Module. Does not include New Construction Plaster Frame (2-NCMF).

THE JUNO 2" LED LUMINAIRES CAN BE INSTALLED IN MULTIPLE WAYS.

REMODEL STYLE INSTALLATION

Step 1. A precise ceiling opening is required for mounting of this fixture. The use of a 2 5/8" hole saw is highly recommended. Fixture can accommodate ceiling thicknesses from 0.5" to 1". Use Part No. 2-JCTA150 to accommodate ceilings from 1" to 1.5"

Step 2. Follow steps 1-4 under Electrical Connection.

Step 3. Slide mounting frame, wiring compartment first, thru ceiling cut-out (Fig. 2).

Step 4. Align frame over opening so that 4 tabs center the fixture in the hole (Fig. 3).

Step 5. Pull ceiling clamps back thru ceiling opening. Position the feet on the room side of the ceiling and tighten clamping screw to secure the frame to the ceiling. **DO NOT OVERTIGHTEN!** The clamps only need to be tight enough to positively hold the frame in location. Overtightening the screw will lead to damage to the ceiling and loss of function of the ceiling clamps.

Step 6. Loosen 2 screws and remove top cover from LED trim module. Plug in connector. **DO NOT ALLOW LED TRIM MODULE TO HANG FROM THIS CONNECTION** (Fig. 4).

Step 7. Place connection back into top of LED trim module. Secure armored cable in "U" shaped opening of top cover and tighten screws to secure cover in place (Fig. 5).

Step 8. Orient flats of heatsink to the ceiling clamps and slide module into mounting frame until secure (Fig. 6).

NEW CONSTRUCTION INSTALLATION

For installation into joist construction, use 2-NCMF New Construction Mounting Frame accessory.

Step 1. Extend bar hangers to fit between joists. Bar hanger foot is contoured to easily align with bottom of joist (Fig. 7). Position fixture by hammering Real-Nails® into joists (Fig. 8).

Step 2. Slide frame along bar hangers into desired location. Use locking screws or slot to secure (Fig. 9).

Relocating Frame – Nail can be removed with hammer claw to allow easy repositioning of fixture without damaging bar hanger or nail (Fig. 10).

Step 3. Use steel wire on plaster frame to secure flexible supply. It is critical that the flex supply is accessible from below the ceiling where there is no top access to the fixture location (Fig. 11). Leave adequate length (1' minimum) that can be pulled into room after ceiling installation.

Step 4. A precise hole is required for mounting of this fixture. Cutting along the ID of the mounting frame will provide an accurate hole. After cutting of hole proceed with installation steps from remodel fixture starting at step 2.

INSTALLATION INTO SUSPENDED CEILING

For installation into suspended ceiling, use 2-NCMF New Construction Mounting Frame accessory.

Step 1. Locate center of proposed opening on ceiling tile and cut a 2 5/8" hole. An accurate hole is critical for fixture mounting, a 2 5/8" hole saw is highly recommended.

Step 2. Place ceiling tile in T-bar grid.

Step 3. Place frame into position and snap bar hanger foot with integral T-bar notch onto T-bars (Fig. 12). Lock in place. Additional holes are provided for securing with wire or screws if desired.

Continue with installation from step 2 of the remodel fixture instructions.

TYPE IC FOR INSULATED CEILINGS

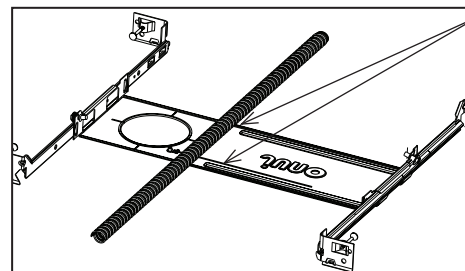
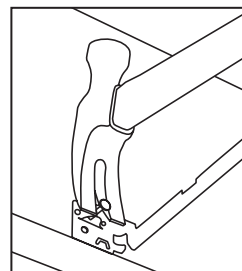
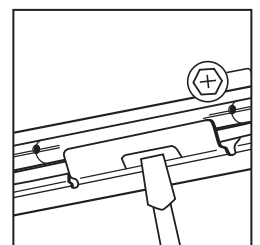
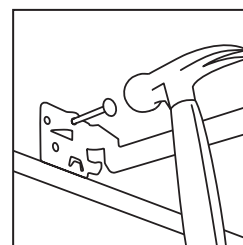
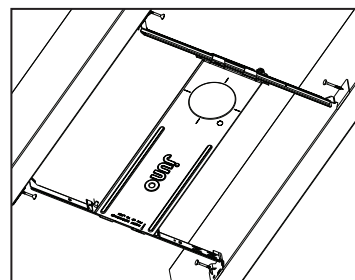
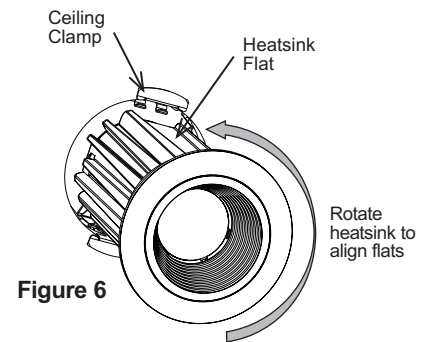
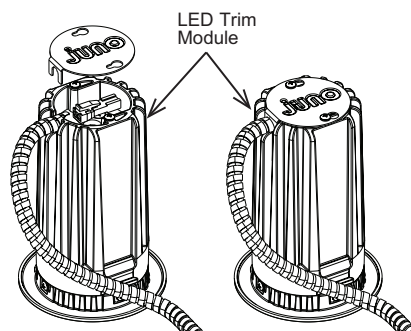
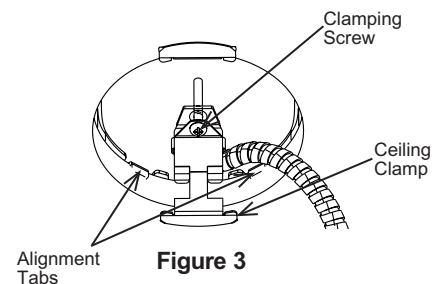
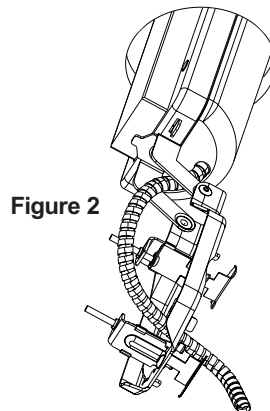
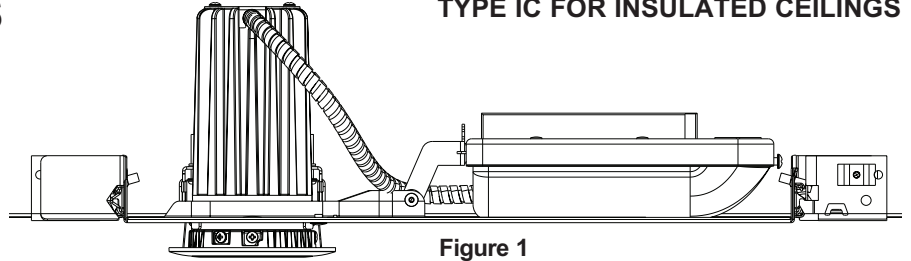

Use wire to secure flex supply to mounting frame. Leave adequate length that can be pulled thru the ceiling to attach to wiring compartment on the room side (1' minimum).

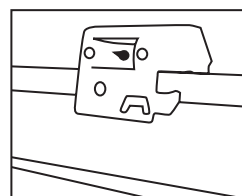

JUNO 2" LED RECESSED HOUSINGS

ELECTRICAL CONNECTION INSTRUCTIONS

Step 1. Provide electrical service according to national and/or local electrical code to the junction box located on the mounting frame. Supply wire insulation must be rated for at least 90°C. Note: This fixture requires a flexible electrical supply.

Step 2. Remove wiring compartment cover. Remove the appropriate knock-out(s) to accommodate the type of electrical supply being used (Fig. 13):

Flexible Metal Conduit or Non-Metallic Sheathed Cable. Remove appropriate round knock-out(s) and connect conduit to junction box with proper connectors (not supplied).

Step 3. Strip supply wire 3/8" and insert each supply wire into appropriate connector. Connect black fixture wire to hot, white fixture wire to neutral and green fixture wire to ground. (Fig. 13).

Connect violet (+) and gray (-) dimmer wires, (-U models only).

Step 4. Place all wiring and connectors back in wiring compartment and replace cover, taking care not to pinch any wires.

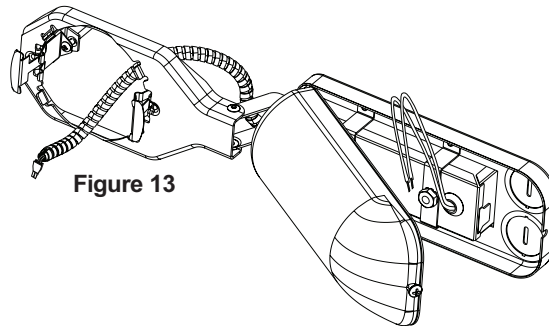

Figure 13

DRIVER REPLACEMENT

Driver replacement by qualified electrician only.

Fixture must be removed to access driver.

Step 1. Pull LED module back down thru the ceiling opening.

Step 2. Loosen 2 screws on top of LED trim module and remove cover. Unplug connector.

Step 3. Loosen ceiling clamp screws. Push ceiling clamps up into the ceiling cavity. Pull complete frame assembly back thru the ceiling opening.

Step 4. Open wiring compartment and remove connectors from driver. Remove 2 fasteners from driver to pull it free from the wiring compartment.

Step 5. Insert and secure new driver into wiring compartment. Make wiring connections and re-install fixture as described in the appropriate section of these instructions.

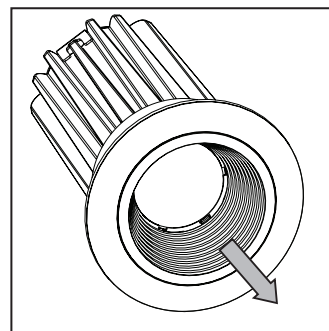

Figure 14

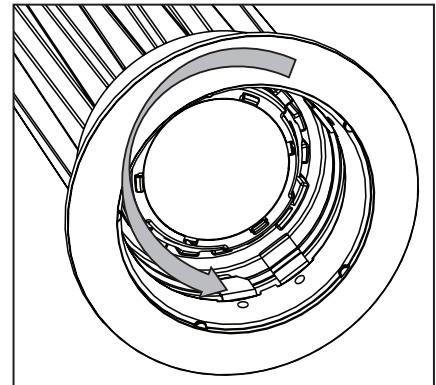

Figure 15

OPTIC REPLACEMENT – DOWNLIGHTS

Step 1. Pull baffle or reflector out of trim. It may be necessary to insert a small screwdriver between the baffle and the optic holder to pry it free (Fig. 14).

Step 2. Twist black optic holder counter-clockwise to remove optic and holder (Fig. 15).

Step 3. Remove optic from black optic holder. Snap the new optic into the black optic holder (Fig. 16).

Step 4. Align the tabs in the heatsink to the slots in the optic holder and push optic into fixture. Twist optic holder clockwise to secure (Fig. 17).

Step 5. Press the baffle or reflector back into the fixture. Note that the baffle has depressions in it that must align with the tabs on the trim ring (Fig. 18).

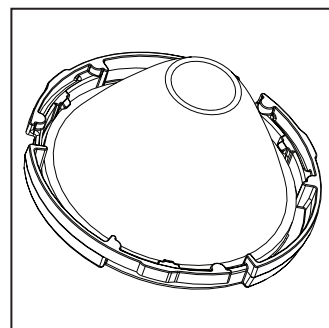

Figure 16

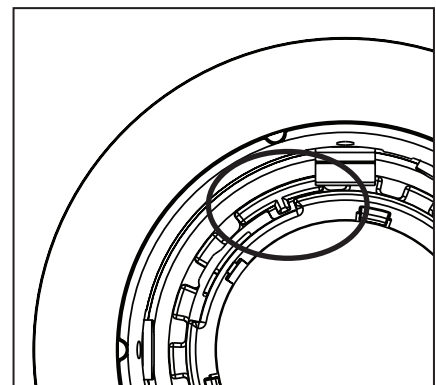

Figure 17

OPTIC REPLACEMENT – ADJUSTABLES

Step 1. Insert a small screwdriver into the slots between the gimbal face and body. Pry off the face. It may be necessary to pry in a few locations to pull the face evenly off. Optic will come free after the face is pulled off (Fig. 19).

Step 2. Place the desired optic onto the gimbal face. Align the 2 posts on the gimbal face with the spring receivers in the gimbal body. Push the face and optic into the gimbal body (Fig. 20).

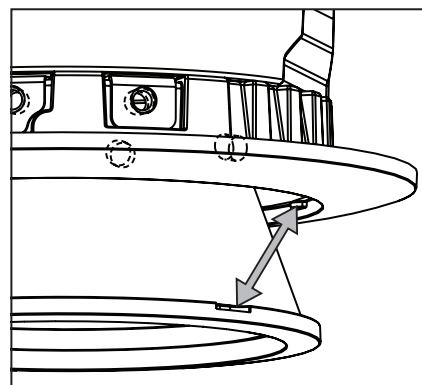

Figure 18

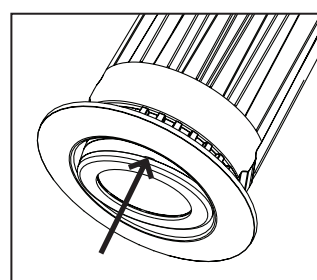

Figure 19

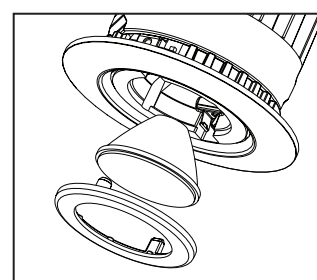

Figure 20

WARRANTY

Juno Lighting Group provides five year limited warranty on LED components from date of purchase. Juno Lighting Group's obligation is expressly limited to repair or replacement, without charge, at Juno Lighting Group's factory after prior written return authorization has been granted. This warranty shall not apply to products which have been altered or repaired outside of Juno Lighting Group's factory. This warranty is in lieu of all other warranties, expressed or implied, and without limiting the generality of the foregoing phrase, excludes any implied warranty of merchantability. Also, there are no warranties which extend beyond the description of the product on the company's literature setting forth terms of sale.

Product Services Phone (888) 387-2212