

**READ AND FOLLOW ALL SAFETY INSTRUCTIONS!
SAVE THESE INSTRUCTIONS AND DELIVER TO OWNER AFTER INSTALLATION**

- To reduce the risk of death, personal injury or property damage from fire, electric shock, falling parts, cuts/abrasions, and other hazards please read all warnings and instructions included with and on the fixture box and all fixture labels.
- Before installing, servicing, or performing routine maintenance upon this equipment, follow these general precautions.
- Installation and service of luminaires should be performed by a **qualified licensed electrician**.
- Maintenance of the luminaires should be performed by person(s) familiar with the luminaires' construction and operation and any hazards involved. Regular fixture maintenance programs are recommended.
- It will occasionally be necessary to clean the outside of the refractor/lens. Frequency of cleaning will depend on ambient dirt level and minimum light output which is acceptable to user. Refractor/lens should be washed in a solution of warm water and any mild, non-abrasive household detergent, rinsed with clean water and wiped dry. Should optical assembly become dirty on the inside, wipe refractor/lens and clean in above manner, replacing damaged gaskets as necessary.
- **DO NOT INSTALL DAMAGED PRODUCT!** This luminaire has been properly packed so that no parts should have been damaged during transit. Inspect to confirm. Any part damaged or broken during or after assembly should be replaced.
- Recycle: For information on how to recycle LED electronic products, please visit www.epa.gov.
- These instructions do not purport to cover all details or variations in equipment nor to provide every possible contingency to meet in connection with installation, operation, or maintenance. Should further information be desired or should particular problems arise which are not covered sufficiently for the purchaser's or owner's purposes, this matter should be referred to Acuity Brands Lighting, Inc.



**WARNING
RISK OF ELECTRIC SHOCK**

- ✓ Disconnect or turn off power before installation or servicing.
- ✓ Verify that supply voltage is correct by comparing it with the luminaire label information.
- ✓ Make all electrical and grounded connections in accordance with the National Electrical Code (NEC) and any applicable local code requirements.
- ✓ All wiring connections should be capped with UL approved recognized wire connectors.



**WARNING
RISK OF BURN**

- ✓ Allow lamp/fixture to cool before handling. Do not touch enclosure or light source.
- ✓ Do not exceed maximum wattage marked on luminaire label.
- ✓ Follow all manufacturer's warnings, recommendations and restrictions for: driver type, burning position, mounting locations/methods, replacement and recycling.



**CAUTION
RISK OF INJURY**

- ✓ Wear gloves and safety glasses at all times when removing luminaire from carton, installing, servicing or performing maintenance.
- ✓ Avoid direct eye exposure to the light source while it is on.



**CAUTION
RISK OF FIRE**

- ✓ Keep combustible and other materials that can burn, away from lamp/lens.
- ✓ Do not operate in close proximity to persons, combustible materials or substances affected by heat or drying.



CAUTION: RISK OF PRODUCT DAMAGE

- ✓ Never connect components under load.
- ✓ Do not mount or support these fixtures in a manner that can cut the outer jacket or damage wire insulation.
- ✓ Unless individual product specifications deem otherwise: Never connect an LED product directly to a dimmer packs, occupancy sensors, timing devices, or other related control devices. LED fixtures must be powered directly off a switched circuit.
- ✓ Unless individual product specifications deem otherwise: Do not restrict fixture ventilation. Allow for some volume of airspace around fixture. Avoid covering LED fixtures with insulation, foam, or other material that will prevent convection or conduction cooling.
- ✓ Unless individual product specifications deem otherwise: Do not exceed fixtures maximum ambient temperature.
- ✓ Only use fixture in its intended location.
- ✓ LED products are Polarity Sensitive. Ensure proper Polarity before installation.
- ✓ Electrostatic Discharge (ESD): ESD can damage LED fixtures. Personal grounding equipment must be worn during all installation or servicing of the unit.
- ✓ Do not touch individual electrical components as this can cause ESD, shorten lamp life, or alter performance.
- ✓ Some components inside the fixture may not be serviceable. In the unlikely event your unit may require service, stop using the unit immediately and contact an ABL representative for assistance.
- ✓ Always read the fixtures complete installation instructions prior to installation for any additional fixture specific warnings.

All luminaires that contain electronic devices that generate frequencies above 9kHz from any component within the luminaire comply with Part 15 of the FCC Rules. Operation is subject to the following two conditions:

- (1) This device may not cause harmful interference
- (2) This device must accept any interference received, including interference that may cause undesired operation

Failure to follow any of these instructions could void product warranties. For a complete listing of product Terms and Conditions, please visit www.acuitybrands.com.

Our Brands Indoor/Outdoor Lithonia Lighting Carandini Holophane RELOC Light Concepts	Indoor Lighting Gotham Mark Architectural Lighting Peerless Renaissance Lighting Winona Lighting	Outdoor Lighting American Electric Lighting Antique Street Lamps Hydrel Tersen	Controls DARK TO LIGHT LC&D ROAM Sensor Switch Synergy	Daylighting SunOptics
---	---	--	---	--------------------------

Acuity Brands Lighting, Inc. assumes no responsibility for claims arising out of improper or careless installation or handling of its products.

ABL LED General Warnings, Form No. 503.203

© 2010 Acuity Brands Lighting, Inc. All rights reserved. 12/01/10

Note: Only for use with plugs provided by ABL (Acuity Brands Lighting). Please see luminaire nameplate label for electrical ratings.

1 Introduction

1.1 Product Description. Light Emitting Diode (LED) luminaire.

1.2 Alternate Information Sources.

Holophane Field Service Department
P.O. Box 3004
Newark, OH 43058-3004
(740) 345-9631

2 Installation

2.1 Tools and Materials Required.

TABLE 1. Installation Tools and Materials

<u>DESCRIPTION</u>
5/16" socket for lens retainer and light engine Screws 30in-lb
5/16" socket for end cap screws 35in-lb
1/4" or larger Slotted screwdriver for light engine removal
1/2" drive ratchet for removal of 3/4" Plugs 35in-lb

2.2 Luminaire Mounting

2.2.1 Disconnect power to luminaire location.

2.2.2 Provide and install a suitable mounting structure.

2.2.2.1 A suitable mounting structure must be provided that supports the full weight of the luminaire in accordance with local codes.

2.3 Wiring Standards

2.3.1 Wire per NEC Article 501 and CEC section 18 where applicable.

3.0 Cleaning

3.1 Disconnect power to the unit prior to opening and performing any maintenance.

3.2 Wipe off exterior dirt and debris using a soft clean cloth. A mild detergent and water may be used if necessary. Do not use abrasive cleaners on optical surfaces. Their use may result in the loss of optical efficiency.

CAUTION - OPEN CIRCUIT BEFORE REMOVING COVER and OUVRIR LE CIRCUIT AVANT D'ENLEVER LE COUVERCLE

CAUTION - KEEP COVER TIGHT WHILE CIRCUITS ARE ALIVE and GARDER LE COUVERCLE BIEN FERME TANT QUE LES CIRCUITS SONT SOUS TENSION

FOR CONNECTIONS USE WIRE RATED FOR AT LEAST 90 °C; POUR LES CONNEXIONS UTILISER DES CONDUCTEURS D'ALIMENTATION CONVENANT 90 °C

Temperature Code:

Length (foot)	lumen (lm)	Max Amb. Temp. (°C)	Supply Wire Temp. (°C)	Class I, Div. 2	Class II, Div. 2, Group F, G	Simultaneous Class I, Div. 2, Class II Div. 2, Group F, G; Class III
2ft/4ft	≤10,000	40 °C	90°C	T6	T6	T6
		50 °C		T6	T6	T6
		55 °C		T5	T6	T5
		60 °C		T5	T5	T5
4ft		65 °C		T5	T5	T5
4ft	10,000< <18,000	40 °C	90°C	T5	T6	T5
		50 °C		T4A	T6	T4A
		55 °C		T4A	T6	T4A
		60 °C		T4A	T5	T4A

EMXH INSTALLATION INSTRUCTIONS

INSTALLATION OF THIS FIXTURE IN ANY OTHER MANNER THAN WHAT IS INDICATED WITHIN THESE INSTRUCTIONS WILL VOID ALL WARRANTIES.

These instructions are for fixture level installation.

Ensure proper voltage will be supplied to the fixture. Check the fixture label on the carton for fixture voltage. Fixture must be grounded before use. Remove fixture from packaging and check for damage. Care should be taken to protect fixture during handling. Remove plastic film from lens prior to installation.

MOUNTING METHODS

Mounting options must be specified when ordered. The following mounting methods are available. Please refer to the specification sheet when determining acceptable mounting options for specific application.

- **Surface/suspended** – chain, aircraft cable
 - Standard mounting bracket
 - Rigid mounting bracket (RMBK)
- **Surface Angle (ceiling, wall, angle)**
 - Rigid mounting Angle Bracket (RMBA)
- **U-bolt pole mounting**
 - 1 ½" Trade size Pipe mounting (RMBU)

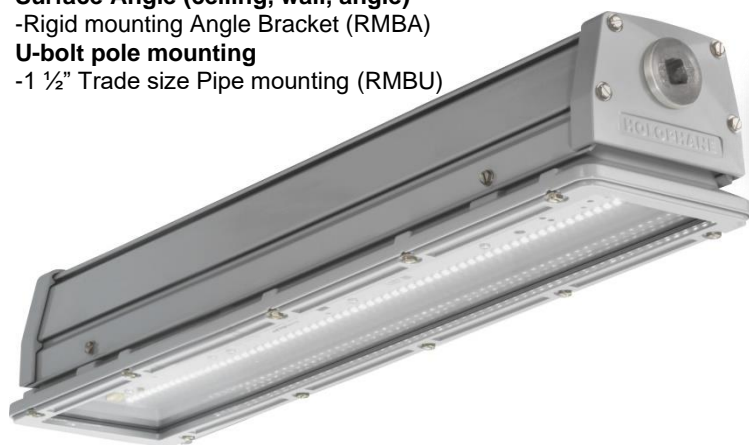

GENERAL INSTALLATION

For all mounting methods ensure facility mounting points and mounting hardware (provided by others) are rated for 4 times the fixture weight, approximate fixture weight is 25 lbs (4ft) or 18 lbs (2ft). The fixture mounting spacing is MAX 43.7" (L48) or 19.7" (L24) apart. The mounting brackets adjust inside the integrated fixture mounting rail to accommodate custom mounting positions.

CABLE INSTALLATION

For cable mounting, install the cable into the two provided mounting brackets on the fixture.

CHAIN INSTALLATION

For Chain mounting, install the S-HOOK into the two provided mounting brackets on the fixture.

Cable or chain is attached to the S-hooks (s-hook, cable or chain is ordered separately or provided by others).

Standard Mounting Bracket Installation

1. Install the mounting brackets to the facility mounting points MAX 43.7" (L48) or 19.7" (L24) apart.
2. Hang fixture inside one edge of the 2 installed brackets and rotate up to snap in the other edge of the bracket. The fixture will snap into bracket.



RMBK INSTALLATION

1. See Figure to right for RMBK Detail. Install the RMBK mounting brackets to the facility mounting points MAX 43.7" (L48) or 19.7" (L24) apart.
2. Hang fixture inside one edge of the 2 installed RMBK Brackets and rotate up to snap in the other edge of the bracket. The fixture will snap into RMBK bracket.
3. Install the carriage bolt and nut into both RMBK Brackets and tighten nut down to 13 in-lb. Make sure the power cord is not pinched between the fixture housing and RMBK mounting brackets.

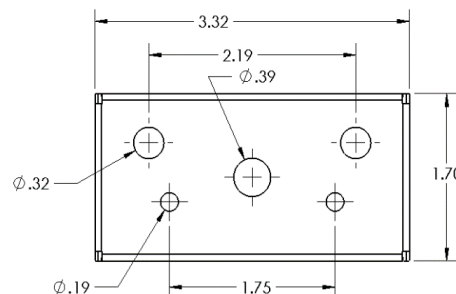

RMBA INSTALLATION

1. Set the RMBA mounting brackets to desired angle using set pin. Install the RMBA mounting brackets to the facility mounting points MAX 43.7" (L48) or 19.7" (L24) apart.
2. Hang fixture inside one edge of the 2 installed RMBA brackets and rotate up to snap in the other edge of the bracket. The fixture will snap into RMBA bracket.
3. Install the carriage bolt and nut into both RMBA Brackets and tighten nut down to 13 in-lb. Make sure the power cord is not pinched between the fixture housing and RMBA mounting brackets.



DRIVER AND WIRING ACCESS

Once the fixture is installed:

1. Remove the end cap by removing the 4 screws shown on wire entry end of fixture.
2. Make the electrical connection to the fixture in accordance with your local electrical code. Make all necessary wiring connections, observing proper voltage and polarity. ALL Wire entry openings must be sealed during installation.

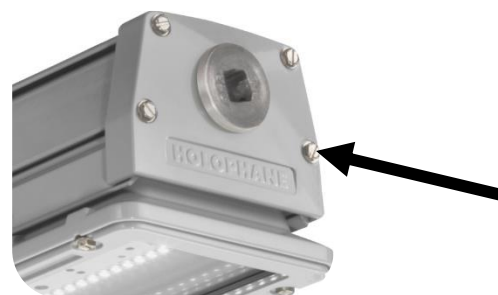

3. **When reattaching components, ensure the gasket is properly in place and not pinching/catching wires.**

Torque end cap screws 35in-lb

4. Only when full channel access is required or when performing maintenance, the light engine may be removed. **PLEASE NOTE* Moderate force is required to reinstall the light engine. Remove fixture and place on flat surface if possible.** To remove the light engine, remove the 4 screws per light engine 2 located on each side of fixture. Insert flat tip screwdriver into opening directly under screw hole and pry downward to shift the light engine away from the housing. Repeat for the second screw hole on the same side of the light engine. The light engine will swing down and hang by a tether on one end of the housing to allow easy access to the wireway.



5. Before reassembly, ensure gasket is seated properly on the light engine as shown.



6. To close, align the snaps onto the channel on one side and rotate up and squeeze light engine and driver housing together to snap into place.

PLEASE NOTE* Moderate force is required to squeeze light engine into position.

Once snapped, reinstall the 4 screws(30in-lb) per light engine to secure in place.



TROUBLE SHOOTING

If this fixture fails to operate properly, check to make sure:

1. The fixture is wired correctly.
2. The fixture is grounded correctly.
3. The line voltage at the fixture is correct.