

**Description**

The Halo E5 series consists of compact and efficient recessed housings optimized and listed for PAR20 and PAR30, EISA compliant, tungsten-halogen, CFL and LED lamps as well as incandescent. The Halo E5 housing is suitable for residential or light commercial applications. For installation in insulated ceilings\* and non-insulated ceilings; with airtight code compliant construction. Use with a variety of trims and finishes to create different lighting effects or to match any decor. The E5ICATNB can save installation time. It is designed without a socket plate for use with socket supporting trims only. With these trims there is no need to spend time removing the socket plate and the fixed lamp position of socket supporting trims saves on lamp adjustment time too. May be retrofit with HALO LED lighting systems.

Catalog #		Type
Project		
Comments		Date
Prepared by		

**Specification Features**

**Housing**

- Single wall die-formed aluminum housing
- Housing features a precision rolled interlocking collar which maintains aperture geometry for greater assurance of installation results
- Integral Air-Tite gasket for code-required gasket between fixture and finished ceiling - seals aperture without need for additional caulk
- May be removed from the plaster frame to provide access to junction box

**Plaster Frame**

- Galvanized steel frame. Housing adjusts in plaster frame to accommodate up to 3/8" - 1" ceiling thickness
- (2) Regressed locking screws for securing hanger bars
- Integral Air-Tite gasket seals housing and meets code-required gasket between fixture and finished ceiling

**Includes:**

**Bar Hangers**

**All Nail!™**

- Integral precisely positioned nail for engineered and natural framing
- Mini-foot leveling flange
- Integral T-Grid Clip, no accessory clips required

**q-Channel bars with Pass-N-Thru™**

- Unique inverted "q" interlocking channel for rigidity and stability
- Pass-N-Thru™ feature allows bars to cross-over for tool-less shortening in tight spaces

**Hinged junction box w/ Slide-N-Side™**

- (4) 1/2" conduit pry-outs
- (3) Slide-N-Side™ Non-Metallic (NM) wire traps, allow wiring outside the box
- For 14-2, 14-3, 12-2, 12-3 U.S. and 14-2, 14-3, 12-2 Canadian
- Hinged door for easy access
- Box is repositionable 90° on frame to avoid obstructions

**Quick Connect™**

- (3) Push wire nuts included, for speed & reliability
- Clear caps for wire connection visibility

**cULus Listed**

- Compact 16 in<sup>3</sup> volume
- Listed for max. (10) No. 12 AWG or (14) No. 14 AWG 90° C splice conductors in box

**Air-Tite™ code compliant**

- Certified under ASTM E283
- Exclusive gasket seals aperture, frame & ceiling
- No additional caulk required

**Socket**

- Porcelain socket with nickel plated brass screw shell
- Snap-in socket speeds installation and attaches directly to the trim for consistent lamp positioning

**Thermal Protector**

- Self resetting thermal protector deactivates fixture if overheating occurs due to improper lamping or misapplied insulation

**Trims**

- Halo Fit-All concept offers multiple trim options in a variety of design styles, and functional beam distributions to control beam angle and lumen delivery in accommodating various lamp types including Halogen, CFL and LED

**Compliance**

- cULus Listed 1598 Luminaire
- cULus Listed Damp Location
- cULus Listed for Wet Location, covered ceiling, with select trims
- cULus Listed for direct contact with insulation and combustible material\*
- Air-Tite code compliant. Certified under ASTM E283; not exceeding 2.0 cfm (0.944 L/s) air leakage rate tested at a 1.57 psf (75 Pa) pressure differential
- RoHS compliant

\*Not to be used in direct contact with spray foam insulation (Consult NEMA LSD57-2013)



**E5ICATNB**

**5" IC, Air-Tite, New Construction Housing, No Bracket**

**E26 Screw base housing**

**Dimensions**

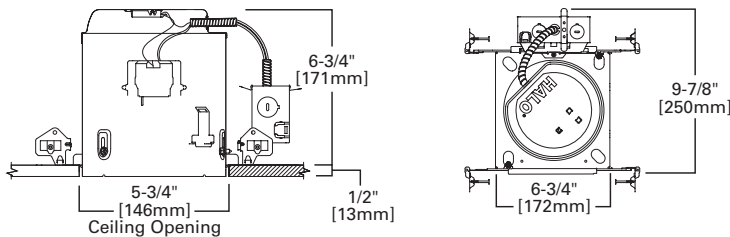

**FOR USE IN INSULATED CEILINGS**

**FOR DIRECT CONTACT WITH INSULATION\***

**Special Features**

- All-Nail!™ bar hangers
- q-Channel bars with Pass-N-Thru™
- Hinged J-Box with Slide-N-Side™
- Quick Connect™ push wire nuts
- Air-Tite™ code compliant

**Ordering Information**

Sample Number: ESICATNB 5120WH  
 Order housing, trim and lamp (by others) separately for a complete luminaire.

**Housing**

ESICATNB = 5" insulated ceiling, airtight recessed housing, new construction, 120V

**Trims**

<p><b>Reflectors</b></p> <p><b>5020 PAR Reflector</b>                  OD: 6-3/8" [162mm]                  5020P=White Reflector and Trim                  5020H=Haze Reflector, White Trim                  5020SC=Clear Specular Reflector, White Trim                  5020BL=Black Specular Reflector, White Trim                  5020SN=Satin Nickel Reflector and Trim                  5020TBZ=Tuscan Bronze Reflector and Trim</p> <p><b>5021 Full Reflector</b>                  OD: 6-3/8" [162mm]                  5021H=Haze Reflector, White Trim                  5021SC=Specular Clear Reflector, White Trim                  5021SN=Satin Nickel Reflector and Trim                  5021TBZ=Tuscan Bronze Reflector and Trim</p> <p><b>5120 Full Cone, Self-flange</b>                  OD: 6-5/8" [168mm]                  5120WH=White Reflector and Trim                  5120SN=Satin Nickel Reflector and Trim                  5120TBZ=Tuscan Bronze Reflector and Trim</p> <p><b>5121 Shallow Full Cone, Self-flange</b>                  OD: 6-5/8" [168mm]                  5121WH=White Reflector and Trim</p> <p><b>Baffles</b></p> <p><b>5001 PAR Metal Baffle Splay</b>                  OD: 6-3/8" [162mm]                  5001P=White Baffle and Trim                  5001MB=Black Baffle, White Trim                  5001SN=Satin Nickel Baffle and Trim                  5001TBZ=Tuscan Bronze Baffle and Trim</p> <p><b>5010 PAR Metal Step Baffle</b>                  OD: 6-3/8" [162mm]                  5010W=White Baffle and Trim                  5010=Black Baffle, White Trim</p> <p><b>5014 Shallow Metal Baffle, Self-flange</b>                  OD: 6-3/8" [162mm]                  5014P=White Baffle and Trim                  5014MB=Black Baffle, White Trim</p> <p><b>5016 Coilex® Baffle with Reflector and Torsion Springs</b>                  OD: 6-3/8" [162mm]                  5016W=White Coilex Baffle and Trim                  5016P=Black Coilex Baffle, White Trim</p> <p><b>5125 Full Cone Baffle, Self-flange</b>                  OD: 6-3/4" [172mm]                  5125WB=White Baffle and Trim                  5125BB=Black Baffle, White Trim</p> <p><b>5126 Shallow Full Cone Baffle, Self-flange</b>                  OD: 6-3/4" [172mm]                  5126WH=White Baffle and Trim                  5126BB=Black Baffle, White Trim</p>	<p><b>Adjustable - Eyeballs &amp; Gimbals</b></p> <p><b>5060 PAR30 Adjustable Gimbal 20° Tilt, Self-flange</b>                  OD: 6-3/8" [162mm]                  5060P=White Gimbal and Trim</p> <p><b>5070 PAR30 Adjustable Eyeball 30° Tilt, Self-flange</b>                  OD: 6-3/4" [172mm]                  5070P=White Eyeball and Trim                  5070SN=Satin Nickel Eyeball and Trim                  5070TBZ=Tuscan Bronze Eyeball and Trim</p> <p><b>5071 Adjustable Eyeball 30° Tilt, Self-flange</b>                  OD: 6-3/8" [162mm]                  5071P=White Eyeball and Trim</p> <p><b>5130 PAR30 Eyeball 35° Tilt, Self-flange</b>                  OD: 6-3/8" [162mm]                  5130WH=White Eyeball and Trim</p> <p><b>5135 PAR20 Eyeball 35° Tilt, Self-flange</b>                  OD: 6-3/8" [162mm]                  5135WH=White Eyeball and Trim</p> <p><b>5165 PAR30 Gimbal 25° Tilt, Self-flange</b>                  OD: 6-3/4" [172mm]                  5165WH=White Gimbal and Trim                  5165BK=Black Gimbal and Trim                  5165SN=Satin Nickel Gimbal and Trim                  5165TBZ=Tuscan Bronze Gimbal and Trim</p> <p><b>5222 Regressed PAR30 Adjustable, 35° Tilt, Self-flange</b>                  OD: 6-3/4" [172mm]                  5222WB=White Baffle and Trim                  5222BB=Black Baffle, White Trim                  5222SC=Specular Clear Reflector, White Trim                  5222H=Haze Reflector, White Trim</p> <p><b>Lenses &amp; Wet Location Showerlights</b></p> <p><b>5051 Frosted Lens - Showerlight</b>                  OD: 6-3/8" [162mm]                  5051PS=Frosted Glass Lens, White Trim</p> <p><b>5054 Air-Tite Frosted Dome Lens - Showerlight</b>                  OD: 6-3/8" [162mm]                  5054PS=Frosted Glass Dome, White Plastic Trim                  5054SNS=Frosted Glass Dome, Satin Nickel Plastic Trim                  5054TBZS=Frosted Glass Dome, Tuscan Bronze Plastic Trim</p> <p><b>5150 Frost Dome Glass Lens, Self-flange - Showerlight</b>                  OD: 6-3/8" [162mm]                  5150WH=Frost Dome Glass Lens with Reflector, White Plastic Trim                  5150SN=Frost Dome Glass Lens with Reflector, Satin Nickel Plastic Trim                  5150TBZ=Frost Dome Glass Lens with Reflector, Tuscan Bronze Plastic Trim</p> <p><b>5162 Drop Opal Plastic Lens, Self-flange - Showerlight</b>                  OD: 6-3/8" [162mm]                  5162WH=Drop Opal Plastic Lens with Reflector, White Plastic Trim</p>	<p><b>5230 Squirrel Frost Glass Lens, Metal Trim, Self-flange - Showerlight</b>                  OD: 6-3/4" [172mm]                  5230AH=Frost Glass Lens, Aluminum Haze Squirrel Trim                  5230PN=Frost Glass Lens, Polished Nickel Squirrel Trim                  5230AH=Frost Glass Lens, Satin Nickel Squirrel Trim                  5230AH=Frost Glass Lens, Tuscan Bronze Squirrel Trim</p> <p><b>5255 Soft Square, Frost Curve Glass Lens, Self-flange - Showerlight</b>                  OD: 6-3/4" [172mm]                  5255WH=Frost Curve Glass Lens with Reflector, White Plastic Trim                  5255SN=Frost Curve Glass Lens with Reflector, Satin Nickel Plastic Trim                  5230TBZ=Frost Curve Glass Lens with Reflector, Tuscan Bronze Plastic Trim</p> <p><b>5145 Open Wet Location, Shallow Reflector, Self-flange - Showerlight*</b>                  OD: 6-3/4" [172mm]                  5145WH=White Reflector and Trim                  5145SN=Satin Nickel Reflector and Trim                  5145TBZ=Tuscan Bronze Reflector and Trim</p> <p><b>5146 Open Wet Location, Full Reflector, Self-flange - Showerlight*</b>                  OD: 6-3/4" [172mm]                  5146WH=White Reflector and Trim                  5146SN=Satin Nickel Reflector and Trim                  5146TBZ=Tuscan Bronze Reflector and Trim</p> <p><b>Open, Splay &amp; Wall Wash</b></p> <p><b>5000 PAR Metal Splay, Self-flange</b>                  OD: 6-3/8" [162mm]                  5000P=White Splay and Trim                  5000SN=Satin Nickel Splay and Trim                  5000TBZ=Tuscan Bronze Splay and Trim</p> <p><b>5176 Open, Wide with Fixed Socket Bracket, Self-flange</b>                  OD: 6-3/8" [162mm]                  5176WH=White Trim                  5176SN=Satin Nickel Trim                  5176TBZ=Tuscan Bronze Trim</p> <p><b>5186 Splay with Fixed Socket Bracket, Self-flange</b>                  OD: 6-3/8" [162mm]                  5186WH=White Trim                  5186SN=Satin Nickel Trim                  5186TBZ=Tuscan Bronze Trim</p>
--	---	--

\*Outdoor rated lamp only (purchase separately)



LISTED  
 For use in Halo listed housings.



Select trims are classified for use in others housings.  
 See www.eaton.com/lighting/legal.