



ACULUX® RECESSED DOWNLIGHT

6" VERTICAL CFL, BAFFLED APERTURE

IC Rated, One 26W or 32W Triple Tube

ICV6-126/32T-601 SERIES

Project: _____

Fixture Type: _____

Location: _____

Contact/Phone: _____

PRODUCT SPECIFICATIONS

Lamp One 26W or 32W triple tube compact fluorescent lamp CFTR26W/GX24q-3 or CFTR32W/GX24q-3 • 4 pin electronic.

Socket Housing Single-position, keyed toolless reflector attachment.

Ballast 120V HPF Electronic with end-of-life lamp protection
• U.L. listed/CSA certified.

Trim Ring White Polycarbonate.

Reflector .050" aluminum reflector with clear specular Alzak® finish.

Baffle Matte black or white, grooved aluminum baffle.

Labels U.L. listed for direct contact with insulation, through-branch wiring and damp locations • Meets Washington State Air Tight Requirements, 1995 CABO Model Energy Code
• Complies with FCC Part 18 consumer use limits • Product mechanically protected against improper use of lamps • Union made • CSA certified.

Testing All reports are based on published industry procedures; field performance may differ from laboratory performance.

Product specifications subject to change without notice.

DIMENSIONS

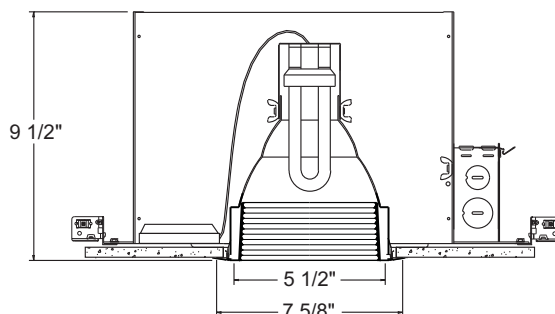
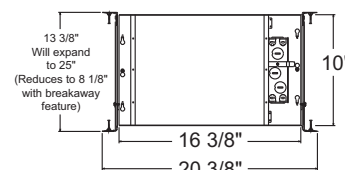

6 7/8" CEILING CUTOUT

INSTALLATION

Real Nail 3 Bar Hangers Telescoping, patent-pending Real Nail 3 system permits quick placement of housing anywhere within 24" O.C. joists or suspended ceilings • Integral T-bar notch and clip secures housing in suspended ceiling grid – no accessory clips required • 24" expansion stop allows quick placement of fixture in standard grid spacing • Bars scored in two locations for fast, clean breaking, allowing housing installation in tight applications
• Bars captive to mounting frame • Edge-mounted for extra strength • Captive bugle-headed ring shank nail for quick one-step installation and easy removal with claw hammer for fixture relocation • Quick-Loc slot and oversized locking set screw lock fixture in position • Bar hanger foot contoured to align to bottom of construction joist • Alternate mounting holes included.

Junction Box Pre-wired junction box, U.L. listed/CSA certified for through-branch wiring, maximum 8 No. 12 AWG 90° C branch circuit conductors (4 in, 4 out) • Junction box provided with removable access plates (5) 1/2" and (1) 3/4" knockouts, (4) Non-metallic sheathed cable knock-outs with built-in strain reliefs and ground wire • Knockouts equipped with pryout slots.

Housing/Mounting Frame 20-gauge die-formed galvanized steel plaster frame • .032" die-formed aluminum housing
• Rough-in section (junction box, mounting frame, housing assembly, ballast and bar hangers) fully assembled for ease of installation.

PRODUCT CODES

Catalog Number	Trim	Ballast	Wattage and Lamp
ICV6-126/32T-601B-WH	Black Baffle/Clear Alzak	HPF 120V Elect.	26W or 32W Triple Tube CFL
ICV6-126/32T-601W-WH	White Baffle/Clear Alzak	HPF 120V Elect.	26W or 32W Triple Tube CFL

ENGINEERING DATA

120V-HPF 26W/32W	
Total input power	28W/35W
Operating AMPS	.23A/.29A
Power Factor	>.98
T.H.D.	<10%
Min. starting temperature	0°F/ -18°C
Crest Factor	<1.65
Ballast Factor	>.98

OPTIONS

(Add as suffix to housing or trim)

Catalog No. Description

DB 120 120V Dimming Ballast

Ordering Example: ICV6-126/32T-DB120-600

PHOTOMETRIC REPORT

Test Report #: LTL02495P

Catalog No: ICV6-126/32T-601B-WH

Total Luminaire Efficiency: 48.0%

Luminaire Spacing Criterion: 1.1

Luminaire: Recessed Black Baffled Aperture Downlight

Lamp: One 32W Triple Tube CFL lamp rated @ 2400 lumens

ACULUX® RECESSED DOWNLIGHT

6" VERTICAL CFL, BAFFLED APERTURE

IC Rated, One 26W or 32W Triple Tube

ICV6-126/32T-601 SERIES

CANDLEPOWER DISTRIBUTION (Candelas)

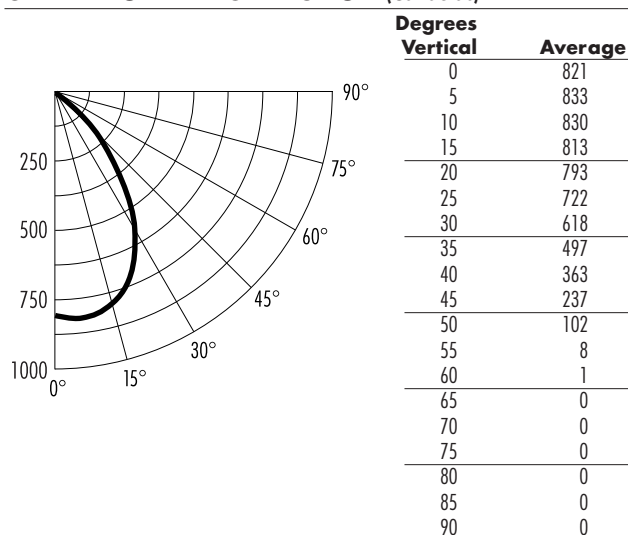

*Multipliers: 26W - 0.75, White Baffle - 1.10

LUMINANCE
(Average cd/m²)

Degrees	Average Luminance
45	16,304
55	678
65	0
75	0
85	0

ZONAL LUMEN
SUMMARY

Zone	Lumens	%Lamp	%Fixture
0-30°	639	27	56
0-40°	946	40	82
0-60°	1147	48	100
0-90°	1147	48	100
90-180°	0	0	0
0-180°	1147	48	100

COEFFICIENTS OF UTILIZATION – % (Zonal Cavity Method) Effective Floor Cavity Reflectance 20% (ρ_{fc})

RCR	ρ_{cc} ρ_w	80			70			50			30			10			0
		50	30	10	50	30	10	50	30	10	50	30	10	50	30	10	0
0		57	57	57	56	56	56	53	53	53	51	51	51	49	49	49	48
1		53	51	50	52	51	50	50	49	48	48	47	47	46	46	45	44
2		49	47	45	48	46	44	46	45	43	45	43	42	43	42	41	41
3		45	42	40	44	42	40	43	41	39	42	40	39	41	39	38	37
4		41	38	36	41	38	36	40	37	36	39	37	35	38	36	35	34
5		38	35	33	38	35	33	37	34	33	36	34	32	35	33	32	31
6		36	32	30	35	32	30	34	32	30	34	31	30	33	31	29	29
7		33	30	28	33	30	28	32	29	27	31	29	27	31	29	27	26
8		31	28	26	31	28	25	30	27	25	29	27	25	29	27	25	24
9		29	26	24	29	26	24	28	25	23	28	25	23	27	25	23	23
10		27	24	22	27	24	22	26	24	22	26	24	22	26	23	22	21

 ρ_{cc} – Ceiling Cavity Reflectance (%) ρ_w – Wall Reflectance (%)

INITIAL FOOTCANDLES

One Unit, 32 Watt, 79° Beam

Footcandles Beam Edge	Footcandles Beam Center	Beam Diameter	Distance to Illuminated Plane (Feet)
5.2	22.8	9.9'	6
2.9	12.8	13.2'	8
1.9	8.2	16.5'	10
1.3	5.7	19.8'	12
1.0	4.1	23.1'	14
0.7	3.2	26.4'	16
0.6	2.5	29.7'	18
0.5	2.1	33.0'	20

(Beam Edge defined as 50% of Maximum Nadir Candlepower)

AVERAGE INITIAL FOOTCANDLES

Multiple Units (Square Array)

Ceiling 80% Wall 50% Floor 20%			
Spacing	RCR1	RCR4	RCR8
5.0'	51	39	30
6.0'	35	27	21
7.0'	26	20	15
8.0'	20	15	12
9.0'	16	12	9
10.0'	13	10	7
12.0'	9	7	5

*Note: Multipliers are provided for estimating purposes only. Use IES photometric files for precise photometric information.



1300 S. Wolf Road • Des Plaines, IL 60018 • Phone (847) 827-9880 • Fax (847) 827-2925
 220 Chrysler Drive • Brampton, Ontario • Canada L6S 6B6 • Phone (905) 792-7335 • Fax (905) 792-0064
 Visit us at www.junolightinggroup.com

Printed in U.S.A. ©2010 Juno Lighting, LLC.