



# 6" VERTICAL CFL WALL WASH

OPEN APERTURE

One 26W or 32W Triple Tube

**CV6-126/32T-600C-WWS**

Project: \_\_\_\_\_

Fixture Type: \_\_\_\_\_

Location: \_\_\_\_\_

Contact/Phone: \_\_\_\_\_

## PRODUCT SPECIFICATIONS

**Lamp** One 26W or 32W triple tube compact fluorescent lamp CFTR26W/GX24q-3 or CFTR32W/GX24q-3 • 4 pin electronic.

**Socket Housing** Vented, extruded aluminum housing with heat dissipating fins • Single-position, keyed reflector attachment.

**Ballast** 120V thru 277V HPF Electronic with end-of-life lamp protection • 347V HPF Electronic available in Canada • U.L. listed/CSA certified.

**Reflector** .050" aluminum reflector in low iridescent clear Alzak® finish with 90° cut-out and diffuse wall wash kicker reflector • Other finishes including wheat, straw, haze and pewter available on special order basis.

**Trim Ring** White Polycarbonate.

**Labels** U.L. listed for through branch wiring and damp locations • Union made • CSA certified.

**Testing** All reports are based on published industry procedures; field performance may differ from laboratory performance.

Product specifications subject to change without notice.

## DIMENSIONS



Single

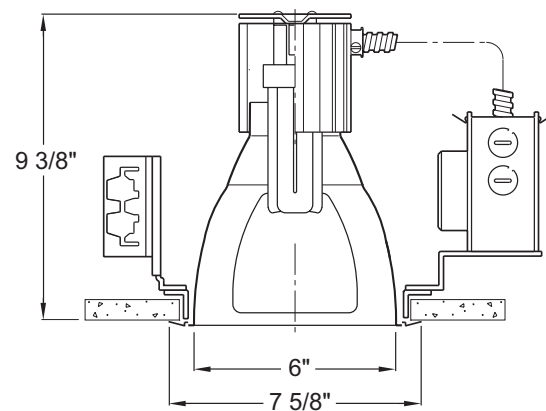
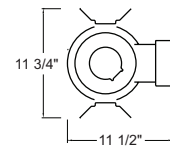

6 7/8" CEILING CUTOUT

## INSTALLATION

**Mounting Bracket** Rough-in section equipped with vertically adjustable mounting brackets (up to 3") that accept 1/2" conduit or "C" channels (HB-26 or HB-50), linear flat bars (LB-27) or Real Nail® 3 bar hangers (HB-1).

**Junction Box** Pre-wired junction box provided with (5) 1/2" and (1) 3/4" knockouts, U.L. listed/CSA certified for through branch wiring, maximum 8 No. 12 AWG 90°C branch circuit conductors (4 in, 4 out) • Junction box provided with removable access plates • Knockouts equipped with pryout slots.

**Mounting Frame** 16-gauge galvanized steel mounting ring with factory installed reflector mounting clips • Rough-in section (junction box, mounting frame and socket assembly) fully assembled for ease of installation • Accommodates 7/8" ceiling thickness maximum.

## ENGINEERING DATA

	120V-HPF/32W	277V-HPF/32W	347V-HPF/ 32W Canada
Total input power	36W	36W	37W
Operating AMPS	.30A	.13A	.11A
Power Factor	>.98	>.98	>.98
T.H.D.	<10%	<10%	<10%
Min. starting temperature	0°F/ -18°C	0°F/ -18°C	0°F/ -18°C
Crest Factor	<1.65	<1.65	<1.65
Ballast Factor	.98	.98	1.00

## ACCESSORIES

Catalog No.	Description
<b>HB-26</b>	Two 26" C-channel bar hangers
<b>HB-50</b>	Two 50" C-channel bar hangers
<b>HB-1</b>	Two 13 1/2" - 25" Real Nail® 3 bar hangers
<b>LB-27</b>	Two 27" linear bar hangers
<b>PLK-E</b>	13-42W emerg. power kit (Elect. Ballast)

To order, specify catalog number.

## PRODUCT CODES

Catalog Number	Cut-Out	Reflector Finish	Ballast	Wattage and Lamp
<b>CV6-126/32T-600C-WWS-WH</b>	Single	Low Iridescent Clear Alzak	HPF 120V - 277V Elect.	26W or 32W Triple Tube CFL

## OPTIONS

(Add as suffix to housing or trim)

Catalog No.	Description
<b>347</b>	347V, HPF Electronic Ballast
<b>DB120</b>	120V Dimming Ballast
<b>DB277</b>	277V Dimming Ballast

For 347 or DB120 or DB277, specify wattage.

Ordering Example:







CV6-126/32T-347-600C-WWS

**PHOTOMETRIC REPORT****Test Report #:** PT04990610**Catalog No:** CV6-126/32T-600C-WWS-WH**Luminaire:** Recessed Single Cut-Out Wall Wash**Lamp:** One 26W Triple Tube CFL lamp rated @ 1800 lumens**6" VERTICAL CFL WALL WASH**

OPEN APERTURE

One 26W or 32W Triple Tube

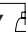
**CV6-126/32T-600C-WWS****FOOTCANDLES ON WALL FROM MULTIPLE FIXTURES**

Fixture Distance to Wall		2'			3'								
		 2'	 2'	 2'	 3'	 3'	 3'						
DISTANCE FROM CEILING	1'	11	10	11	8	8	8	4	4	4	3	3	3
	2'	39	34	39	26	29	26	11	11	11	9	8	9
	3'	36	34	36	23	24	23	18	18	18	14	13	14
	4'	31	32	31	21	21	21	16	16	16	12	12	12
	5'	27	28	27	18	18	18	16	16	16	12	12	12
	6'	23	24	23	15	15	15	15	15	15	11	11	11
	7'	20	20	20	12	12	12	13	13	13	10	10	10
	8'	17	18	17	11	11	11	12	12	12	9	9	9
	9'	14	14	14	10	10	10	11	11	11	8	8	8

Multiplier: 32W - 1.33

\*Note: Multipliers are provided for estimating purposes only. Use IES photometric files for precise photometric information.