



RECESSED REMODEL ADJUSTABLE

1 3/4" SLOT APERTURE

TC Rated, 50W MR16

TC43NR, 4345N TRIM

PRODUCT DESCRIPTION

Recessed adjustable MR16 remodel luminaire with 1 3/4" by 2 1/2" slot aperture. Fixture has 50° visual cutoff to lamp and lamp image. Low profile TC housing is for use in non-insulated areas, or where insulation is spaced at least 3" from housing. Installs quickly and securely with patented (US Patent 7,191,993) push-pull cable system through ceiling opening.

PRODUCT SPECIFICATIONS

Reflector .040" aluminum angle-cut reflector in black Alzak finish shields housing interior.

Trims Style Trims utilize torsion spring retention for tight, secure fit to ceiling • Trim ring features beveled knife edge for clean ceiling interface.

Lens Lampholder accommodates up to three (3) 2" captive accessory lenses • Supplied with stippled clear uniformity lens.

Socket Ceramic bi-pin socket with double blade nickel alloy contacts and aluminum heat shield.

Lamp One 50W MR16 lamp.

Adjustability Optimized lamp beam optics insures maximum light output and low brightness at any angle • 361° rotation (350° with mechanism, up to 18° additional with rotation of housing assembly) and 35° tilt hot aiming • Black adjustment mechanism preserves dark aperture.

Transformer 120 V thermally protected magnetic transformer is serviceable from below ceiling • High efficiency (>95%), high power factor electronic transformer also available.

Dimming May be dimmed using dimmers specifically designed for low voltage magnetic or electronic transformers; consult factory or dimmer manufacturer for additional information.

Codes/Labels UL and cUL listed for through branch wiring, damp locations • Product thermally protected • Union made.

Patented (US Patent 7,191,993) "Push-Pull" Cable System Allows rapid installation without tools or loose parts • Template included for accurate ceiling cutout • Housing accommodates ceiling thickness from 3/8" to 2" without altering photometrics • Fits 2 x 6 construction.

Junction Box Rated for 4 No. 12 AWG 90° C through branch circuit conductors and includes (3) 1/2", and (2) Non-metallic sheathed cable knock-outs • Push-in electrical connectors for field connections.

Housing/Mounting Frame Galvanized steel plaster frame. Housing painted black for visually dark interior • Packaged for ease of rapid installation.

Project: _____

Fixture Type: _____

Location: _____

Contact/Phone: _____



DIMENSIONS

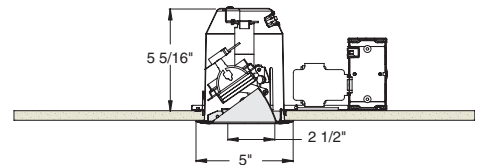
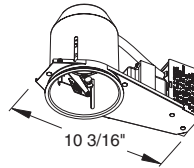

4 7/16" CEILING CUTOUT

Housings

Catalog #	Description
TC43NR	Low Voltage Adj. Recessed Magnetic Transformer, 120V
TC43NR-E1	Low Voltage Adj. Recessed Electronic Transformer, 120V

Accessories

Cat. #	Description	Cat. #	Description
T741	Med. Pink Color Filter	T7405	Yellow Dichroic Lens
T742	Warm Red Color Filter	T7406	Magenta Dichroic Lens
T743	Daylight Blue Color Filter	T7411	Blue Green Dichroic Lens
T744	Med. Blue Color Filter	T7416	Daylight Blue Correction Lens
T745	Med. Amber Color Filter	T7420	Diffuse Spread Lens
T746	Med. Green Color Filter	T7422	UV Filter Lens
T7401	Red Dichroic Lens	T7477	Prismatic Lens
T7403	Med. Green Dichroic Lens	T7478	Linear Spread Lens
T7404	Med. Blue Dichroic Lens	T7459BL	Hexcell Louver

To order, specify catalog number.

Slot Adjustable Pinhole

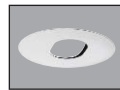

Trim Ring	Description
4345N-WH	White Trim Ring

RECESSED REMODEL ADJUSTABLE

1 3/4" SLOT APERTURE

TC Rated, 50W MR16

TC43NR, 4345N TRIM

CBCP • Centerbeam candlepower
FC • Footcandles at beam center (aim point)

In vertical aiming applications, aim point (X) is determined by dividing distance from the wall (D) by the tangent of the desired aim angle (A) (0.5774 for 30°, 1.0 for 45°).

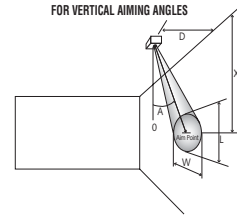
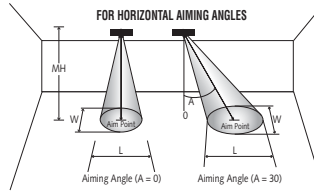

Horizontal Aiming Angles

Vertical Aiming Angles



Lamp	Beam Type	Beam Spread°	Rated Life	CBCP	0°		30°			30°						
					MH	FC	L	W	FC	L	W	D	FC	X	L	W
35W MR16 Halogen	NSP	10°	4000	9100	6	253	1.0	1.0	164	1.4	1.2	3	126	5.2	2.1	1.0
					8	142	1.4	1.4	92	1.9	1.6	4	71	6.9	2.9	1.4
					10	91	1.7	1.7	59	2.3	2.0	5	46	8.7	3.6	1.7
					12	63	2.1	2.1	41	2.8	2.4	6	32	10.4	4.3	2.1
	FL	35°	4000	1500	4	94	2.5	2.5	61	3.5	2.9	2	47	3.5	7.2	2.5
					6	42	3.8	3.8	27	5.2	4.4	3	21	5.2	10.8	3.8
					8	23	5.0	5.0	15	7.0	5.8	4	12	6.9	14.4	5.0
					10	15	6.3	6.3	10	8.7	7.3	5	8	8.7	18.0	6.3
	NFL	25°	5000	4400	4	275	1.8	1.8	179	2.4	2.0	2	138	3.5	4.2	1.8
					6	122	2.7	2.7	79	3.6	3.1	3	61	5.2	6.2	2.7
					8	69	3.5	3.5	45	4.8	4.1	4	34	6.9	8.3	3.5
					10	44	4.4	4.4	29	6.0	5.1	5	22	8.7	10.4	4.4
FL	35°	5000	2200	3	244	1.9	1.9	159	2.6	2.2	2	69	3.5	7.2	2.5	
				4	138	2.5	2.5	89	3.5	2.9	3	31	5.2	10.8	3.8	
				6	61	3.8	3.8	40	5.2	4.4	4	17	6.9	14.4	5.0	
				8	34	5.0	5.0	22	7.0	5.8	5	11	8.7	18.0	6.3	
42W MR16 Halogen	VNSP	9°	3500	12300	8	192	1.3	1.3	125	1.7	1.5	4	96	6.9	2.6	1.3
					10	123	1.6	1.6	80	2.1	1.8	5	62	8.7	3.2	1.6
					12	85	1.9	1.9	55	2.5	2.2	6	43	10.4	3.8	1.9
					14	63	2.2	2.2	41	2.9	2.5	7	31	12.1	4.5	2.2
	NFL	25°	6000	9100	6	253	1.6	1.6	164	2.1	1.8	3	126	5.2	3.3	1.6
					8	142	2.1	2.1	92	2.8	2.4	4	71	6.9	4.4	2.1
					10	91	2.6	2.6	59	3.5	3.0	5	46	8.7	5.6	2.6
					12	63	3.2	3.2	41	4.2	3.6	6	32	10.4	6.7	3.2
FL	40°	6000	1700	3	189	2.2	2.2	123	3.0	2.5	2	53	3.5	9.7	2.9	
				4	106	2.9	2.9	69	4.1	3.4	3	24	5.2	14.5	4.4	
				6	47	4.4	4.4	31	6.1	5.0	4	13	6.9	19.3	5.8	
				8	27	5.8	5.8	17	8.1	6.7	5	9	8.7	24.2	7.3	
NFL	25°	6000	3200	4	200	1.8	1.8	130	2.4	2.0	2	100	3.5	4.2	1.8	
				6	89	2.7	2.7	58	3.6	3.1	3	44	5.2	6.2	2.7	
				8	50	3.5	3.5	32	4.8	4.1	4	25	6.9	8.3	3.5	
				10	32	4.4	4.4	21	6.0	5.1	5	16	8.7	10.4	4.4	
FL	40°	6000	1700	3	189	2.2	2.2	123	3.0	2.5	2	53	3.5	9.7	2.9	
				4	106	2.9	2.9	69	4.1	3.4	3	24	5.2	14.5	4.4	
				6	47	4.4	4.4	31	6.1	5.0	4	13	6.9	19.3	5.8	
				8	27	5.8	5.8	17	8.1	6.7	5	9	8.7	24.2	7.3	
NFL	25°	6000	3200	4	200	1.8	1.8	130	2.4	2.0	2	100	3.5	4.2	1.8	
				6	89	2.7	2.7	58	3.6	3.1	3	44	5.2	6.2	2.7	
				8	50	3.5	3.5	32	4.8	4.1	4	25	6.9	8.3	3.5	
				10	32	4.4	4.4	21	6.0	5.1	5	16	8.7	10.4	4.4	
FL	40°	6000	1700	3	189	2.2	2.2	123	3.0	2.5	2	53	3.5	9.7	2.9	
				4	106	2.9	2.9	69	4.1	3.4	3	24	5.2	14.5	4.4	
				6	47	4.4	4.4	31	6.1	5.0	4	13	6.9	19.3	5.8	
				8	27	5.8	5.8	17	8.1	6.7	5	9	8.7	24.2	7.3	
NFL	25°	6000	3200	4	200	1.8	1.8	130	2.4	2.0	2	100	3.5	4.2	1.8	
				6	89	2.7	2.7	58	3.6	3.1	3	44	5.2	6.2	2.7	
				8	50	3.5	3.5	32	4.8	4.1	4	25	6.9	8.3	3.5	
				10	32	4.4	4.4	21	6.0	5.1	5	16	8.7	10.4	4.4	
FL	40°	6000	1700	3	189	2.2	2.2	123	3.0	2.5	2	53	3.5	9.7	2.9	
				4	106	2.9	2.9	69	4.1	3.4	3	24	5.2	14.5	4.4	
				6	47	4.4	4.4	31	6.1	5.0	4	13	6.9	19.3	5.8	
				8	27	5.8	5.8	17	8.1	6.7	5	9	8.7	24.2	7.3	
NFL	25°	6000	3200	4	200	1.8	1.8	130	2.4	2.0	2	100	3.5	4.2	1.8	
				6	89	2.7	2.7	58	3.6	3.1	3	44	5.2	6.2	2.7	
				8	50	3.5	3.5	32	4.8	4.1	4	25	6.9	8.3	3.5	
				10	32	4.4	4.4	21	6.0	5.1	5	16	8.7	10.4	4.4	
FL	40°	6000	1700	3	189	2.2	2.2	123	3.0	2.5	2	53	3.5	9.7	2.9	
				4	106	2.9	2.9	69	4.1	3.4	3	24	5.2	14.5	4.4	
				6	47	4.4	4.4	31	6.1	5.0	4	13	6.9	19.3	5.8	
				8	27	5.8	5.8	17	8.1	6.7	5	9	8.7	24.2	7.3	
NFL	25°	6000	3200	4	200	1.8	1.8	130	2.4	2.0	2	100	3.5	4.2	1.8	
				6	89	2.7	2.7	58	3.6	3.1	3	44	5.2	6.2	2.7	
				8	50	3.5	3.5	32	4.8	4.1	4	25	6.9	8.3	3.5	
				10	32	4.4	4.4	21	6.0	5.1	5	16	8.7	10.4	4.4	
FL	40°	6000	1700	3	189	2.2	2.2	123	3.0	2.5	2	53	3.5	9.7	2.9	
				4	106	2.9	2.9	69	4.1	3.4	3	24	5.2	14.5	4.4	
				6	47	4.4	4.4	31	6.1	5.0	4	13	6.9	19.3	5.8	
				8	27	5.8	5.8	17	8.1	6.7	5	9	8.7	24.2	7.3	
NFL	25°	6000	3200	4	200	1.8	1.8	130	2.4	2.0	2	100	3.5	4.2	1.8	
				6	89	2.7	2.7	58	3.6	3.1	3	44	5.2	6.2	2.7	
				8	50	3.5	3.5	32	4.8	4.1	4	25	6.9	8.3	3.5	
				10	32	4.4	4.4	21	6.0	5.1	5	16	8.7	10.4	4.4	
FL	40°	6000	1700	3	189	2.2	2.2	123	3.0	2.5	2	53	3.5	9.7	2.9	
				4	106	2.9	2.9	69	4.1	3.4	3	24	5.2	14.5	4.4	
				6	47	4.4	4.4	31	6.1	5.0	4	13	6.9	19.3	5.8	
				8	27	5.8	5.8	17	8.1	6.7	5	9	8.7	24.2	7.3	
NFL	25°	6000	3200	4	200	1.8	1.8	130	2.4	2.0	2	100	3.5	4.2	1.8	
				6	89	2.7	2.7	58	3.6	3.1	3	44	5.2	6.2	2.7	
				8	50	3.5	3.5	32	4.8	4.1	4	25	6.9	8.3	3.5	
				10	32	4.4	4.4	21	6.0	5.1	5	16	8.7	10.4	4.4	
FL	40°	6000	1700	3	189	2.2	2.2	123	3.0	2.5	2	53	3.5	9.7	2.9	
				4	106	2.9	2.9	69	4.1	3.4	3	24	5.2	14.5	4.4	
				6	47	4.4	4.4	31	6.1	5.0	4	13	6.9	19.3	5.8	
				8	27	5.8	5.8	17	8.1	6.7	5	9	8.7	24.2	7.3	
NFL	25°	6000	3200	4	200	1.8	1.8	130	2.4	2.0	2	100	3.5	4.2	1.8	
				6	89	2.7	2.7	58	3.6	3.1	3	44	5.2	6.2	2.7	
				8	50	3.5	3.5	32	4.8	4.1	4	25	6.9	8.3	3.5	
				10	32	4.4	4.4	21	6.0	5.1	5	16	8.7	10.4	4.4	
FL	40°	6000	1700	3	189	2.2	2.2	123	3.0	2.5	2	53	3.5	9.7	2.9	
				4	106	2.9	2.9	69	4.1	3.4	3	24	5.2	14.5	4.4	
				6	47	4.4	4.4	31	6.1	5.0	4	13	6.9	19.3	5.8	
				8	27	5.8	5.8	17	8.1	6.7	5	9	8.7	24.2	7.3	
NFL	25°	6000	3200	4	200	1.8	1.8	130	2.4	2.0	2	100	3.5	4.2	1.8	
				6	89	2.7	2.7	58	3.6	3.1	3	44	5.2	6.2	2.7	
				8	50	3.5	3.5	32	4.8	4.1	4	25	6.9	8.3	3.5	
				10	32	4.4	4.4	21	6.0	5.1	5	16	8.7	10.4	4.4	
FL	40°	6000	1700	3	189	2.2	2.2	123	3.0	2.5	2	53	3.5	9.7	2.9	
				4	106	2.9	2.9	69	4.1	3.4	3	24	5.2	14.5	4.4	
				6	47	4.4	4.4	31	6.1	5.0	4	13	6.9	19.3	5.8	
				8	27	5.8	5.8	17	8.1	6.7	5	9	8.7	24.2	7.3	
NFL	25°	6000	3200	4	200	1.8	1.8	130	2.4	2.0	2	100	3.5	4.2	1.8	
				6	89	2.7	2.7	58	3.6	3.1	3	44	5.2	6.2	2.7	
				8	50	3.5	3.5	32	4.8	4.1	4	25	6.9	8.3	3.5	
				10</												