

JUNO® AVIO™ Trac Fixtures

Installation Instructions

Important Safety Instructions-Save These Instructions

For Juno AVIO Trac Fixtures

Read all of these instructions before installing the trac fixtures.

Do not install these fixtures in damp or wet locations.

Do not install any fixture assembly closer than 6" from any curtain or similar combustible material.

Disconnect electrical power to trac before adding, removing, or relamping fixtures.

To reduce the risk of fire and burns, allow the lamp to cool before removing from fixture.

Save these instructions and refer to them when additions or changes to the trac configuration are made.

AVIO Line Voltage Trac Fixtures Installation & Removal From Trac

Caution: AVIO Fixtures are for use with Juno T, TU, R, or V series trac systems only.

Polarity Information:

All Juno Trac sections have an embossed line (fig.1) that indicates Trac polarity. All Juno Trac fixture adapters have raised arrows (fig. 2) that point to the polarity line when they are installed on the Trac section. A label indicating polarity direction is located inside the fixture canopy (see fig. 5 on the reverse side of this sheet for a diagram).

Single Circuit Trac:

- Before attaching the fixture to the trac, rotate both trac adapters so that both trac adapters are 180° from the polarity label as shown in fig. 5 (see pg. 2). Power to the trac should be off.
- To attach fixture, insert "Adapter Contacts" (fig. 2) into Trac channel.
- Rotate powered adapter (powered side has a switch on it) 1/4 turn (90°) so that the polarity arrows point at the polarity line on the Trac.
- Rotate second adapter 90° into trac.
- Trac-Master fixtures have an on-off switch. Switch fixture to "on" by flipping adapter switch away from the polarity adapters as shown in fig.2.
- If the fixture does not sit level after installation, loosen the disc screw, level the fixture by sliding the disc assembly up or down along the cables. Retighten the disc screw (see fig. 6 on pg. 2).

NOTE: To uninstall fixture, turn power off, then pull the powered side locking lever (on adapter) down, and then turn 90°(counter clockwise). Next pull the non-powered locking lever (on adapter) down, and then turn 90°(clockwise).

Two Circuit Trac:

For Two Circuit installation, the "Positive Contact" (marked "P"- see fig. 3) must be in lower position for single circuit and in raised position for two circuit.

To Raise The Positive Contact:

- To install fixture on second (upper) circuit, raise "Positive Contact" by inserting a thin screwdriver under the contact and lifting upward (fig.3).
- Insert a "Contact Support" under the raised "Positive Contact" (fig. 4). These Positive Contact Supports are supplied with all Juno Two Circuit Trac sections.
- To attach fixture to Trac, proceed the same as with "Single Circuit Trac" attachment (step A above).

WARRANTY

Juno warrants that its products are free from defects in material and workmanship. Juno's obligation is expressly limited to repair or replacement, without charge, at Juno's factory after prior written return authorization has been granted. This warranty shall not apply to products which have been altered or repaired outside of Juno's factory. This warranty is in lieu of all other warranties, express or implied, and without limiting the generality of the foregoing phrase, excludes any implied warranty of merchantability. Also, there are no warranties which extend beyond the description of the product on the company's literature setting forth terms of sale.

Product Services Phone (888) 387-2212

© 2003 Juno Printed in USA Juno lighting, inc 1300 S. Wolf Road Des Plaines, IL 60017 Visit us at www.junolighting.com Rev 08/03 P5033 pg 1 of 2

Figure 1

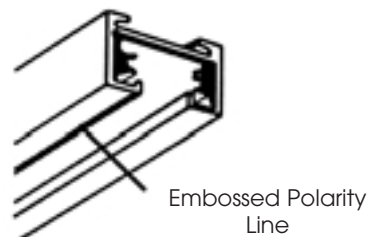

Figure 2

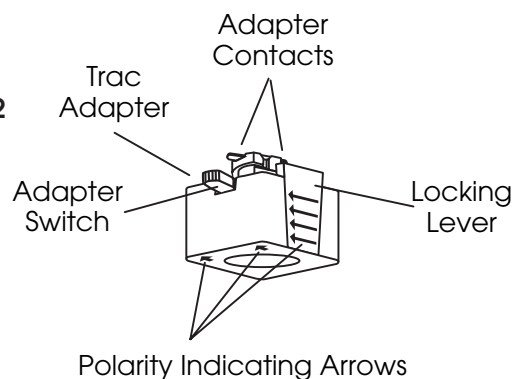

Figure 3

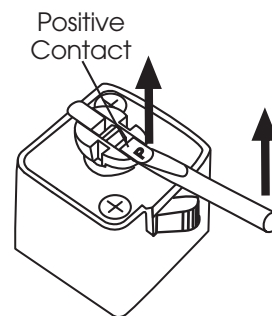
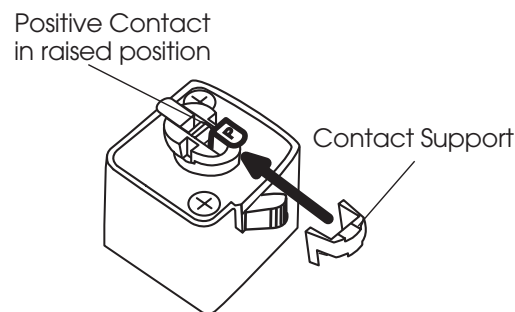

Figure 4



JUNO® AVIO™ Trac Fixtures

AVIO Installation Diagram

(parts below canopy removed for clarity)

Figure 5

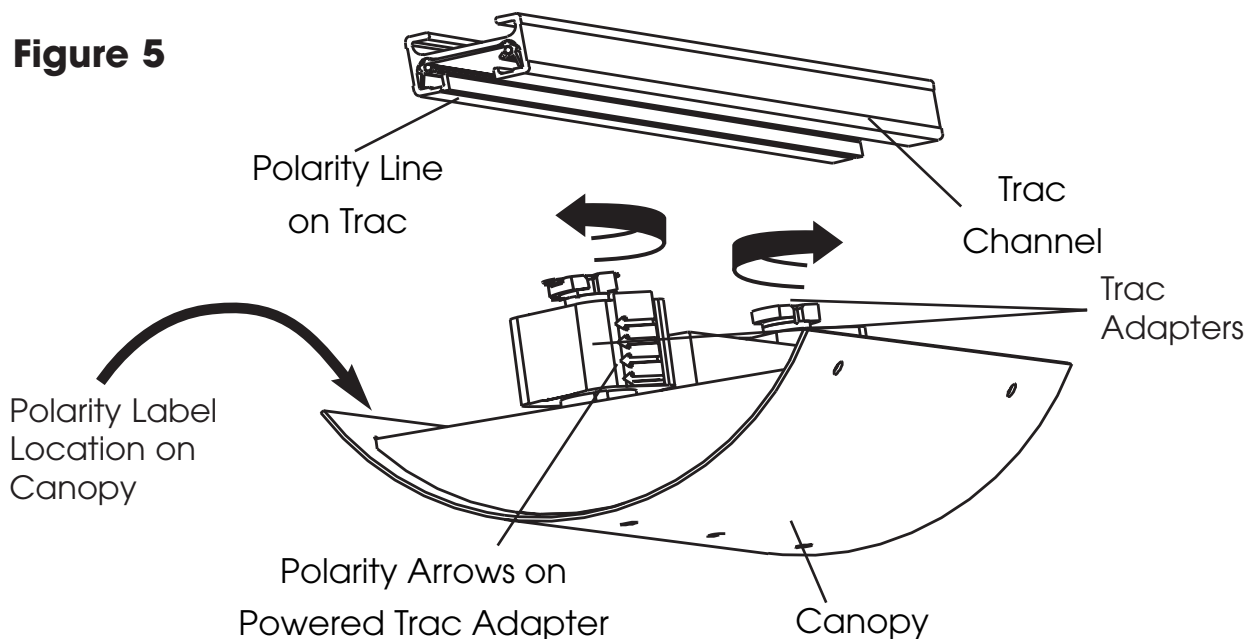

Cable Adjustment Diagram

(if required)

Figure 6

