

**Juno****TRAC-MASTER®**

Avant Garde

**CYLINDRA™ 22W LED****T253LED**

Project: \_\_\_\_\_

Fixture Type: \_\_\_\_\_

Location: \_\_\_\_\_

Contact/Phone: \_\_\_\_\_

**PRODUCT DESCRIPTION**

The Cylindra™ 22W LED approximates the light output and distribution of 75W PAR30 halogen lamps, utilizing less than 1/3 of the energy and having a rated life of 50,000 hours. Available in 2700K, 3000K and 4100K color temperatures, the white-light Cylindra LED is compatible with all Juno line voltage trac and monopoints. The contemporary styling of the Cylindra LED enables it to subtly enhance practically any decor without diverting attention from the surrounding environment. Soft curved surfaces combine with clean, crisp edges to provide a uniquely attractive aesthetic. Cylindra's integral, bayonet-mounted accessory holder accommodates up to two accessories if desired.

**Cylindra 22W LED**

**Construction** Die cast aluminum housing and custom designed concealed heat sink provides outstanding thermal management, yielding 70% average lumen maintenance at 50,000 hours of operation

- Fashionable, elegant design complements any decor
- Available in white, black and silver painted finishes.

**LED** Lumileds LUXEON Rebel LEDs provide outstanding reliability, performance and color quality/consistency • 2700K, 3000K or 4100K white phosphor high performance LEDs • High CRI of 85 typical.

**Driver** Concealed in rear housing to minimize overall fixture footprint • Solid state electronic, Class 2 compliant • Integral overcurrent and short circuit protection • Class B FCC Part 15 rated • Not rated for dimming.

**Optics** Available in three factory-configured beam spreads • Beam patterns can be altered as desired using a variety of available light control accessories.

**Adapter** Copper alloy contacts provide precise spring action - no arcing and will not take a set • True, positive electrical ground • On/off switch included • Patented embossed polarity arrows on bottom of adapter • Spring-loaded positive latch with embossed polarity arrows secures trac fixture to trac • "Pull-up" contact to up position for two-circuit application.

**Accessory Holder** Integral to fixture design • Die cast aluminum construction • Precision bayonet mounting • Accommodates up to two accessories if desired.

**Aiming** 360° horizontal coverage • 105° vertical aiming capability.

**Labels** UL and C-UL Listed • Energy Star qualified for 2700K and 3000K color temperatures.

**Warranty** Warranty period is 3-years from date of purchase • Standard Juno Lighting Group product guarantee terms and conditions apply.

Product specifications subject to change without notice.

LUXEON is a registered trademark of the Phillips Lumileds Lighting Company

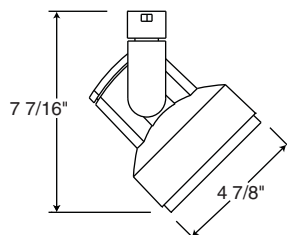

REV-10/6/10

**PRODUCT CODES**

Catalog Number	Finish	Color Temperature	Nominal Wattage	Beam Spread
T253LED-27K-SP-WH	White	2700K	22W	10° Spot
T253LED-27K-SP-BL	Black	2700K	22W	10° Spot
T253LED-27K-SP-SL	Silver	2700K	22W	10° Spot
T253LED-27K-NFL-WH	White	2700K	22W	23° Narrow Flood
T253LED-27K-NFL-BL	Black	2700K	22W	23° Narrow Flood
T253LED-27K-NFL-SL	Silver	2700K	22W	23° Narrow Flood
T253LED-27K-FL-WH	White	2700K	22W	53° Wide Flood
T253LED-27K-FL-BL	Black	2700K	22W	53° Wide Flood
T253LED-27K-FL-SL	Silver	2700K	22W	53° Wide Flood
T253LED-3K-SP-WH	White	3000K	22W	10° Spot
T253LED-3K-SP-BL	Black	3000K	22W	10° Spot
T253LED-3K-SP-SL	Silver	3000K	22W	10° Spot
T253LED-3K-NFL-WH	White	3000K	22W	23° Narrow Flood
T253LED-3K-NFL-BL	Black	3000K	22W	23° Narrow Flood
T253LED-3K-NFL-SL	Silver	3000K	22W	23° Narrow Flood
T253LED-3K-FL-WH	White	3000K	22W	53° Wide Flood
T253LED-3K-FL-BL	Black	3000K	22W	53° Wide Flood
T253LED-3K-FL-SL	Silver	3000K	22W	53° Wide Flood
T253LED-4K-SP-WH	White	4100K	22W	10° Spot
T253LED-4K-SP-BL	Black	4100K	22W	10° Spot
T253LED-4K-SP-SL	Silver	4100K	22W	10° Spot
T253LED-4K-NFL-WH	White	4100K	22W	23° Narrow Flood
T253LED-4K-NFL-BL	Black	4100K	22W	23° Narrow Flood
T253LED-4K-NFL-SL	Silver	4100K	22W	23° Narrow Flood
T253LED-4K-FL-WH	White	4100K	22W	53° Wide Flood
T253LED-4K-FL-BL	Black	4100K	22W	53° Wide Flood
T253LED-4K-FL-SL	Silver	4100K	22W	53° Wide Flood

**ACCESSORIES**

Cat. No.	Description	Cat. No.	Description
T569BL	Cube Cell Louver	T5621	Uniformity Lens
T561-6	Color Filters	T5677	Prismatic Spread Lens
T5618	Color Correction Filter <sup>1</sup>	T5678	Linear Spread Lens

See specification sheet D1.2.2 for details.

<sup>1</sup> T5618 corrects 3000K color to approximately 2700K and 4100K color to approximately 3500K.

# TRAC-MASTER®

## Avant Garde

### CYLINDRA™ 22W LED

#### T253LED

#### PERFORMANCE DATA<sup>1</sup>

Catalog Number	Input Voltage	Watts (Maximum)	Watts (Typical)	Lumens	Efficacy (LPW)	Rated Life (Hours)
T253LED-27K-SP	120V	25W	22.7W	919	41	50,000
T253LED-27K-NFL	120V	25W	22.7W	903	40	50,000
T253LED-27K-FL	120V	25W	22.7W	845	37	50,000
T253LED-3K-SP	120V	25W	22.7W	967	43	50,000
T253LED-3K-NFL	120V	25W	22.7W	950	42	50,000
T253LED-3K-FL	120V	25W	22.7W	889	39	50,000
T253LED-4K-SP	120V	25W	22.7W	1063	47	50,000
T253LED-4K-NFL	120V	25W	22.7W	1045	46	50,000
T253LED-4K-FL	120V	25W	22.7W	978	43	50,000

<sup>1</sup>Performance data, including Rated Life, is based on measurements of an individual fixture operating in a 25 °C ambient.

#### ELECTRICAL DATA

Input Voltage	120V
Input Current (max.)	0.2A
Power Factor	>0.92
T.H.D.	<20%

**CBCP** • Centerbeam candlepower  
**FC** • Footcandles at beam center (aim point)

In vertical aiming applications, aim point (X) is determined by dividing distance from the wall (D) by the tangent of the desired aim angle (A) (0.5774 for 30°, 1.0 for 45°, 1.732 for 60°).

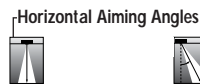
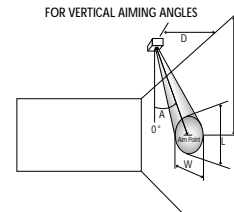
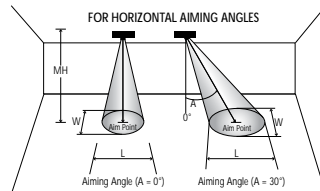

Lamp	Beam Type	Beam Spread°	Rated Life	CBCP	0°			30°			45°			60°											
					MH	FC	L	W	FC	L	W	D	FC	X	L	W	FC	X	L	W	D	FC	X	L	W
Cylindra 22W LED, 3000K Spot	SP	10°	50000	20688	8	323	1.4	1.4	210	1.9	1.6	4	162	6.9	2.9	1.4	457	4.0	1.4	1.0	6	373	3.5	1.4	1.2
					10	207	1.7	1.7	134	2.3	2.0	6	72	10.4	4.3	2.1	203	6.0	2.1	1.5	9	166	5.2	2.1	1.8
					12	144	2.1	2.1	93	2.8	2.4	8	40	13.9	5.7	2.8	114	8.0	2.8	2.0	12	93	6.9	2.8	2.4
					14	106	2.4	2.4	69	3.3	2.8	10	26	17.3	7.2	3.5	73	10.0	3.5	2.5	15	60	8.7	3.5	3.0
					16	81	2.8	2.8	52	3.7	3.2	12	18	20.8	8.6	4.2	51	12.0	4.2	3.0	18	41	10.4	4.2	3.6
Cylindra 22W LED, 3000K Narrow Flood	NFL	23°	50000	5119	4	320	1.6	1.6	208	2.2	1.9	2	160	3.5	3.7	1.6	452	2.0	1.7	1.2	4	208	2.3	2.2	1.9
					6	142	2.4	2.4	92	3.3	2.8	3	71	5.2	5.6	2.4	201	3.0	2.5	1.7	6	92	3.5	3.3	2.8
					8	80	3.3	3.3	52	4.4	3.8	4	40	6.9	7.4	3.3	113	4.0	3.4	2.3	8	52	4.6	4.4	3.8
					10	51	4.1	4.1	33	5.5	4.7	5	26	8.7	9.3	4.1	72	5.0	4.2	2.9	10	33	5.8	5.5	4.7
					12	36	4.9	4.9	23	6.6	5.6	6	18	10.4	11.2	4.9	50	6.0	5.1	3.5	12	23	6.9	6.6	5.6
Cylindra 22W LED, 3000K Wide Flood	WFL	53°	50000	1139	3	127	3.0	3.0	82	4.3	3.5	2	36	3.5	**	4.0	101	2.0	5.3	2.8	2	185	1.2	2.9	2.3
					4	71	4.0	4.0	46	5.8	4.6	3	16	5.2	**	6.0	45	3.0	8.0	4.2	3	82	1.7	4.3	3.5
					5	46	5.0	5.0	30	7.2	5.8	4	9	6.9	**	8.0	25	4.0	10.6	5.6	4	46	2.3	5.8	4.6
					6	32	6.0	6.0	21	8.7	6.9	5	6	8.7	**	10.0	16	5.0	13.3	7.1	5	30	2.9	7.2	5.8
					7	23	7.0	7.0	15	10.1	8.1	6	4	10.4	**	12.0	11	6.0	15.9	8.5	6	21	3.5	8.7	6.9

For 2700K fixtures, use 0.95 multiplier; for 4100K fixtures, use 1.11 multiplier.



1300 S. Wolf Road • Des Plaines, IL 60018 • Phone (847) 827-9880 • Fax (847) 827-2925  
 220 Chrysler Drive • Brampton, Ontario • Canada L6S 6B6 • Phone (905) 792-7335 • Fax (905) 792-0064  
 Visit us at [www.junolightinggroup.com](http://www.junolightinggroup.com)

Printed in U.S.A. ©2010 Juno Lighting, LLC.