



# TRAC 12

Miniature Low Voltage Trac System

**CONIX®**

**TL106**

Project: \_\_\_\_\_

Fixture Type: \_\_\_\_\_

Location: \_\_\_\_\_

Contact/Phone: \_\_\_\_\_

## PRODUCT DESCRIPTION

The sleek sculptured look and style of the Conix fixture is unparalleled in the industry. Its elegance is carried through the entire design for a fresh, contemporary appeal. Conix fixtures relamp from the front and have snap-in accessory holders. All can accommodate up to two accessories. Lampholders have integral vertical aiming locks.



### Low Voltage MR16 - Conix™

**Lamp** 20-50W MR16 lamps.

**Lens** Glass lens included with lampholder • May be used with up to two 1<sup>3</sup>/<sub>4</sub>" accessories simultaneously.

**Construction** Molded polycarbonate yoke • Die cast aluminum back housing  
• Formed steel front housing.

**Aiming** Greater than 360° horizontal rotation eliminates aiming dead spots  
• 90° vertical aiming capability • Vertical aiming locking screws secure lampholder position during relamping cycles.

**Socket** Ceramic bi-pin.

**Labels** UL listed, CSA certified.

Product specifications subject to change without notice.

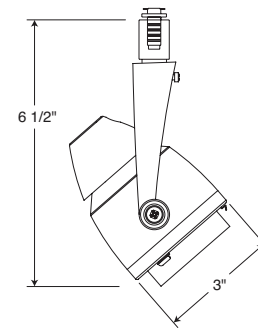

Catalog Number	Description	Finish	Lamp
TL106WH	Conix™	White	20-50W MR16, 12V or 24V
TL106BL	Conix™	Black	20-50W MR16, 12V or 24V
TL106SL	Conix™	Silver	20-50W MR16, 12V or 24V

### ACCESSORIES

Cat. No.	Description	Cat. No.	Description	Cat. No.	Description
T557	Prismatic Spread Lens	T559	Linear Spread Lens	T551-5	Color Filters
T5501-18	Dichroic Lenses	T5520	Diffuse Spread Lens	T5521	Uniformity Lens
T5522	UV Filter Lens	T5559BL	Hexcell Louver		

See specification sheet D1.2.2 for details.

# TRAC 12

Miniature Low Voltage Trac System

**CONIX®**

**TL106**

**CBCP** • Centerbeam candlepower  
**FC** • Footcandles at beam center (aim point)

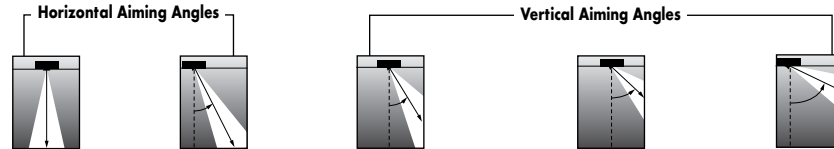

Lamp	Beam Type	Beam Spread°	Rated Life	CBCP	0°		30°			30°			45°				60°									
					MH	FC	L	W	FC	L	W	D	FC	X	L	W	FC	X	L	W	D	FC	X	L	W	
Q35W MR16	SP	20°	5000	3900	4	244	1.4	1.4	158	1.9	1.6	2	122	3.5	3.1	1.4	345	2.0	1.5	1.0	4	158	2.3	1.9	1.6	
					6	108	2.1	2.1	70	2.8	2.4	3	54	5.2	4.7	2.1	153	3.0	2.2	1.5	6	70	3.5	2.8	2.4	
					8	61	2.8	2.8	40	3.8	3.3	4	31	6.9	6.2	2.8	86	4.0	2.9	2.0	8	40	4.6	3.8	3.3	
					10	39	3.5	3.5	25	4.7	4.1	5	20	8.7	7.8	3.5	55	5.0	3.6	2.5	10	25	5.8	4.7	4.1	
					12	27	4.2	4.2	18	5.7	4.9	6	14	10.4	9.3	4.2	38	6.0	4.4	3.0	12	18	6.9	5.7	4.9	
					FL	40°	5000	1000	4	63	2.9	2.9	41	4.1	3.4	2	31	3.5	9.6	2.9	88	2.0	3.4	2.1	4	41
	6	28	4.4	4.4	18				6.1	5.0	3	14	5.2	14.5	4.4	39	3.0	5.0	3.1	6	18	3.5	6.1	5.0		
	8	16	5.8	5.8	10				8.1	6.7	4	8	6.9	19.3	5.8	22	4.0	6.7	4.1	8	10	4.6	8.1	6.7		
	10	10	7.3	7.3	6				10.2	8.4	5	5	8.7	24.1	7.3	14	5.0	8.4	5.1	10	6	5.8	10.2	8.4		
	12	7	8.7	8.7	5				12.2	10.1	6	3	10.4	**	8.7	10	6.0	10.1	6.2	12	5	6.9	12.2	10.1		
	Q50W MR16	NSP	15°	6000	9100				4	638	1.0	1.0	414	1.3	1.1	2	319	3.5	2.1	1.0	902	2.0	1.0	0.7	8	104
						6	283	1.5	1.5	184	2.0	1.7	3	142	5.2	3.1	1.5	401	3.0	1.5	1.0	10	66	5.8	3.3	2.8
8						159	2.0	2.0	104	2.6	2.3	4	80	6.9	4.1	2.0	225	4.0	2.0	1.4	12	46	6.9	3.9	3.4	
10						102	2.5	2.5	66	3.3	2.8	5	51	8.7	5.1	2.5	144	5.0	2.5	1.7	14	34	8.1	4.6	4.0	
12						71	2.9	2.9	46	3.9	3.4	6	35	10.4	6.2	2.9	100	6.0	3.0	2.1	16	26	9.2	5.3	4.5	
NFL						25°	6000	3200	4	213	1.9	1.9	138	2.6	2.2	2	106	3.5	4.6	1.9	301	2.0	2.0	1.4	4	138
6		94	2.9	2.9	61				3.9	3.3	3	47	5.2	7.0	2.9	134	3.0	3.1	2.0	6	61	3.5	3.9	3.3		
8		53	3.8	3.8	35				5.2	4.4	4	27	6.9	9.3	3.8	75	4.0	4.1	2.7	8	35	4.6	5.2	4.4		
10		34	4.8	4.8	22				6.5	5.5	5	17	8.7	11.6	4.8	48	5.0	5.1	3.4	10	22	5.8	6.5	5.5		
12		24	5.8	5.8	15				7.8	6.7	6	12	10.4	13.9	5.8	33	6.0	6.1	4.1	12	15	6.9	7.8	6.7		
FL		40°	6000	1700	4				116	2.9	2.9	75	4.1	3.4	2	58	3.5	9.6	2.9	164	2.0	3.4	2.1	4	75	2.3
6					51	4.4	4.4	33	6.1	5.0	3	26	5.2	14.5	4.4	73	3.0	5.0	3.1	6	33	3.5	6.1	5.0		
8	29				5.8	5.8	19	8.1	6.7	4	14	6.9	19.3	5.8	41	4.0	6.7	4.1	8	19	4.6	8.1	6.7			
10	19				7.3	7.3	12	10.2	8.4	5	9	8.7	24.1	7.3	26	5.0	8.4	5.1	10	12	5.8	10.2	8.4			
12	13				8.7	8.7	8	12.2	10.1	6	6	10.4	**	8.7	18	6.0	10.1	6.2	12	8	6.9	12.2	10.1			

The beam spread in degrees and the beam "L" and "W" in the following tables are computed at 50% of centerbeam candlepower and represent areas of "effective illumination."

For additional Lamp Data, reference Juno Lighting Product Guide.

\*\*Due to steep aiming angle, length of beam extends beyond 25'.

## 24V MR16 HALOGEN LAMPS WITH COVER GLASS

ANSI				
Cat. No.	Code	Watts	Description	Avg. Life (Hrs.)*
TL940-24V	-	35	Q35MR16/CG/NSP/24	1500
TL942-24V	-	35	Q35MR16/CG/NFL/24	1500
TL945-24V	-	50	Q50MR16/CG/NSP/24	1500
TL947-24V	-	50	Q50MR16/CG/FL/24	1500

\*At rated voltage.



1300 S. Wolf Road • Des Plaines, IL 60018 • Phone (847) 827-9880 • Fax (847) 827-2925  
 220 Chrysler Drive • Brampton, Ontario • Canada L6S 6B6 • Phone (905) 792-7335 • Fax (905) 792-0064  
 Visit us at [www.junolightinggroup.com](http://www.junolightinggroup.com)

Printed in U.S.A. ©2009 Juno Lighting, LLC.