



# TRAC 12

Project: \_\_\_\_\_

Fixture Type: \_\_\_\_\_

Location: \_\_\_\_\_

Contact/Phone: \_\_\_\_\_

## Miniature Low Voltage Trac System **FACET<sup>®</sup>, MAMBA<sup>®</sup>, XANADU<sup>®</sup> GLACIS<sup>®</sup>, and CUBIX<sup>®</sup>** **TL150, TL155, TL170, TL180 and TL190**

### PRODUCT SPECIFICATIONS (for TL150, TL155, TL170, TL180, TL190)

**Lamp** 20-50W MR16 lamps.

**Construction** Die cast aluminum housing.

**Socket** Ceramic bi-pin.

**Accessory Holder** Integral to fixture design • Die cast aluminum construction • Precision bayonet mounting • Accommodates up to two 2" accessories simultaneously • Clear glass lens included with fixture.

**Aiming** 90° vertical aiming capability and 360° rotation.

**Labels** UL and C-UL Listed.

Product specifications subject to change without notice.

### PRODUCT DESCRIPTION

The sweeping arcs and arresting angles of the Facet deliver a unique asymmetrical aesthetic that is perfectly proportioned for the miniaturized Trac 12 system. With a socket housing that morphs into a stem completely horizontal in nature, its bold simplicity gives Facet an ultra-clean appearance. It shares all the attributes of the larger Trac-Master models including concealed wiring and extends the family "look" when different trac systems are mixed at the same location.

Facet for Trac 12 is designed for use with 50W MR16 low-voltage halogen lamps. An integral, bayonet-mount media cartridge is standard and accepts two light-control accessories. The Facet features high-quality, die-cast aluminum construction in attractive white, black silver and metallic finishes.

#### Low Voltage MR16 - Facet™

Catalog Number	Description	Finish	Lamp
<b>TL150WH</b>	<b>Facet™</b>	White	20-50W MR16, 12V or 24V
<b>TL150BL</b>	<b>Facet™</b>	Black	20-50W MR16, 12V or 24V
<b>TL150SL</b>	<b>Facet™</b>	Silver	20-50W MR16, 12V or 24V

#### ACCESSORIES (for TL150, TL170, TL180, TL190)

Cat. No.	Description	Cat. No.	Description	Cat. No.	Description
<b>T741-6</b>	Color Filters/Lenses	<b>T7477</b>	Prismatic Spread Lens	<b>T7478</b>	Linear Spread Lens
<b>T7401-18</b>	Dichroic Lenses	<b>T7420</b>	Diffuse Spread Lens	<b>T7421</b>	Uniformity Lens
<b>T7422</b>	UV Filter Lens	<b>T7459BL</b>	Hexcell Louver		

See specification sheet D1.2.2 for details.

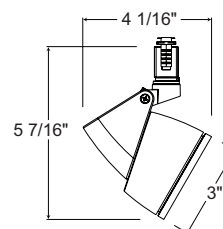

### PRODUCT DESCRIPTION

The strikingly original, daring aesthetic of Mamba has been perfectly proportioned for the miniaturized Trac 12 system. The Mamba combines gracefully curved and tapered elements to produce a unique and totally unexpected result. Its front-loading gimbal ring design makes lamp maintenance simple and convenient. It shares all the attributes of the larger Trac-Master models including concealed wiring and extends the family "look" when different trac systems are mixed at the same location.

The Mamba for Trac 12 is designed for use with 50W MR16CG low-voltage cover glass halogen lamps. The Mamba features high-quality, die-cast aluminum construction in attractive white, black and silver finishes.

#### Low Voltage MR16 - Mamba™

Catalog Number	Description	Finish	Lamp
<b>TL155WH</b>	<b>Mamba™</b>	White	20-50W MR16CG, 12V or 24V
<b>TL155BL</b>	<b>Mamba™</b>	Black	20-50W MR16CG, 12V or 24V
<b>TL155SL</b>	<b>Mamba™</b>	Silver	20-50W MR16CG, 12V or 24V

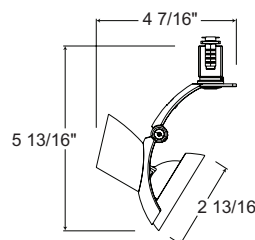

# TRAC 12

Miniature Low Voltage Trac System

**FACET<sup>®</sup>, MAMBA<sup>®</sup>, XANADU<sup>®</sup>  
GLACIS<sup>®</sup>, and CUBIX<sup>®</sup>**

**TL150, TL155, TL170, TL180 and TL190**

## PRODUCT DESCRIPTION

The stunning simplicity of this design, a pure shape devoid of any extraneous detail, makes Xanadu a classic beauty. Its yoke appears to have been carved directly from its conical form which has been perfectly proportioned for the miniaturized Trac 12 system. It shares all the attributes of the larger Trac-Master models including concealed wiring and streamlined trac adapter design, and extends the family "look" when different trac systems are mixed at the same location.

Xanadu for Trac 12 is designed for use with 50W MR16 low-voltage halogen lamps. An integral, bayonet-mount media cartridge is standard and accepts two light-control accessories. The Xanadu features high-quality, die-cast aluminum construction in attractive white, black and silver finishes.

### Low Voltage MR16 - Xanadu™

Catalog Number	Description	Finish	Lamp
<b>TL170WH</b>	<b>Xanadu™</b>	White	20-50W MR16, 12V or 24V
<b>TL170BL</b>	<b>Xanadu™</b>	Black	20-50W MR16, 12V or 24V
<b>TL170SL</b>	<b>Xanadu™</b>	Silver	20-50W MR16, 12V or 24V

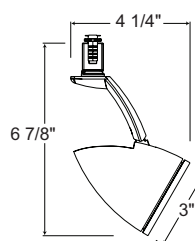

## PRODUCT DESCRIPTION

The flower-like Glacis reflects the beauty of the natural world. Its truncated conical element at the top cloaks the stem pivot when viewed from conventional viewing angles. Its natural form has been perfectly proportioned for the miniaturized Trac 12 system. It shares all the attributes of the larger Trac-Master models including concealed wiring and extends the family "look" when different trac systems are mixed at the same location.

Glacis for Trac 12 is designed for use with 50W MR16 low-voltage halogen lamps. An integral, bayonet-mount media cartridge is standard and accepts two light-control accessories. The Glacis features high-quality, die-cast aluminum construction in attractive white, black and silver finishes.

### Low Voltage MR16 - Glacis™

Catalog Number	Description	Finish	Lamp
<b>TL180WH</b>	<b>Glacis™</b>	White	20-50W MR16, 12V or 24V
<b>TL180BL</b>	<b>Glacis™</b>	Black	20-50W MR16, 12V or 24V
<b>TL180SL</b>	<b>Glacis™</b>	Silver	20-50W MR16, 12V or 24V

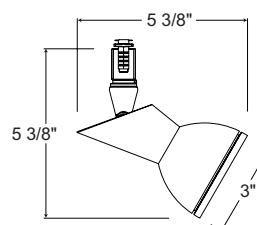

## PRODUCT DESCRIPTION

Cubix is a study of the visual relationship between two different geometric forms, the ring and the cube. In this most playful design, the stem becomes the central element, forming a pleasing visual extension of the cube form. The interplay of each of the elements has been perfectly proportioned for the miniaturized Trac 12 system. It shares all the attributes of the larger Trac-Master models including concealed wiring and extends the family "look" when different trac systems are mixed at the same location.

Cubix for Trac 12 is designed for use with 50W MR16 low-voltage halogen lamps. An integral, bayonet-mount media cartridge is standard and accepts two light-control accessories. The Cubix features high-quality, die-cast aluminum construction in attractive white, black and silver finishes.

### Low Voltage MR16 - Cubix™

Catalog Number	Description	Finish	Lamp
<b>TL190WH</b>	<b>Cubix™</b>	White	20-50W MR16, 12V or 24V
<b>TL190BL</b>	<b>Cubix™</b>	Black	20-50W MR16, 12V or 24V
<b>TL190SL</b>	<b>Cubix™</b>	Silver	20-50W MR16, 12V or 24V

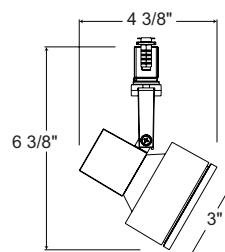

JUNO LIGHTING GROUP  
by Schneider Electric

1300 S. Wolf Road • Des Plaines, IL 60018 • Phone (847) 827-9880 • Fax (847) 827-2925

220 Chrysler Drive • Brampton, Ontario • Canada L6S 6B6 • Phone (905) 792-7335 • Fax (905) 792-0064

Visit us at [www.junolightinggroup.com](http://www.junolightinggroup.com)

Printed in U.S.A. ©2007 Juno Lighting, LLC.