



INSTALLATION INSTRUCTIONS

TRAC 12 AND TRAC 12/25

FOR JUNO TLR37 / TLR37-9-16 T-BAR ATTACHMENT CLIPS

IMPORTANT SAFETY INSTRUCTION - SAVE THESE INSTRUCTIONS

Read all of these installation instructions before installing the trac system.

Do not install this trac in damp or wet locations.

Do not install any fixture assembly closer than 6" from any curtain or similar combustible material.

Disconnect electrical power before adding to or changing the configuration of the trac.

Do not attempt to energize anything other than lighting fixtures on the trac. To reduce the risk of fire or electrical shock, do not attempt to connect power tools, extension cords, appliances and the like to the trac.

The TLR37 / TLR37-9-16 is only to be used to support Juno TL series and TLR series trac.

Save these instructions and refer to them when additions to or changes in the trac configuration are made.

TLR37 / TLR37-9-16 T-BAR ATTACHMENT CLIPS

Secures Juno TL Series and TLR Series trac to most standard 15/16" or 9/16" exposed tee ceiling suspension systems using either flush or drop ceiling tiles.

1. Determine where the trac will be installed, and mark grid ceiling according to the following:

*** TLR Series Trac:**

2' (TLR2) and 4' (TLR4) require (2) TLR37 or / (2) TLR37-9-16 T-Bar clips.

6' (TLR6) and 8' (TLR8) require (3) TLR37 or / (3) TLR37-9-16 T-Bar clips.

*** TL Series Trac:**

(1) TLR37 / TLR37-9-16 T-Bar clip is required every 1 foot of trac.

2. Refer to the diagrams on page 2 to determine what components will be used for the application. Set aside the components that will not be used. (Note: all components supplied in this kit will not be used, they can be discarded after installation is complete)
3. Put the chosen screw through the hole in the T-Bar grid clip (verify screw rotation is prevented by the forms in the T-Bar grid clip). Snap the T-bar grid clip and screw assembly over the marks on the tee from step 1, and rotate until the grid clip locks into place (see below).

TLR37 / TLR37-9-16 KIT CONTAINS:

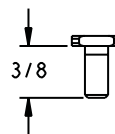

MOUNTING SCREW
#6-32 X 3/8" (YELLOW)

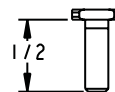

MOUNTING SCREW
#6-32 X 1/2" (SILVER)

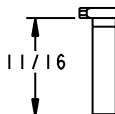

MOUNTING SCREW
#6-32 X 11/16" (BLACK)



#6-32 FLANGE NUT



#6-32 NYLON NUT

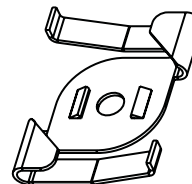

15/16" or 9/16"
T-BAR GRID CLIP

(continued on Page 2)

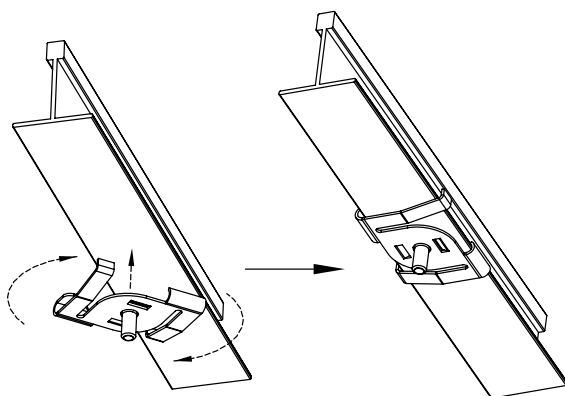

WARRANTY

Juno Lighting Group warrants that its products are free from defects in material and workmanship. Juno Lighting Group's obligation is expressly limited to repair or replacement, without charge, at Juno Lighting Group's factory after prior written return authorization has been granted. This warranty shall not apply to products which have been altered or repaired outside of Juno Lighting Group's factory. This warranty is in lieu of all other warranties, expressed or implied, and without limiting the generality of the foregoing phrase, excludes any implied warranty of merchantability. Also, there are no warranties which extend beyond the description of the product on the company's literature setting forth terms of sale.



JUNO LIGHTING GROUP



4. Regressed tile only:

Thread #6-32 flange nut about halfway onto the installed T-Bar grid clip / screw assembly (shown in figures 1 & 3). Line up holes in trac with screws, and push trac into place. Adjust the height of the trac by tightening or loosening the #6-32 flange nut until the trac sits flush with the bottom of the ceiling tile.

5. Slide the trac over the installed T-bar grid clip/screw assemblies until it comes in contact with the clips (flush tile) or #6-32 flange nuts (drop tile). Hold trac in place, while fastening #6-32 nylon nuts until snug on all T-Bar grid clip assemblies.

Figure 1 - TLR Trac with a Drop Tile

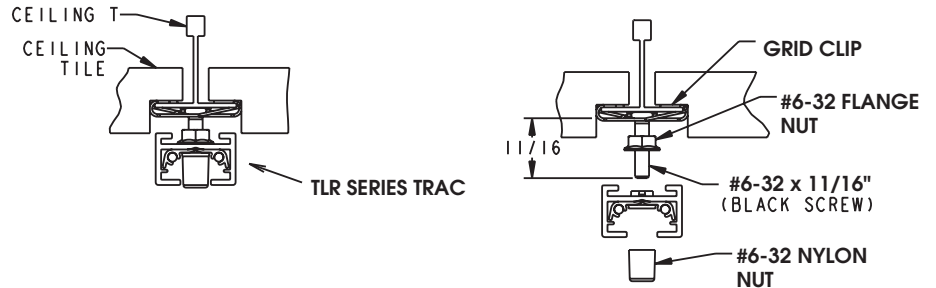

Figure 2 - TLR Trac with a Flush Tile

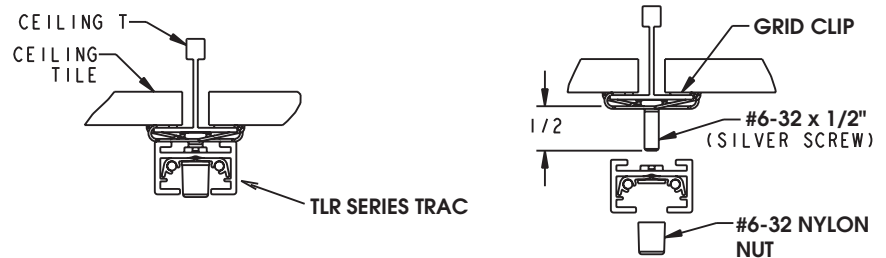

Figure 3 - TL Trac with a Drop Tile

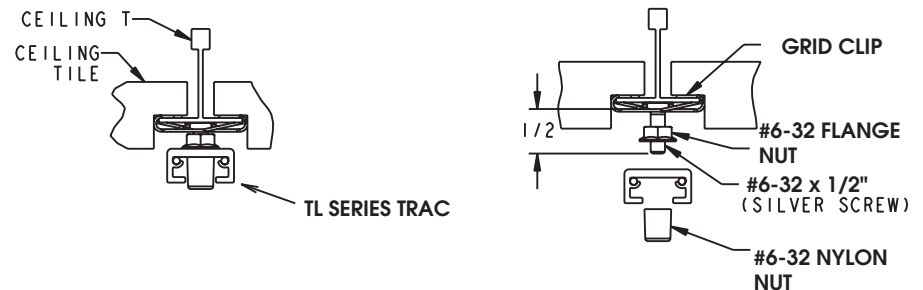

Figure 4 - TL Trac with a Flush Tile

