

## JUNO TYPE IC23R-LEDT24 REMODEL RECESSED HOUSING FOR SELF CONTAINED LED TRIMS

**WARNING:** For your safety, read and understand instructions completely before starting installation. Before wiring to power supply, turn off electricity at the fuse or circuit breaker box.

**NOTE:** Juno recessed fixtures are designed to meet the latest NEC requirements and are listed in full compliance with corresponding UL standards. Before attempting installation of any recessed lighting fixture, check your local electrical building code. This code sets the wiring and installation requirements for your locality and should be understood before starting your work.

**NOTE:** Use of Non-Juno trims voids Juno warranty.

### SAVE THESE INSTRUCTIONS

#### TYPE IC FOR INSULATED CEILINGS

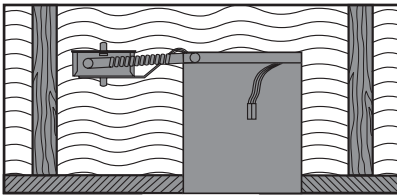

Figure 1

Juno Type IC fixtures are designed for direct contact with insulating materials which are approved for this application (Fig. 1).

Juno Air-Loc LED housings are supplied with an Air-Loc gasket kit for energy savings and to comply with Washington State and other energy codes.



#### INSTALLATION STEPS

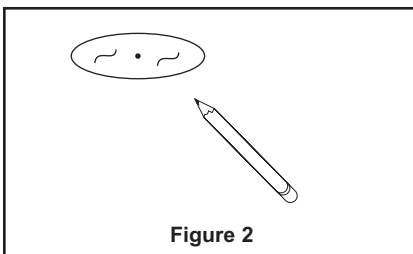

Figure 2

**Step 1.** Locate center of proposed opening on ceiling and use template to mark and accurately cut a 6-3/4" opening. (Fig. 2).

#### INSTALLATION STEPS (cont.)

**Step 2.** Locate Air-Loc gasket kit envelope supplied in fixture carton. Place foam gasket on the top surface of the metal ring of can (Fig 3).

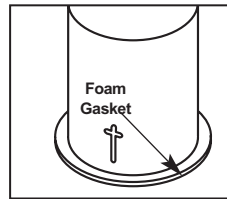

Figure 3

**Step 3.** Follow steps 1-4 under electrical connection.

**Step 4.** Press housing through ceiling opening so it is flush to ceiling (Fig. 4). Push retention clips outwards until each clip tab clicks into position.

*(Note: To remove housing from ceiling, push tab on clip upward to disengage).*

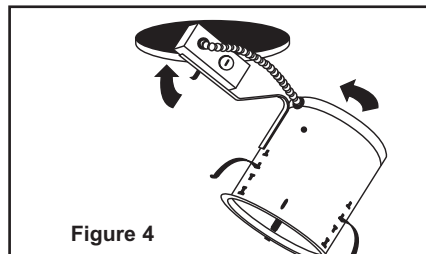

Figure 4

**Step 5.** Apply tape strips over each of the three retention clips and slots. Cover completely with the tape strips. Use the supplied strips, do not substitute with duct tape (Fig. 5).

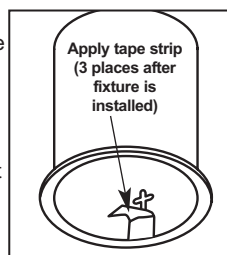

Figure 5

#### TRIM INSTALLATION

This housing is only intended to be used with trims marked on the housing. For instructions on how to install the trim, refer to the instructions supplied with the trim.

#### ELECTRICAL CONNECTION INSTRUCTIONS

**Step 1.** Provide electrical service according to your local electrical code to the wiring box located on the remodel housing. Supply wire insulation must be rated for at least 90°C.

**Step 2.** Remove wiring box cover. Remove the appropriate knock-out to connect flexible metal conduit or non-metallic cable to wiring box with proper connectors (by others) (Fig. 6).

**Step 3. J-Box with Quick Connectors:** Strip supply wire 3/8", insert each supply wire into appropriate junction box connector. Connect black fixture wire to hot, white fixture wire to neutral and green fixture wire to ground.

**Step 4.** Place all wiring and connections back in wiring box and replace cover.

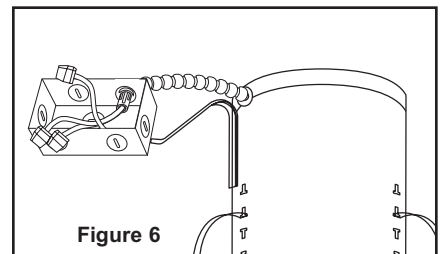

Figure 6

