

JUNO
JUNO[®] Remodel Housing
4" Template & Installation Instructions

1. Use disc as template to scribe circle on ceiling...
CUT HOLE ACCURATELY ALONG SCRIBE
LINE. HOLE DIAMETER SHOULD
NOT EXCEED 4-3/8".
2. Provide electrical service through ceiling
opening with flexible supply. Make
electrical connections inside junction
box through knockouts located on
opposite side of supply entrance.
3. Insert housing into ceiling hole
junction box first, pushing housing
flush to ceiling. Release and then lock
both spring clips into place. (Figure 1)
4. For TC44R fixture only: while
continuing to hold housing against
ceiling, tighten transformer
plate screw. (Figure 2)
5. Install trim.

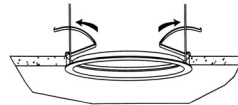

Figure 1

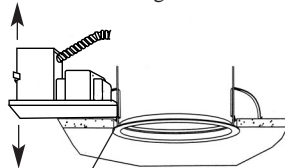

Figure 2

Screw Inside (TC44R)

MADE IN AMERICA
JUNO[®] lighting inc.
P1987C

©Copyright Juno Lighting 2001 Rev. 1 10/04