

ICPL418E 4" 18W Triple Vertical CFL Housing

IC Rated

ENERGY EFFICIENT

Juno



Features

- 4" Housing
- Energy Star® qualified, California Title 24 compliant
- 120V HPF rapid start electronic FCC Class B ballast with end-of-life lamp protection
- Ballast is mounted to the inside of the housing on a removable J-box cover for ease of maintenance
- Fixed mounted socket attaches to top of housing
- Vertically adjustable to accommodate up to a 1" ceiling thickness
- Real Nail® 3 bar hangers: telescoping system with pre-installed removable nail for easy repositioning of housing in joist construction • Integral T-bar mounting feature for secure installation in suspended ceilings • Patented breakaway bars for tight joist spacing • Bar hangers may be re-positioned 90° • Curved foot facilitates alignment with joist bottom • Quick-Loc slot and oversized set screw lock fixture in position
- Fully assembled housing
- Pre-wired junction box with (6) 1/2" and (1) 3/4" knockouts with pryout slots, (4) non-metallic sheathed cable connectors, and ground wire
- UL and cUL Listed for through-branch wiring, maximum (6) #12 AWG conductors (3 in, 3 out)
- Shadow-free, knife-edge trim design blends smoothly into the ceiling and allows architectural continuity with Aculux® trims
- 2 year warranty
- One 18W triple tube (4-pin) CFL lamp with trim selection on page 45D-45E



Description

IC rated Air-Loc, energy efficient vertical CFL housing with double wall construction • Can be completely covered with insulation • Air-Loc installation stops infiltration and exfiltration of air, reducing heating and cooling costs

Listings

UL and cUL Listed for through-branch wiring, damp and wet locations • Washington State, IECC and MEC energy codes as tested per ASTM-E283

- Energy Star® qualified, California Title 24 compliant
- Wet location listed when used with 11, 12, 4101 and 4102 trims

Down-Lites

Ordering Information

Catalog Number: **ICPL418E** - 120V HPF ballast

Dimensions

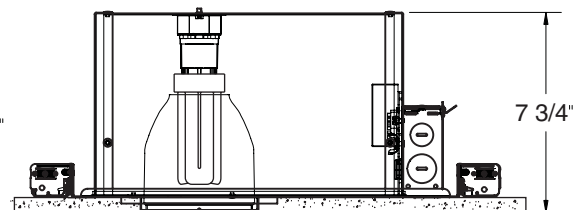
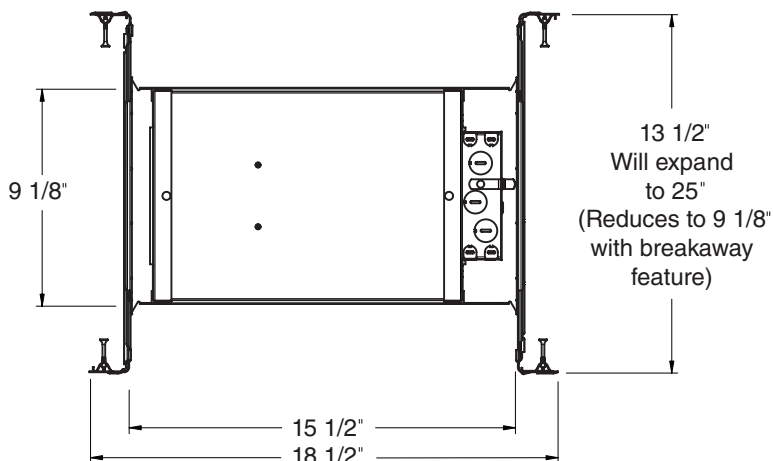

4 1/2" Ceiling Cutout



JUNO LIGHTING GROUP
by Schneider Electric